



AFG[®] Angled Fore Grip



WARNING

BEFORE STARTING! MAKE SURE THE WEAPON IS UNLOADED, THE CHAMBER IS EMPTY & THE SAFETY IS ENGAGED.



READ ALL INSTRUCTIONS BEFORE PROCEEDING TO AVOID LOSING ANY SMALL COMPONENTS.



AFG INSTALLATION INSTRUCTIONS

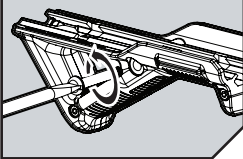

STEP 1: REMOVE SLOTTED SCREW

Using a *flat-head screwdriver*, loosen and completely remove the *10-24 Slotted Screw*. If you want to change the *Finger Shelf*, see "Step A" before continuing.

NOTE: After removing the *10-24 Screw*, the *10-24 Hex Nut* on the opposite side will be loose. Take care not to lose the *Nut*.

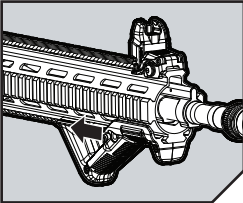

STEP 2: POSITION AFG ON RAIL

After the *10-24 Slotted Screw* is removed, slide the *AFG* onto the rail, making sure there is a clear path for the *Slotted Screw* in Step 3. If the *AFG* is too snug to slide easily over the rail, use a *7/64" hex key* to loosen the two (2) *6-32 x 5/8" Socket Head Cap Screws*.

▲ WARNING: Install *AFG* so it is entirely mounted on the handguard with the front of the fore-grip at least 3" rearward of the muzzle. Failure to do so may result in serious injury, burns, or loss of digits.

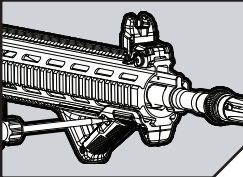

STEP 3: INSTALL AND TIGHTEN SLOTTED SCREW

When desired position is reached, reinstall the *10-24 Slotted Screw* and tighten with a *flat-head screwdriver*. Retighten the two (2) *Socket Head Cap Screws* to 8-10 inch-lbs with a *7/64" hex key* if loosened in Step 2.

NOTE: Take care to not over tighten screws. Over tightening may result in damage to the *AFG*.

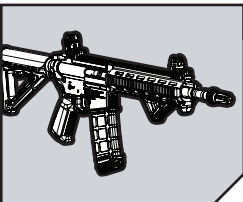

STEP 4: VERIFY INSTALLATION

Perform final inspection including a function check per **US Army TM 9-1005-319-23&P (3-18) Unit and Direct Support Maintenance Manual** to verify correct installation.

If you experience any issues during installation, please go online to www.magpul.com for further information.

Always test fire your weapon before using it in an operational environment.

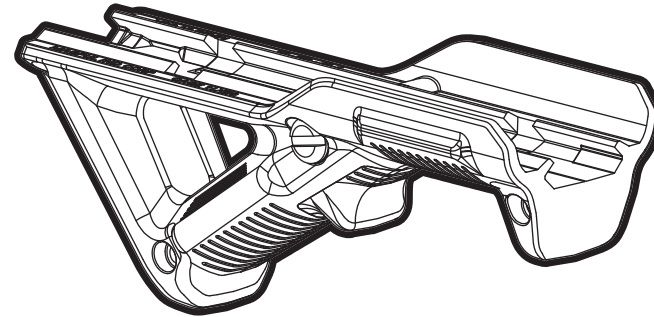

AFG FINGER SHELF INSERT INSTALL INSTRUCTIONS

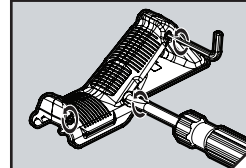

STEP A: REMOVE ALL THREE (3) SCREWS

NOTE: Remove *AFG* from weapon before proceeding. Using a *flat-head screwdriver* remove the *10-24 Slotted Screw*. Once the *Slotted Screw* is removed, use a *7/64" hex key* to remove the remaining two (2) *6-32 x 5/8" Socket Head Cap Screws*.

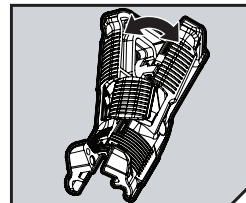

STEP B: SEPARATE TWO HALVES

Holding the *AFG* upside-down, "fold" the two halves outward to disengage locking mechanism, then pull apart. Use care not to lose the *Insert*.

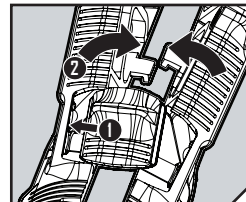

STEP C: POSITION INSERT

There are two (2) *Inserts* included with the *AFG*. The *Finger Shelf Insert* and the *Straight Insert*. To install, place the *Insert* into the appropriate groove. Each *Insert* may be installed in either direction to optimize the fore-grip for user preference. After installing the desired *Insert*, hook the *Locking Tabs* into the appropriate slots and "fold" inward. Hold and continue to Step D.

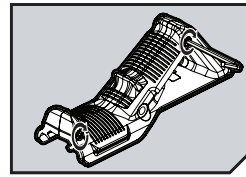

STEP D: RETIGHTEN SOCKET HEAD SCREWS

While holding the 2 halves together, insert the two (2) *6-32 x 5/8" Socket Head Cap Screws* and tighten using a *7/64" hex key* to 8-10 inch-lbs .

NOTE: Take care to not over tighten the *Socket Head Cap Screws*. Over tightening may result in damage to the *AFG*.

After this is complete, proceed to Step 2 on the Install Instructions.