

LaserMax

MICRO II

RAIL MOUNTED LASERS

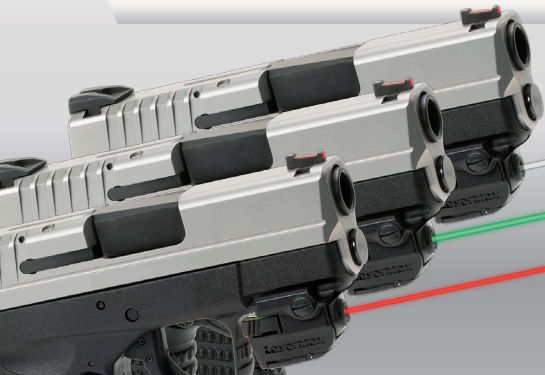

Operator's Manual

PARTS IDENTIFICATION

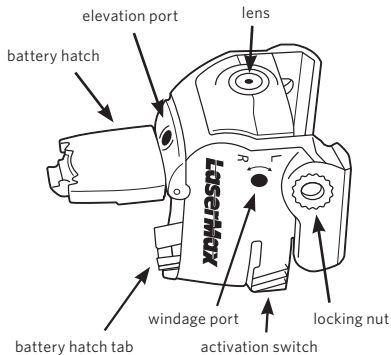

REPLACEMENT PARTS

LMS-AT50

adjustment tool

LMS-13N

replacement battery

LMS-2x13N

2-pack replacement batteries

LMS-MICRO-CS

clamping screw

IMPORTANT: PRIOR TO INSTALLATION, BATTERY CHANGE, CLEANING OR MAINTENANCE, FOLLOW THE FIREARM OPERATOR'S MANUAL TO ENSURE THAT THE FIREARM IS UNLOADED.

INSTALLATION

1. To remove laser from package use a flat head screwdriver (not supplied) to unscrew *clamping screw* from right side of *laser housing*.
2. Position Micro II on firearm rail.
3. Guide Micro II into position, aligning clamping screw hole with preferred notch on rail (see figure 1).
4. Insert *clamping screw* into right side of *laser housing* (see figure 2). When fully inserted, *clamping screw* will engage *locking nut*.
5. Tighten *clamping screw* with a flat head screwdriver (not supplied).

Note: Variations in depth of handgun rail notches may require that *clamping screw* be pressed from locking nut end to remove.

OPERATING INSTRUCTIONS

1. To turn the laser on, press and release the *activation switch* from either side (see figure 3). Press and release again to turn the laser off.
2. To switch the laser aiming point from pulse to steady, turn the laser on, then press and hold the *activation switch* for 3 seconds. Press and hold the *activation switch* for 3 seconds again to return to the previous mode.
3. To save power and prevent inadvertent battery drain, Micro II will shut off automatically after a ten minute period of inactivity. Cycle the *activation switch* to turn the laser back on.

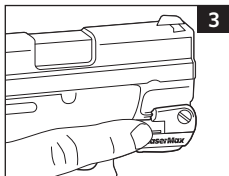
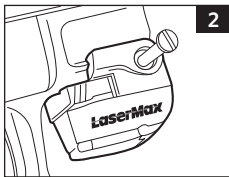
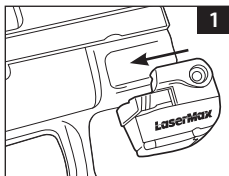

ALIGNING THE LASER

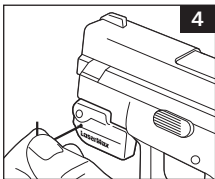

1. Alignment adjustments should be made at a minimum of 10 yards distance from the target. To begin, insert the *adjustment tool* into one of the two *alignment ports* (figures 4 & 5) and slowly rotate the tool while comparing the laser position on target to the fixed sights. **Important:** Do not turn *alignment screws* more than one full turn in either direction from their factory position. This may cause damage to the laser and void the warranty. A one quarter turn will result in a movement of about 7 inches at 10 yards.

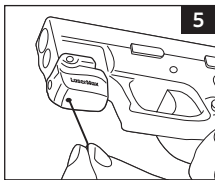

2. Windage adjustment: with the muzzle pointing forward and *adjustment tool* inserted into the *alignment port* on the right side, a clockwise turn will shift the laser aiming point to the left and a counterclockwise turn will shift the laser beam to the right.

3. Elevation adjustment: with the muzzle pointing forward and *adjustment tool* inserted into the *alignment port* on the bottom, a clockwise turn will shift the laser beam down and a counterclockwise turn will shift the laser beam up.

Note: a slight shift in alignment may be observed after firing Micro II for the first time. Recheck alignment after break in and readjust as necessary.

BATTERY REPLACEMENT

Micro II can remain on the firearm or be removed to change the battery.

1. Keep firearm pointed in a safe direction.
2. Press and hold *battery hatch* near tab (see figure 6).

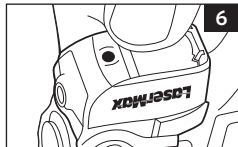

While maintaining pressure on *battery hatch* with one hand, use the other hand to press *battery hatch tab* away from *battery hatch* (see figure 7).

3. Release *battery hatch* to expose battery chamber.
4. Replace expended battery with fresh 1/3N battery. The flat, inscribed side of battery should face outward (see figure 8).
5. Secure *battery hatch* by applying gentle pressure until it snaps closed.

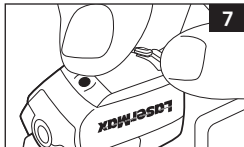

CLEANING

After repeated fire, the *lens* may become clouded with gunpowder residue. For best results, it is recommended that this area be cleaned, along with the firearm, after each use. To clean the *lens*, follow these steps:

1. Keep firearm pointed in a safe direction.
2. Confirm laser is off.
3. Dampen the end of a cotton swab with isopropyl alcohol.
4. Apply dampened swab to *lens* and polish in a small circular pattern. Be sure to clean around edges of *lens*.

WARNING

Care should be taken when applying oil or lubricant to clean the firearm. Getting oil or lubricant on the laser components may cause damage and void the factory warranty. The Micro II should not be submerged or flushed with cleaning solvents.



IF YOU EXPERIENCE AN ISSUE
WITH YOUR MICRO II LASER,
PLEASE DO NOT RETURN IT
TO THE STORE.

Contact LaserMax Customer Service: ☎ 800-527-3703

MICRO-2-R

Red Laser

CLASS 3R VISIBLE LASER

Output Power: <5mW

Wavelength: 650nm



MICRO-2-G

Green Laser

CLASS 3R VISIBLE LASER

Output Power: <5mW

Wavelength: 510-535nm



MICRO-2-IR

Infrared Laser

CLASS 1 LASER

Output Power: <0.7mW

Wavelength: 850nm

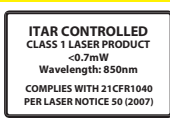

REMINDER

Aiming a laser beam at moving vehicles including boats, aircraft, trains, and construction equipment may be illegal. Check current applicable laws and follow them accordingly.

DANGER

Laser radiation is emitted from the front aperture of the laser when the switch is activated.

WARNING

Avoid direct eye exposure to beam. Do not point laser at anything you do not wish to destroy.

LASERMAX LIMITED WARRANTY

LaserMax is pleased to offer a five (5) year limited warranty for this product.

To take advantage of this coverage, the product must be registered no later than 90 days after purchase.

This product may be registered by completing a Registration Form which may be found at www.lasermax.com/support or by contacting the LaserMax Customer Service Department at 1-800-527-3703. The LaserMax Limited Warranty extends specific legal rights to the registrant. Other rights, which vary from state to state, may also apply. This product is warranted to be free from defects in material and workmanship at the time of purchase. This limited warranty does not cover expendable parts (ex: batteries), that have definite and predictable life expectancies. This warranty does not cover products that LaserMax determines have been exposed to abnormal use in any way. Examples of abnormal use include, but are not limited to, damage from mishandling, misuse or abuse, damage from exposure to abnormal conditions, damage from improper care and maintenance, or installation of the product in or on any firearm model the product is not specifically advertised to be used with. Warranty coverage begins on the date of purchase and ends five (5) years after date of purchase. This limited warranty extends only to the original registrant and is non-transferable. To file a warranty claim, a warranty repair request must be submitted, and a Return Merchandise Authorization (RMA) number issued by the LaserMax Warranty Department, within five (5) years from date of purchase. Following submission of a warranty claim,

LaserMax reserves the right to inspect the product to determine its eligibility for warranty coverage. If deemed eligible, LaserMax will repair or replace the part(s)/product that LaserMax, at its sole discretion, determines to be defective during the warranty period. If deemed ineligible, LaserMax will return the part(s)/product with an explanation of why coverage is not available. LaserMax reserves the right to replace defective part(s)/product with an equivalent substitute product at its sole discretion. Any and all implied warranties, including the implied warranties of merchantability, fitness for a particular purpose, and non-infringement, also begin on the date of purchase and end five (5) years after date of purchase. This limitation does not apply to residents of states that disallow limitations on the length of implied warranties. The preceding process is both the exclusive remedy and LaserMax's exclusive liability for any warranty claim. LaserMax will not, under any circumstances, be liable for any incidental, indirect, consequential, punitive or exemplary damages (even if LaserMax has been notified of the possibility of such damages) resulting from or related to a product, including, without limitation, any loss of profit, opportunity, or damages in excess of the purchase price of the warranted product. This limitation does not apply to residents of states that disallow limitations on incidental or consequential damages.

LaserMax, Inc,
3495 Winton Place, Rochester, NY 14623

☎ 800-527-3703 • www.lasermax.com

For patent information, please visit:
www.lasermax.com/patents

01785-0-60 10/15, RevB