



RVG[®] RAIL VERTICAL GRIP



WARNING

BEFORE STARTING! MAKE SURE THE WEAPON IS UNLOADED,
THE CHAMBER IS EMPTY & THE SAFETY IS ENGAGED.



READ ALL INSTRUCTIONS BEFORE PROCEEDING
TO AVOID LOSING ANY SMALL COMPONENTS.



RVG INCLUDED PARTS

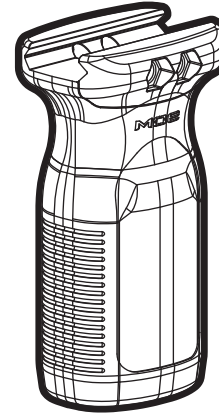
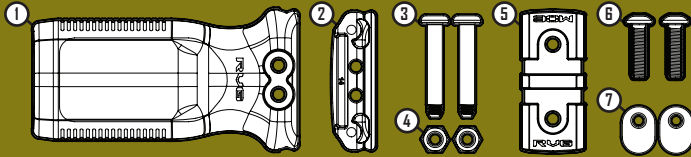

WARNING: Use of vertical grips with insufficient or improperly installed retaining hardware may permit unintended separation of parts allowing non-firing hand to extend in front of muzzle on shorter firearms, resulting in serious injury or death. All vertical grip products should be securely attached and checked regularly for proper retention.

RVG INSTALLATION INSTRUCTIONS

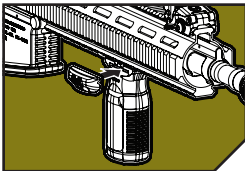

STEP 1: ALIGN RVG

Using a *flat-head screwdriver* remove the *10-24 Slotted Shoulder Screws* (3). When removed, slide the RVG to desired position on the rail, making sure to align a clear path for the *Slotted Shoulder Screws* in Step 2. Align the *Rail Clamp* (2) on the opposite side.

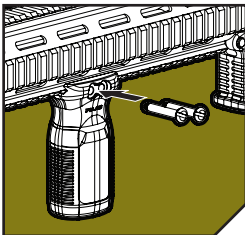

STEP 2: INSERT AND TIGHTEN SCREWS

When desired position is reached, reinstall the *10-24 Slotted Shoulder Screw* and tighten with a *flat-head screwdriver*.

Note: Take care to not over tighten screws. Over tightening may result in damage to the RVG.

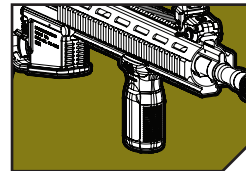

STEP 4: VERIFY INSTALL

Perform final inspection including function check per **US Army TM 9-1005-319-23&P Unit and Direct Support Maintenance Manual (3-97)** to verify proper weapon function.

Always test fire your weapon before using it in an operational environment.

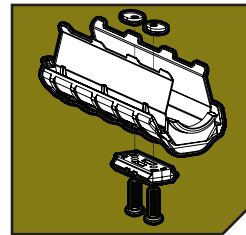

OPTIONAL RAIL INSTALL

The optional *Rail Section* (5) is intended for use on *MOE* and *Bushmaster® ACR™ hand guards*, and may be compatible with other non-railed fore-ends.

To install, insert the two *10-24 Button Head Screws* (6) through the two holes in the *Rail Section*. Align with the appropriate vent holes on the hand guard, and thread into the *Offset Weld Nuts* (7). Hand tighten using a *1/8" hex wrench*.

Take care not to overtighten screws. Overtightening may cause damage to hand guard or RVG Rail Section.