



KNIGHT[®]
AMERICA'S MUZZLELOADER

Knight Rifles
Owner's Manual

WARNING!

Muzzleloaders are dangerous if not handled properly. It is important that you understand all of the information in this manual prior to using your Knight Rifle. Failure to do so may result in harm to your rifle, yourself and/or bystanders.

**READ THIS MANUAL NO MATTER HOW
EXPERIENCED A SHOOTER YOU ARE.**

DO NOT USE SMOKELESS GUNPOWDER!



Knight® Rifles Instructions and Safety Manual

Introduction.....	5	Peregrine™, DISC Extreme™, Long Range Hunter™, Mountaineer™.....	34
Safety Definition.....	5	Action and Safety Systems.....	34
Unpacking Your New Knight Muzzleloader.....	6	Disassembly and Assembly.....	35
Getting to Know Your New Knight Muzzleloader.....	6	209 Conversion Non-Full Plastic Jacket Breech Kit.....	37
Basic Safety Rules.....	7	Bighorn™.....	38
Basic Firearm and Muzzleloader Safety Rules.....	7	TK2000 Shotgun™.....	40
Special Muzzleloader Safety Rules.....	8	Littlehorn™.....	42
Care and Cleaning.....	9	Bighorn™, Wolverine™, Littlehorn™, TK2000™ Shotgun.....	44
Loading and Firing.....	11	Action and Safety System.....	44
Preparing to Load.....	11	Disassembly and Assembly.....	45
Sizing Bullets PEREGRINE.....	12	Knight Parts™.....	46
Loading Instructions for Rifles.....	14	Knight Warranty™.....	49
Priming the Full Plastic Jacket.....	14	Service Policy.....	49
Loading Instructions for the TK2000 Muzzleloading Shotgun.....	15	Instructions for Return.....	49
Firing.....	16	Warranty Limitations.....	50
Reloading.....	16	Limited Lifetime Warranty Extended Service Policy (Peregrine™, Mountaineer™, DISC Extreme™, Bighorn™, Littlehorn™, Wolverine™, TK2000™, Long Range Hunter™).....	51
Recommended Loads.....	17	Notes.....	50
Recommended Loads for the TK2000™ Shotgun.....	17		
Recommended Loads for Rifles.....	18		
Ballistics Chart.....	19		
Adjustments.....	21		
Trigger Adjustment.....	21		
Sighting In.....	21		
Breech Plugs.....	22		
Peregrine™.....	24		
Mountaineer™.....	26		
Ultra-Lite™.....	28		
DISC Extreme™.....	30		
Long Range Hunter™.....	32		

Dear Knight Rifle® owner,

Congratulations! As a member of the Knight® family, you now own the tradition of the past with the technology of the future. Knight® Rifles has helped muzzleloading mature from a nostalgic interest into a true hunting sport. Every year, numerous world records are taken across the globe. With your Knight® muzzleloader, you can expect unmatched accuracy on the range and in the field.

Hunting with a Knight® muzzleloader is a unique compromise between the challenge of using a bow and the devastating knockdown power of a center-fire rifle. Offering the best of both worlds, your Knight® muzzleloader will make your hunting experience the best it can be.

We know that you will derive many hours of shooting and hunting pleasure from your new Knight® muzzleloader. We look forward to your letters, pictures, comments and questions that you may have on how we can enhance your muzzleloading experience.

Your Partners in the Field
The Knight Rifles Team

Safety Definition

In this manual, keep the following definition in mind to help you understand and use the safety information that is present throughout the manual:

WARNING!

Indicates information regarding a hazardous situation, which, if not avoided, may result in death or serious injury.

Unpacking Your New Knight® Muzzleloader

Knight® Muzzleloaders are delivered factory-packaged, preserved with a coating of protective oil, and placed in a corrosion resistant bag for shipping. Before loading and firing, make certain that all protective oil has been cleaned from the bore, breech plug, nipple, and exposed firing mechanisms. Your muzzleloader has been tested, inspected, and properly packaged at the factory. Knight® Rifles cannot control product handling after shipment. Please examine the muzzleloader carefully at the time of purchase to ensure that it is unloaded and undamaged. Your dealer will be pleased to assist you in making this examination and will answer any additional questions you may have.

Getting to Know Your New Knight® Muzzleloader

Before loading and firing your new Knight® muzzleloader, it is important that you get to know your new muzzleloader. Read this manual to learn about muzzleloading in general and the features, limitations, and capabilities of your particular muzzleloader. The first part of the manual applies to all models. The second part contains a section with specific information about each model.

It is important that you select appropriate priming devices, amount and kind of propellant, and projectiles for your model.

All Knight® muzzleloaders are equipped to use 209 shotshell primers as priming devices. Some are also able to utilize percussion caps. Most Knight® muzzleloaders feature the **Full Plastic Jacket Ignition System Concept™**, which allows you to utilize a 209 shotshell primer as the ignition source, completely weatherproofing the receiver area. The hotter shotshell primer ignition puts more fire into the breech end ensuring spontaneous ignition, faster lock time, consistent velocity, and a hotter burn of the powder charge for a cleaner breech area. This contributes to better accuracy. This does not take the place of swabbing the bore and breech plug face to assure a clean spark free barrel.

Knight® muzzleloaders use Black Powder FFg, and industry approved black powder substitutes. Some models can also use pelletized powder (powder formed into single pellets of approximately one half inch in length). **WARNING! Never use smokeless powder. It can cause your muzzleloader to explode. There are many black powder substitutes available. Be aware of and follow all instructions and warnings that apply to the propellant you choose as their recommendations including swabbing your bore do vary from manufacturer to manufacturer.**

Knight® muzzleloaders use a variety of projectiles, depending on the model.

WARNING! Knight Rifles® does not recommend the use of non saboted lead projectiles (such as patched round balls). These bullets can easily be moved from the powder charge. This will result in an obstructed barrel, and upon firing, could cause an explosion. If you choose or legally have to shoot non saboted lead projectiles, always check that your projectile is properly seated immediately before priming and firing.

WARNING! Muzzleloaders can seriously or fatally injure shooters and bystanders if not handled properly. Before you use your muzzleloader read this manual, particularly these Basic Safety Rules.

Supervise and teach muzzleloading safety to all members of your family. Never lend your muzzleloader to anyone who is not thoroughly familiar with its operation and the basic rules of muzzleloading safety. Be certain that anyone using your muzzleloader has read and understands this Instruction and Safety Manual. Always be defensive and on guard against gun handling around you and others.

Knight® muzzleloaders are designed to function properly in their original condition. Do not jeopardize your safety or the safety of others by modifying your muzzleloader.

Basic Muzzleloader Safety Rules

Many of the safety rules for muzzleloaders are the same as those for firearms. The best way to learn about firearm safety is a course taught by an NRA-approved or other qualified instructor. Check with your local gun clubs and firearm dealers. Here are a few of the most important general firearm safety rules:

Handling, Loading, and Unloading

- Always handle all firearms and muzzleloaders as if they were loaded. Keep the muzzle pointed in a safe direction. Never point your firearm or muzzleloader at anything you do not intend to shoot.
- Keep your safeties on *safe* while handling and loading.
- Unload when not in use and never store a loaded firearm or muzzleloader. Remember to unload before cleaning too.
- Never intentionally drop a firearm or muzzleloader when loaded.
- Never climb with your firearm or muzzleloader. Use a rope or strap to lift and lower your unloaded firearm or unprimed muzzleloader.

Avoid Injuries When Firing

- Always wear adequate eye and ear protection when shooting.
- Never fire a firearm or muzzleloader with worn, broken, or modified parts.
- Never drink alcoholic beverages or take any type of drugs before or during shooting.
- Be sure of your backstop, what lies beyond, and the safety of bystanders, before you shoot.

Follow Hunting Safety Rules

- Never hunt from a tree stand without a full body harness.
- Be aware of and follow the local hunting safety regulations.

WARNING! Even if you are proficient with other firearms, rifles, or other similar muzzleloaders, be sure to read the special muzzleloader safety rules below, as there may be features or functions of this product that you are not familiar with.

Special Muzzleloader Safety

Avoid Accidental Firing

A muzzleloader can seriously or fatally injure you or bystanders due to accidental firing when it is primed with a priming device (either a 209 shotgun primer or percussion cap) but not loaded, when it is loaded with a powder and a projectile but not primed, or when it is both primed and loaded.

- Know your safety systems. Some models have two safety systems, while others have only one. Use all of the safety systems on your muzzleloader whenever you are not ready to fire.
- Keep your muzzle pointed in a safe direction if your muzzleloader fails to fire. It could fire after a delay.
- Remove the priming device before crossing a fence, climbing a tree, jumping a ditch, or negotiating other obstacles. A primed muzzleloader can fire if dropped or impacted.
- Never rest the firing pin or striker against the priming device. An impact in this condition could cause the muzzleloader to fire, even with safeties engaged.
- **Always swab the barrel with a moistened patch between shots to remove potential hot residue that could ignite powder and to improve shot to shot accuracy.**

Load Properly

- Never use smokeless powder in Knight® muzzleloaders.
- Never exceed the recommended maximum powder charge for your Knight® muzzleloader. Please see individual models for recommended load limits of Black Powder FFg, and industry approved black powder substitutes, by volume or its equivalent for Knight Rifles. See your specific rifle's page for maximum powder charges.
- Make sure your muzzleloader is unloaded before attempting to load.
- **Never install a percussion cap or primer on the nipple before loading.**
- Be sure that the barrel and nipple flash channel are clear of any obstruction.
- Be sure the bullet is firmly seated on the powder charge.

Always clean and lubricate your muzzleloader after each day's shooting. A muzzleloader must be free of rust, dirt, grease, and powder residue to function safely and reliably. Careful maintenance, which includes inspection of all components to determine if they are in proper working order, is absolutely essential. Muzzleloaders use Black Powder FFg and industry approved black powder substitutes that are highly corrosive, and when fired will deposit corrosive particles and residue in the bore, breech plug, hammer, receiver, trigger and other parts of the rifle.

Rifle grade stainless steel is more rust and corrosion resistant than blued steel, but it is not rust proof. To insure your stainless steel rifle remains in superior condition, clean, oil, and store it in the same manner as a blued steel rifle.

Basic Cleaning Equipment Needed:

- Ramrod with Bore Brush (Fiber or Brass)
- Cleaning Jag
- Cleaning Patches
- Powder Solvent
- Breech Plug Grease
- Water Displacing Oil
- Small Lint-Free Cloths
- Pipe Cleaners
- Toothbrush

WARNING! Before cleaning, be certain that the rifle is unloaded and that no primer is in the receiver. Cleaning a loaded or primed rifle may result in accidental discharge.

Instructions for Cleaning

- 1.) Disassemble your rifle as described in your specific model's section of this manual. Take care to put all small parts and similar components in a tray.
- 2.) Clean rifle with soap and water or an approved solvent. Do not use soaps with chlorides, lye, or bleach in them; the chemicals may remove blueing on your barrel.
- 3.) Clean your rifle from the breech end. Place your breech plug and hammer in hot soapy water or **Knight® Solvent™**. Do not use water to clean triggers for DISC Extreme™, Long Range Hunter™, Peregrine™, Mountaineer™, Bighorn™, Littlehorn™, and TK2000™. Only a solvent should be used to clean these Knight Rifles. Clean with appropriate material and lubricate sear. Don't allow barreled action and other rifle parts to soak in soapy water or solvents for extended periods.
- 4.) Use a **Knight® Ultimate Range Rod™** or a ramrod with a **Knight® Bullet Starter™** handle and an attached cleaning jag. With the muzzle still in the hot soapy water, place a patch over the rear of the receiver and push into the barrel. Scrub the bore vigorously to completely remove all foreign matter, powder residue, and fouling. Repeat this as many times as necessary to get a clean bore.
- 5.) Thoroughly scrub and clean the breech plug threads in the receiver. A toothbrush, bottle brush, or bullet starter with adapter and 20 gauge shotgun brush work well for this task.
- 6.) Using a toothbrush or pipe cleaner, thoroughly clean the receiver, hammer, breech plug, trigger and other components of all residues, fouling, etc.
- 7.) Thoroughly dry all metal surfaces and generously lubricate your rifle inside and out using **Knight® Oil™** with rust inhibitor.
- 8.) Reassemble your muzzleloader according to the instructions in your model's section of this manual.

Preparing to Load

WARNING! To reduce the risk of accidental discharge, perform the following checks.

- 1.) Confirm that all safeties are functioning properly and are in the **safe** position.
- 2.) Check that there is no primer, either live or spent, installed.
- 3.) Place the rifle butt on the ground, remove the ramrod, and place it in the bore. If the ramrod tip is near flush with the muzzle, the rifle is unloaded and the bore free from obstruction. Remove the ramrod from the barrel.

After your rifle has been cleaned and oiled, you must clear the breech plug firing hole of any oil and debris prior to use. This is done as follows:

- 1.) Install a primer. Point the muzzle at the ground and hold 4 to 6 inches from dirt or grass. Place safeties in the **fire** position and fire a primer. Observe the dirt or grass move when the primer is fired. This will indicate that the breech plug flash channel is clear. If the flash channel is not clear, remove the debris before proceeding. Repeat this step one more time. Always remove the spent primer after each ignition.
- 2.) Return the safeties to the **safe** position.
- 3.) Leave the action open during swabbing and loading. (Except break open actions which should remain closed.)
- 4.) Place the butt of the rifle on the ground. Screw the cleaning jag into the end of the ramrod. Moisten a cleaning patch with **Knight® Easy Clean™** and wring any excess liquid out with your fingers. Using short, quick strokes of you ramrod and cleaning jag, swab the entire bore several passes with the wet patch until it contacts the breech plug. Place a dry patch on the jag and swab the entire barrel again, making sure to contact the breech plug.

This process will help prevent misfires and hangfires. It will also improve first shot accuracy by removing grease and oils left in the bore during cleaning

Sizing Instructions for Bullets

WARNING! To reduce the risk of a stuck bullet in the barrel, be sure to size each bullet with the sizer to fit the bore before loading the Peregrine.

Bullets slightly differ in size from brand to brand. Sizing the bullet to fit your bore is a process of trial and error. You may need to feed the bullet through the sizing die multiple times to find the right size for your gun's bore.

***NOTE:** Be sure to first grease the threads and tapered sleeve of the die. Use sizing die wax to lubricate the bullet and hole of the die.

- 1.) Screw the sizing die onto the press and hand tighten until snug.
- 2.) Place your 10mm/.40 caliber bullet down the barrel of the sizing die with the bullet pointing out.
- 3.) Bring the lever down and close the press allowing the push rod to force the bullet through the front end of the sizing die (push firmly to ensure the bullet comes all the way through the die).
- 4.) Check to see if your bullet now fits snugly down the bore of your Peregrine barrel. If it fits well, your bullet is properly sized.

***NOTE:** The 10mm/.40Cal bullet should fit snugly down the bore of the barrel. You should not have to force the bullet. A good fit will slide down the bore with a small amount of pressure.

- 5.) If the bullet is still doesn't fit, tighten the sizing die with the included sizing wrench approximately 1/6 of a rotation. Continue to repeat steps 1-4 until you obtain the desired bullet size for your gun.

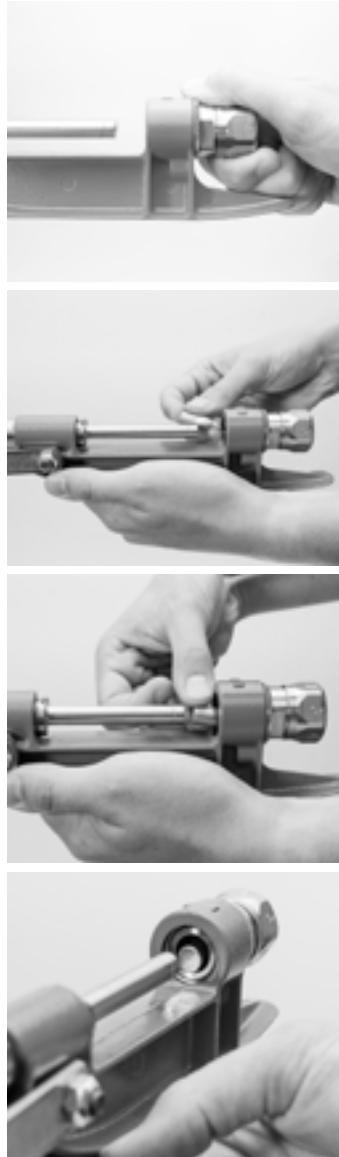

***NOTE:** It is possible to tighten the sizing die too much so that the sizing bushing is too compressed making your bullets too small.

If the die is compressed too much, loosen the nut of the die one to two full rotations (or more, depending on how compressed bushing is), and press the included brass slug through the sizing die, resetting the bushing to its original size. Then repeat steps 1-4 to properly size your bullets.

If there is still resistance when sliding the bullet through, your bushing is still compressed too much. Loosen the die further and press the slug through the die again.



Loading Instructions for Rifles

- 1.) Make sure that all safety systems are engaged before loading and that there is no primer, live or spent, installed.
- 2.) Place the butt of the rifle on the ground so that the muzzle is facing up and away from the body.
- 3.) If using loose propellant, set your powder measurer to the desired amount and fill the powder measure. Pour powder into the muzzle. **WARNING!** To reduce the risk of an explosion, do not pour directly from the propellant container, do not exceed recommended loads (see load chart on page 14), and only load your Knight® Rifle with recommended black powder or black powder substitute. Never use smokeless powder!
- 4.) If using pelletized powder, place the recommended number of pellets into the muzzle. Read carefully the loading instructions of the propellant manufacturer and follow those instructions. Those instructions do vary from manufacturer to manufacturer.

WARNING! To reduce the risk of an explosion, do not exceed recommended loads (see load chart on page 16)

- 5.) If using sabots, place the bullet firmly in the proper sabot so that the bullet's base is squarely seated.
- 6.) Insert the projectile and start it down the bore using a Knight® Bullet Starter™.
- 7.) Using a hand over hand motion, drive the bullet down onto the powder charge using the concave end of the ramrod or cleaning jag. Do not pound or bounce the ramrod on the bullet. This will deform or displace the projectile, causing loss of accuracy and bullet performance. If using pelletized powder, this can also crack or crush the pellets, resulting in loss of accuracy and performance. **WARNING!** If the bullet is not seated firmly on the powder charge, the rifle may explode when fired.
- 8.) Remove your ramrod from the bore.
- 9.) Double check your trigger and secondary safeties and be sure that both are on safe. Be sure the rifle is pointed in a safe direction. Depending on your model, pull the hammer locks into firing position, open the bolt on a DISC™ Rifle, or release the drop or break-open action.
- 10.) Insert a priming device or 209 primed DISC Full Plastic Jacket™. Close the bolt and drop or break-open action.

Priming the Full Plastic Jacket™

- 1.) Insert the 209 shotgun primer into the large end of the Full Plastic Jacket™.



- 2.) Lift the bolt and pull back. Place the Full Plastic Jacket™ into the breech and close the bolt.



- 3.) A weather-proof seal is formed over the primer and nipple.



- 11.) (ACCURACY) Upon firing your cleaned and oiled rifle or shotgun if you notice any first shot accuracy or patterning issues, we recommend that you do the following each time before you load and fire your clean and oiled rifle and shotgun.

WARNING! Your rifle is now armed. Do not point your rifle at anything that you do not want to shoot.

Loading Instructions for the TK2000™ Muzzleloading Shotgun

- 1.) Make sure that all safety systems are engaged before loading and that there is no primer, live or spent, installed.
- 2.) Place the butt of the shotgun on the ground so that the muzzle is facing up and away from the body.
- 3.) Measure out either FFg black powder, or equivalent and pour into the barrel (120 grains maximum). Suggested 100 grain max when using T7. **WARNING!** To reduce the risk of an explosion, do not pour directly from the propellant container, do not exceed recommended loads (see load chart on page 15), and only load your Knight™ Rifle with a recommended black powder or black powder substitute. Never use smokeless powder! Do not use pelletized powder, it does not fit the 12 gauge bore properly and can cause an explosion, delayed ignition, or no ignition.
- 4.) Push an empty shot wad down the bore with the smaller end of the ramrod, seating the wad firmly on the powder charge. Fill a spare shot wad (of the same size) full with your choice of shot size, and carefully pour shot from the spare wad down the bore. Maximum of 2 1/2 oz. of shot.
- 5.) Push an over-shot wad down the bore with the jag end of the ramrod. Do not be concerned if the over-shot wad starts in sideways, as it will straighten itself out on the way down. Make sure the wad is firmly seated on the shot.
- 6.) With both safeties on and the muzzle pointed in a safe direction, prime the gun.

WARNING! Your shotgun is now armed. Do not point your shotgun at anything that you do not want to shoot.

Firing

- 1.) With your action cocked into the firing position and all safeties on, bring the muzzle-loader to your shoulder and put the desired target in your sights.
- 2.) When you are ready to shoot, screw the secondary safety in a counter-clockwise motion until it rests against the face of the hammer screw.
- 3.) Sight in on the target, move the trigger safety to **fire**.
- 4.) The muzzleloader can now be fired with the squeeze of the trigger. Be confident of your target and squeeze to fire.

Reloading

- 1.) Return all safeties to the **safe** position.
- 2.) Remove live or spent percussion caps and primers from your firearm.
- 3.) Leave the action open during swabbing and loading. (Except break open actions which should remain closed.)
- 4.) Place the butt of the rifle on the ground.
- 5.) Screw the cleaning jag into the ramrod.
- 6.) Moisten the cleaning patch with **Knight® Easy Clean™** and wring any excess out with your fingers.
- 7.) Using short, quick strokes with your ramrod and cleaning jag, swab the entire bore several passes with the wet patch until it makes contact with the breech plug. Remove and discard the soiled patch.
- 8.) Place a dry patch on the jag and swab the entire barrel again, making sure to contact the breech plug.

This process will ensure better shot to shot accuracy.

WARNING! Failure to swab the barrel as instructed before reloading could leave hot residue in the barrel which could result in accidental discharge during reloading.

WARNING! There are many black powder substitutes available. Read and follow all instructions and warnings provided by the manufacturer of the propellant you choose. Use and care instructions do vary from one manufacturer to another and from one product to another.

Blackhorn 209 Powder

Bolt Action: DO NOT exceed 120 volumetric units of Blackhorn 209

Peregrine: DO NOT exceed 160 volumetric units of Blackhorn 209

TK2000: DO NOT use

* Do not use Blackhorn 209 with flintlock, #11 percussion or musket caps.

* Using max loads can shorten the life of a breech plug.

Recommended Loads

Knight® Rifles are designed to perform best between 90 and 150 grains of Black Powder, and industry approved black powder substitutes. See maximum recommended load for specific models. **WARNING! Never use smokeless powder. It can cause your muzzleloader to explode.**

When determining the best load for your Knight® Rifle, follow these steps:

- 1.) Determine which game you intend to hunt and what bullet weight you intend to use. (see page 10) **WARNING! Knight® Rifles does not recommend the use of non-saboted lead projectiles, this includes patched round balls. These bullets can easily be moved from the powder charge. This will result in an obstructed barrel, and upon firing, could cause an explosion. If you choose or legally have to shoot non-saboted lead projectiles, always check that your projectile is properly seated immediately before priming and firing.**
- 2.) Sight in your rifle. Start with 100 grains of Black Powder and industry approved black powder substitutes, loose powder or pellets. If you don't achieve the desired results, go up or down in 10 grain increments and try sighting again.

Recommended Loads for the TK2000™

	Turkey	Upland Game	Water Fowl
SHOT	Use #4, #5, or #6 Knight® Red Hot™ lead shot, depending on your preference.	Use #4, #5, or #6 Knight® Red Hot™ lead shot, depending on your preference.	Ducks: Use #2, #3, or #4 Steel shot. Geese: #BB or #BBB.
POWDER	Use loose black powder or industry approved black powder substitute equivalent to maximum of 120 grains FFg. Use whichever is more comfortable for you or shoots the best pattern.	Use loose black powder or industry approved black powder substitute equivalent to maximum of 120 grains FFg. Use whichever is more comfortable for you or shoots the best pattern.	Use loose black powder or industry approved black powder substitute equivalent to maximum of 120 grains FFg. Use whichever is more comfortable for you or shoots the best pattern.
CHOKE	Use the extra-full choke that comes with the gun for the tightest patterns possible, and use only lead shot with this choke.	Knight Modified or Improved Cylinder Choke (accessory M900146/ M900148).	Only the Knight Improved Cylinder Choke (accessory M900146/ M900148) is to be used with steel shot.
WADS	Knight 3 1/2" shot wads.	Standard 1 1/8th ounce 12 gauge shotgun wads.	Knight 3 1/2" shot wads, or standard 3" 12 gauge wads.

Load Chart

Ballistics Chart

The following chart is intended to be used as a reference to assist you in determining what Knight bullet to use for what game. It is for reference only. You should ultimately decide what works best for you. All bullets are assumed to be in **Knight's® High Pressure Sabots™**.

GAME SIZE	BULLET WEIGHT	LOAD	POWDER TYPE	
Antelope, Whitetail, Mule Deer	.45 cal = 175, 195 Red Hots	120-150	Loose or Pelletized Powder	
	.50 cal = 250, 300 Red Hots	100-150	Loose or Pelletized Powder	
	.50 cal = 245, 285 Spitzer Boat Tails	100-150	Loose or Pelletized Powder	
	.52 cal = 275, 350, 375 Red Hots	130-150	Loose Powder ONLY	
	.50 cal = 310 Lead	90-120	Loose or Pelletized Powder	
	.50 cal = 260 Jacketed Hollow Point	90-120	Loose or Pelletized Powder	
	.50 cal = 250, 290 Polymer Tip	100-150	Loose or Pelletized Powder	
	Elk, Caribou, Moose	.50 cal = 250, 300 Red Hots	100-150	Loose or Pelletized Powder
		.52 cal = 275, 350, 375 Red Hots	130-150	Loose Powder ONLY
.50 cal = 285 Spitzer Boat Tails		100-150	Loose or Pelletized Powder	
.50 cal = 310 Lead		90-120	Loose or Pelletized Powder	
	.50 cal = 300 Jacketed Hollow Point	90-120	Loose or Pelletized Powder	
	.50 cal = 250, 290 Polymer Tip	100-150	Loose or Pelletized Powder	
	Big & Dangerous Game	.52 cal = 350, 375 Red Hots	130-150	Loose Powder ONLY

1.) Knight® Rifles are designed to perform best with Black Powder FFG, and industry approved black powder substitutes.

2.) Smaller Bullet weights will provide flatter trajectory, but may not be as accurate as the heavier, longer bullets.

3.) Heavier bullets will give better penetration and more energy transfer and are more suited to heavier powder charges.

100 Grains Triple 7 Pellets

150 Grains Triple 7 Pellets

Bullet Description	Range (yards)	Bullet			Bullet				
		Impact (inches)	Velocity (ft./sec.)	Energy (ft./lbs.)	Range (yards)	Impact (inches)	Velocity (ft./sec.)	Energy (ft./lbs.)	
.45/175 Knight Red	0	-1.50	1625	1026	0	-1.50	2368	2176	
	50	1.23	1483	854	50	0.17	2174	1837	
	100	0.00	1354	713	100	0.00	1991	1541	
	150	-5.99	1239	597	150	-2.37	1881	1284	
M900578 Saboted	200	-17.63	1151	515	200	-7.36	1657	1067	
	.45/195 Knight Red	0	-1.50	2086	1884	0	-1.50	2417	2529
		50	0.47	1879	1529	50	0.16	2192	2080
		100	0.00	1687	1232	100	0.00	1979	1695
150		-3.57	1511	988	150	-2.39	1779	1370	
M900580 Saboted	200	-10.98	1354	794	200	-7.50	1594	1100	
	.50/245 Knight	0	-1.50	1689	1553	0	-1.50	2069	2329
		50	1.49	1528	1270	50	0.86	1882	1927
		100	0.00	1383	1041	100	0.00	1706	1583
150		-6.05	1257	860	150	-3.85	1543	1296	
M900592 Boattail	200	-17.60	1154	724	200	-11.37	1397	1061	
	.50/250 Knight Red	0	-1.50	1719	1342	0	-1.50	2013	2249
		50	1.45	1544	1343	50	0.81	1816	1831
		100	0.00	1387	1068	100	0.00	1633	1480
150		-5.98	1252	870	150	-4.15	1466	1193	
M900590 Saboted	200	-17.53	1143	726	200	-12.25	1320	966	
	.50/250 Knight	0	-1.50	1677	1562	0	-1.50	1991	2202
		50	0.96	1522	1286	50	0.95	1814	1828
		100	0.00	1382	1061	100	0.00	1649	1509
150		-5.11	1260	882	150	-4.16	1496	1243	
M900594 Boattail	200	-15.25	1159	746	200	-12.21	1359	1026	
	.50/290 Knight	0	-1.50	1615	1681	0	-1.50	1944	2434
		50	1.23	1484	1419	50	0.61	1792	2067
		100	0.00	1365	1201	100	0.00	1648	1749
150		-5.89	1260	1023	150	-3.81	1514	1477	
M900595 Boattail	200	-17.26	1171	883	200	-11.42	1392	1249	
	.50/300 Knight Red	0	-1.50	1545	1591	0	-1.50	1929	2480
		50	1.84	1401	1308	50	1.04	1753	2049
		100	0.00	1275	1082	100	0.00	1590	1685
150		-7.20	1170	911	150	-4.49	1441	1384	
M900591 Saboted	200	-20.74	1088	788	200	-13.18	1309	1142	
	.52/275 Knight Red	0	-1.50	1729	1825	0	-1.50	2091	2669
		50	1.19	1499	1372	50	0.55	1825	2033
		100	0.00	1302	1036	100	0.00	1584	1531
150		-6.21	1150	807	150	-4.08	1373	1152	
M900582 Saboted	200	-18.56	1044	666	200	-12.55	1203	883	
	.52/375 Knight Red	0	-1.50	1570	2052	0	-1.50	1938	3127
		50	1.27	1471	1801	50	0.56	1807	2719
		100	0.00	1379	1583	100	0.00	1683	2357
150		-5.68	1295	1396	150	-3.68	1565	2040	
M900586 Saboted	200	-16.52	1220	1240	200	-10.97	1456	1765	

120 Grains Triple 7 Loose

Bullet Description	Range (yards)	Bullet Path (inches)	Velocity (ft./sec.)	Energy (ft./lbs.)
.45/185	50	0.50	1894	1473
Knight	100	0.00	1660	1131
Bloodline Bullet	150	-3.53	1448	861
Saboted	200	-11.42	1273	665
M900485	250	-24.61	1135	529
.45/200	50	.50	1892	1589
Knight	100	0.00	1679	1251
Bloodline Bullet	150	-3.50	1484	977
Saboted	200	-11.08	1317	770
M900486	250	-23.74	1179	617
.50/220	50	0.75	1691	1396
Knight	100	0.00	1439	1011
Bloodline Bullet	150	-5.08	1237	747
Saboted	200	-15.79	1088	578
M900541	250	-33.83	996	484
.50/250	50	0.73	1714	1630
Knight	100	0.00	1504	1255
Bloodline Bullet	150	-4.65	1323	971
Saboted	200	-14.32	1176	767
M900542	250	-30.12	1070	635
.50/275	50	0.89	1602	1566
Knight	100	0.00	1412	1217
Bloodline Bullet	150	-5.49	1259	967
Saboted	200	-16.39	1135	786
M900543	250	-34.09	1046	668
.50/300	50	1.16	1509	1516
Knight	100	0.00	1351	1215
Bloodline Bullet	150	-5.86	1215	983
Saboted	200	-17.73	1111	822
M900544	250	-36.59	1036	714
.52/220	50	0.71	1729	1460
Knight	100	0.00	1473	1059
Bloodline Bullet	150	-4.76	1264	780
Saboted	200	-15.00	1107	598
M900559	250	-32.29	1007	495
.52/275	50	0.78	1679	1721
Knight	100	0.00	1484	1344
Bloodline Bullet	150	-4.81	1317	1059
Saboted	200	-14.68	1179	848
M900563	250	-30.78	1077	708
.52/300	50	0.86	1620	1748
Knight	100	0.00	1442	1385
Bloodline Bullet	150	-5.31	1292	1111
Saboted	200	-15.71	1168	908
M900562	250	-32.47	1075	769
.54/325	50	1.66	1328	1272
Knight	100	0.00	1182	1008
Bloodline Bullet	150	-8.14	1081	843
Saboted	200	-23.36	1007	731
M900545	250	-47.49	949	649

Trigger Adjustment

WARNING!

All trigger and sear adjustments must be made by the factory or a certified gunsmith only. Incorrect adjustments can increase the risk of accidental discharge. Do not reduce trigger pull to less than three pounds, as this increases the risk of an accidental discharge. Creation of a lower trigger pull is an unauthorized alteration and is a misuse of the product. Any and all alterations voids warranty.

Bighorn™, Littlehorn™, TK2000™, DISC Extreme™, Long Range Hunter™, Mountaineer™ and Peregrine™.

All Knight® Rifles have crisp adjustable triggers that have been set at the factory for a clean release at approximately 3 1/2 pounds.

Sighting In

To shoot your rifle accurately, your rifle needs to be sighted in for your personal sight picture. Follow the loading procedures on pages 9-12 to sight your rifle accurately. Before loading and firing, be sure to read "General Loading and Firing" on page 9 and the section related to your particular model.

We recommend beginning "sight-in" at 50 yards, maintaining a point of impact 2" above the center of the bullseye. Then move to 100 yards for your final sight.

Your rifle's sights can be adjusted by moving the rear sight. To make your rifle shoot higher, move the rear sight higher. To make your rifle shoot lower, move the rear sight lower. When you want to move the impact of the projectile to the right, move the rear blade to the right. Regardless of the sight you have or its method of adjustment, move the rear sight in the direction you wish the impact of the projectile to move. Do not over tighten your sight screws.

All Knight® Rifles are drilled and tapped for easy mounting of scope rings and bases. When sighting in a scope, follow the manufacturer's directions. Scope mounts are recommended by rifle model.

Williams Sight



All Knight® Rifles are equipped with a removable breech plug for easier cleaning. The breech plug should be removed at the end of each shooting session for a thorough cleaning of the bore and breech area. Knight® Rifles manufactures several styles of breech plugs, and you should familiarize yourself with the one in your rifle.

WARNING! Using the wrong breech plug may cause the breech plug to blow out the back of the muzzleloader. When in storage or in use, the breech plug must always have high temperature synthetic grease, such as Knight's® Breech Plug Grease™, applied to the threads. This will help prevent the breech plug from becoming stuck in the receiver. Apply plenty of grease to all of the breech plug threads.

We have redesigned some of our breech plugs to better accommodate today's modern black powders. The fixed vent breech plug provides 40% longer life and drastically less blow-back. **The vent liner is fixed and non-removable.**

Knight® Peregrine™
10mm (.40), .45 Caliber
1 1/16" Bare 209 Primer w/Vent Liner
& Carbide Insert
M000620CB



Knight® Mountaineer™
.45, .50, .52 Caliber
1 1/16" Bare 209 Primer w/Vent Liner
M900020



Knight® DISC™ Western
.50 Caliber
#11 or Musket Cap
M900611



Knight® Mountaineer™
.45, .50, .52 Caliber
1 1/16" Full Plastic Jackets w/Vent Liner
M900018



Bighorn™, TK2000™
Littlehorn™
.50 Caliber, 5/8" - 18
#11 & Musket, Nipple Use
M900023



DISC Extreme™, LRH™
.45, .50, .52 Caliber, 1 1/16"
209 Primer w/FPJ w/Vent Liner
M900024



Bighorn™, Littlehorn™
TK2000™
.50 Caliber, 5/8"
209 Primer w/FPJ w/Vent Liner
M900021



Original DISC™
.45 & .50 Cal.
Hex Head
M900019



Bighorn™,
.52 Caliber, 1 1/16"
#11 & Musket
Nipple Use
M900032



Power Stem
.50 & .52 Cal. 1 1/16"
M900042



WARNING!

For loose powder only! Using pelletized powder can cause an explosion

Action: Patented Double Safety System, New C-Toolless, Quick Release, Removable Bolt Assembly. Removable Stainless Steel Breech Plug (see page 22 for breech plug identification for .40 and .45 caliber).

Barrel: 28' 416 Stainless Steel Helical Fluted Green Mountain® rifle barrel, 1:16" Twist 10mm/.40cal.

Ignition: Bare 209 primer ignition with tungsten carbide sleeved breech plug

Included In Package: Hex Head Combo Tool, 5/32 Allen Wrench, Bullet Sizing Die, Sizing Wrench

Length and Weight: 46.25 inches, 7.4 lbs.

Loading: General (see page 11)

Powder: Black Powder, and industry approved black powder substitutes. (Maximum Powder Charge) 160 grains by volume, in loose powder.

Sights: Scope Only

Stock: Refer to current catalog

Trigger: Adjustable Knight® Trigger with Metal Trigger Guard.

Warranty: Limited Lifetime with extended service policy. (See page 49)

***Note:** When using Weaver style bases, you may have to shorten the front screw of the front base (closest base and screw to the muzzle) approximately 1/16" for proper fit.

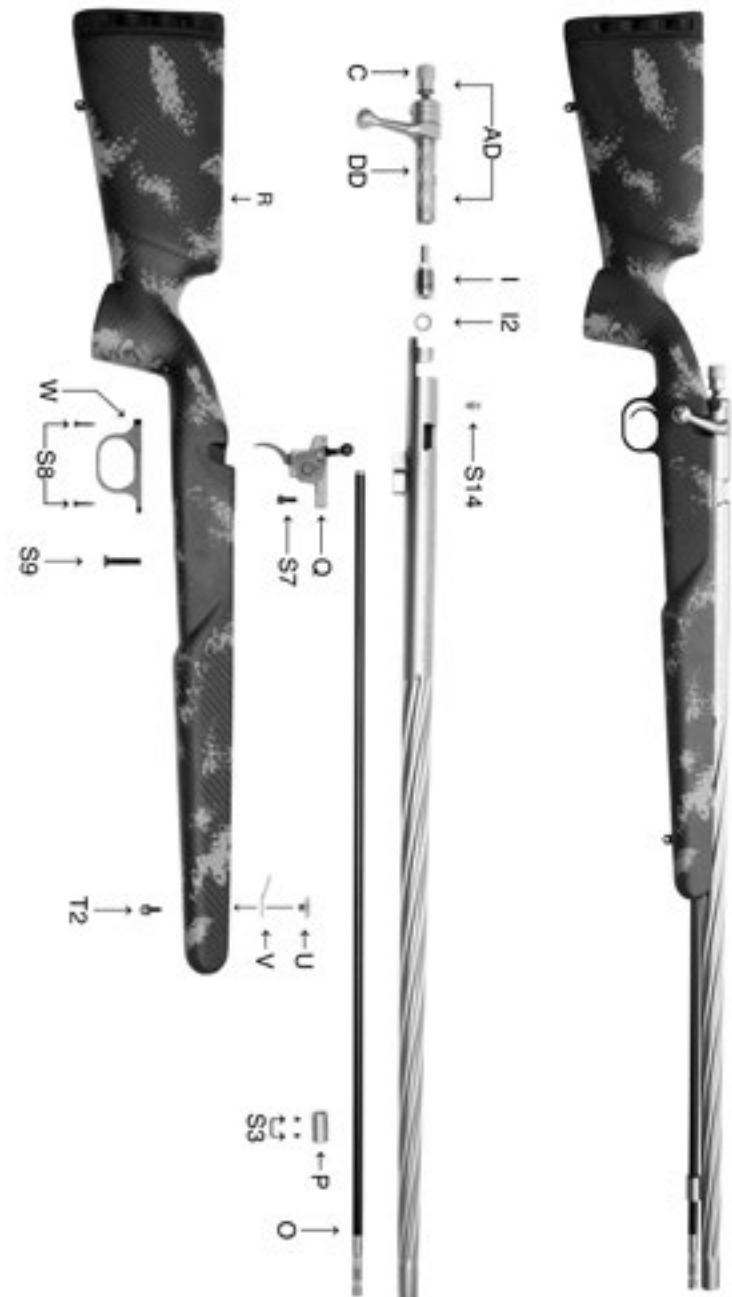

Receiver Hole Spacing for Scope Base Mounting

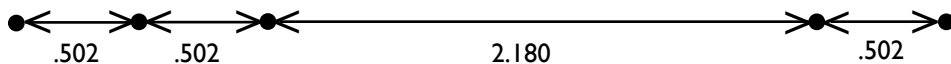

Action: Patented Double Safety System, New C-Toolless, Quick Release, Removable Bolt Assembly. Removable Stainless Steel Breech Plug (see page 22 for breech plug identification for .45, .50, and .52 caliber).

Ballistics/Recommended Loads: (see page 17)

Barrel: 27" Fluted Cantilever Lug Green Mountain® rifle barrel, 1:30" Twist .45 Stainless, 1:28" Twist, .50 Stainless, 1:26" Twist, .52 Stainless

Ignition: Bare 209 primer ignition, Full Plastic Jackets, or #11 Musket Cap

Included In Package: Hex Head Combo Tool, Five Plug Screws, 5/32 Allen Wrench

Length and Weight: 45.5 inches, 8.1 lbs.

Loading: General (see page 11)

Powder: Black Powder, and industry approved black powder substitutes. (Maximum Powder Charge) 150 grains by volume, in loose or the pelleted powders.

Sights: Fully Adjustable Metallic Red Fiber Optic Rear Sight and a one piece Green Fiber Optic Bead and base. Receiver drilled and tapped for easy scope mounting.

Stock: Refer to current catalog

Trigger: Adjustable Knight® Trigger with Metal Trigger Guard.

Warranty: Limited Lifetime with extended service policy. (See page 49)

***Note:** When using Weaver style bases, you may have to shorten the front screw of the front base (closest base and screw to the muzzle) approximately 1/16" for proper fit.

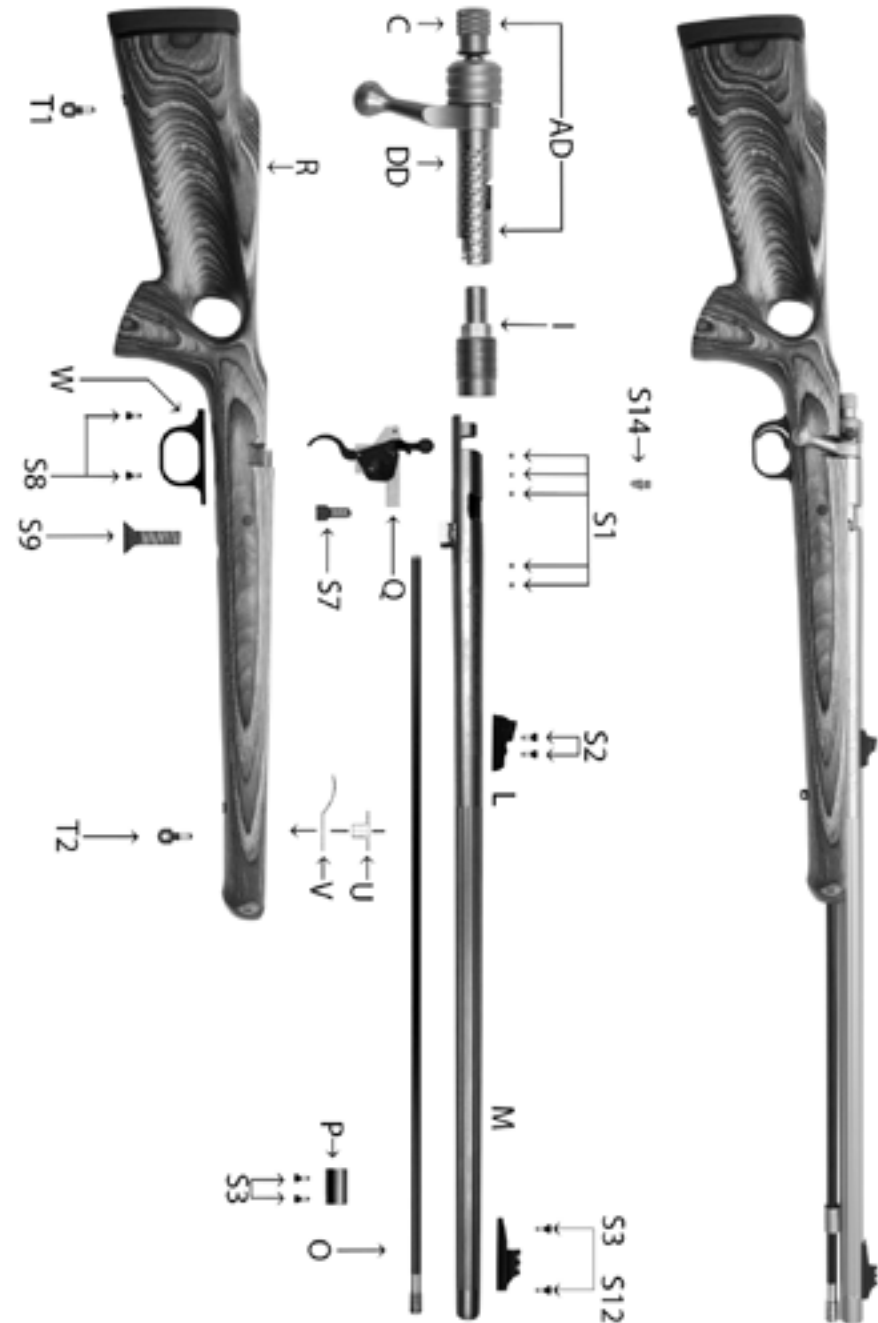

Receiver Hole Spacing for Scope Base Mounting

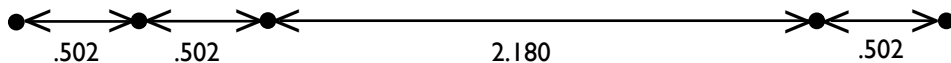

Action: Patented Double Safety System, New C-Toolless, Quick Release, Removable Bolt Assembly. Removable Stainless Steel Breech Plug (see page 22 for breech plug identification for .50 caliber).

Ballistics/Recommended Loads: (see page 17)

Barrel: 24" Contoured Stainless Steel Green Mountain® rifle barrel

Twist Rate: .50 Caliber, 1:28"

Ignition: Bare 209 primer ignition, Full Plastic Jackets, or #11, Musket Cap

Included In Package: Hex Head Combo Tool, Five Plug Screws, 5/32 Allen Wrench

Length and Weight: 41.75 inches, 6 lbs.

Loading: General (see page 11)

Powder: Black Powder, and industry approved black powder substitutes. (Maximum Powder Charge) 150 grains by volume, in loose or the pelleted powders.

Sights: Scope Only

Stock: Refer to current catalog

Trigger: Adjustable Knight® Trigger with Metal Trigger Guard.

Warranty: Limited Lifetime with extended service policy. (See page 49)

***Note:** When using Weaver style bases, you may have to shorten the front screw of the front base (closest base and screw to the muzzle) approximately 1/16" for proper fit.

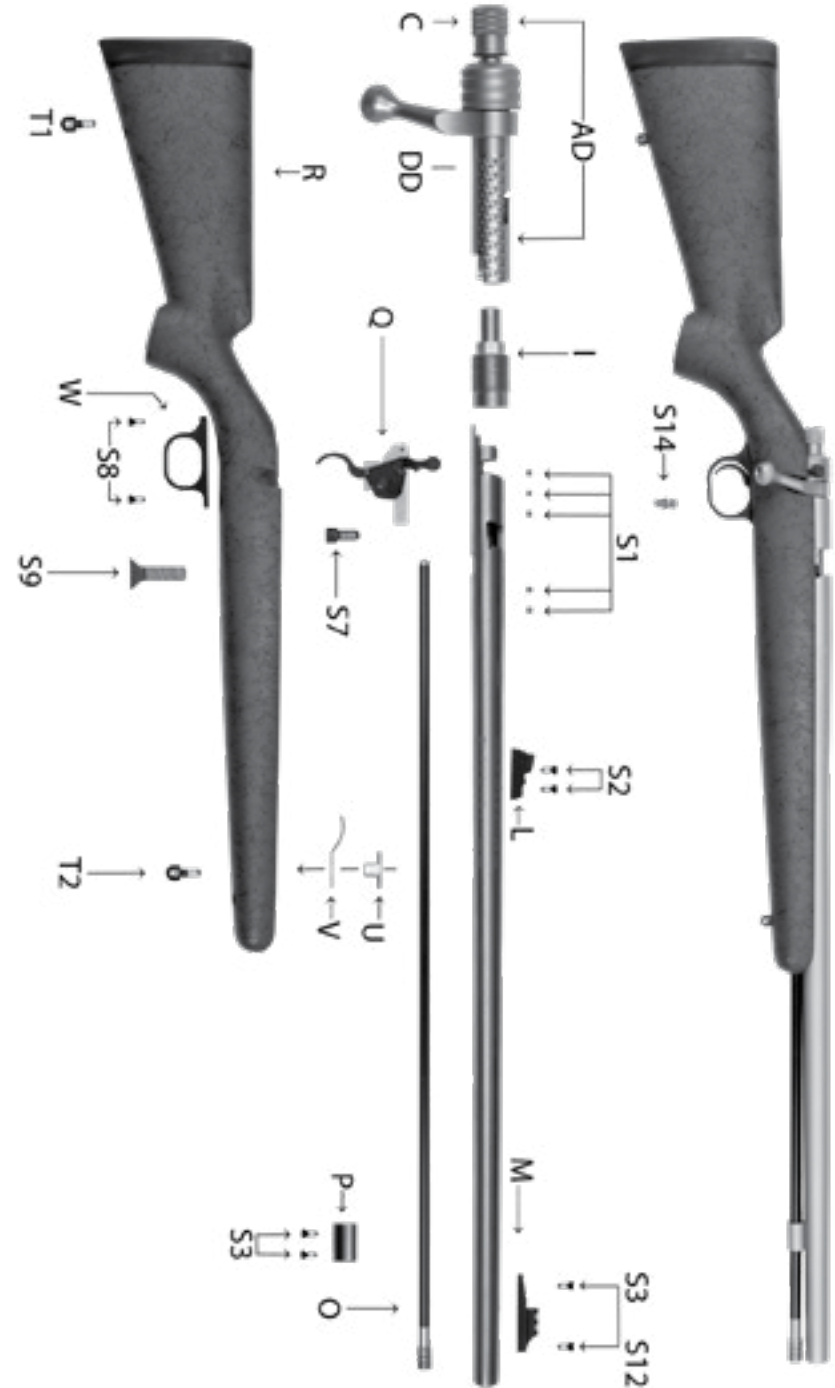

Receiver Hole Spacing for Scope Base Mounting

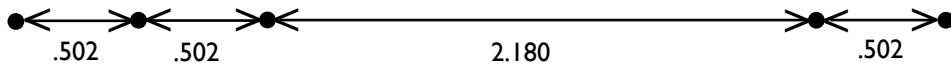

Action: Patented Double Safety System, New C-Toolless, Quick Release, Removable Bolt Assembly. Removable Stainless Steel Breech Plug (see page 22 for breech plug identification for .50 and .52 caliber).

Ballistics/Recommended Loads: (see page 17)

Barrel: 1:28" Twist, .50 Stainless, 26", 1:26" Twist, .52 Stainless, Green Mountain® rifle barrels.

Ignition: Full Plastic Jacket™, 209 Primer or #11, Musket Cap

Included In Package: Hex Head Combo Tool, Five Plug Screws, 5/32 Allen Wrench, Full Plastic Jackets.

Length and Weight: 45 inches, 7.8 lbs.

Loading: General (see page 11)

Powder: Black Powder FFG, and industry approved black powder substitutes. (Maximum Powder Charge) 150 grains by volume, in loose or the pelleted powders.

Sights: Fully Adjustable Metallic Red Fiber Optic Rear Sight and a one piece Green Fiber Optic Bead and base. Receiver drilled and tapped for easy scope mounting.

Stock: Refer to current catalog

Trigger: Adjustable Knight® Trigger with Metal Trigger Guard.

Warranty: Limited Lifetime with extended service policy. (See page 49)

***Note:** When using Weaver style bases, you may have to shorten the front screw of the front base (closest base and screw to the muzzle) approximately 1/16" for proper fit.

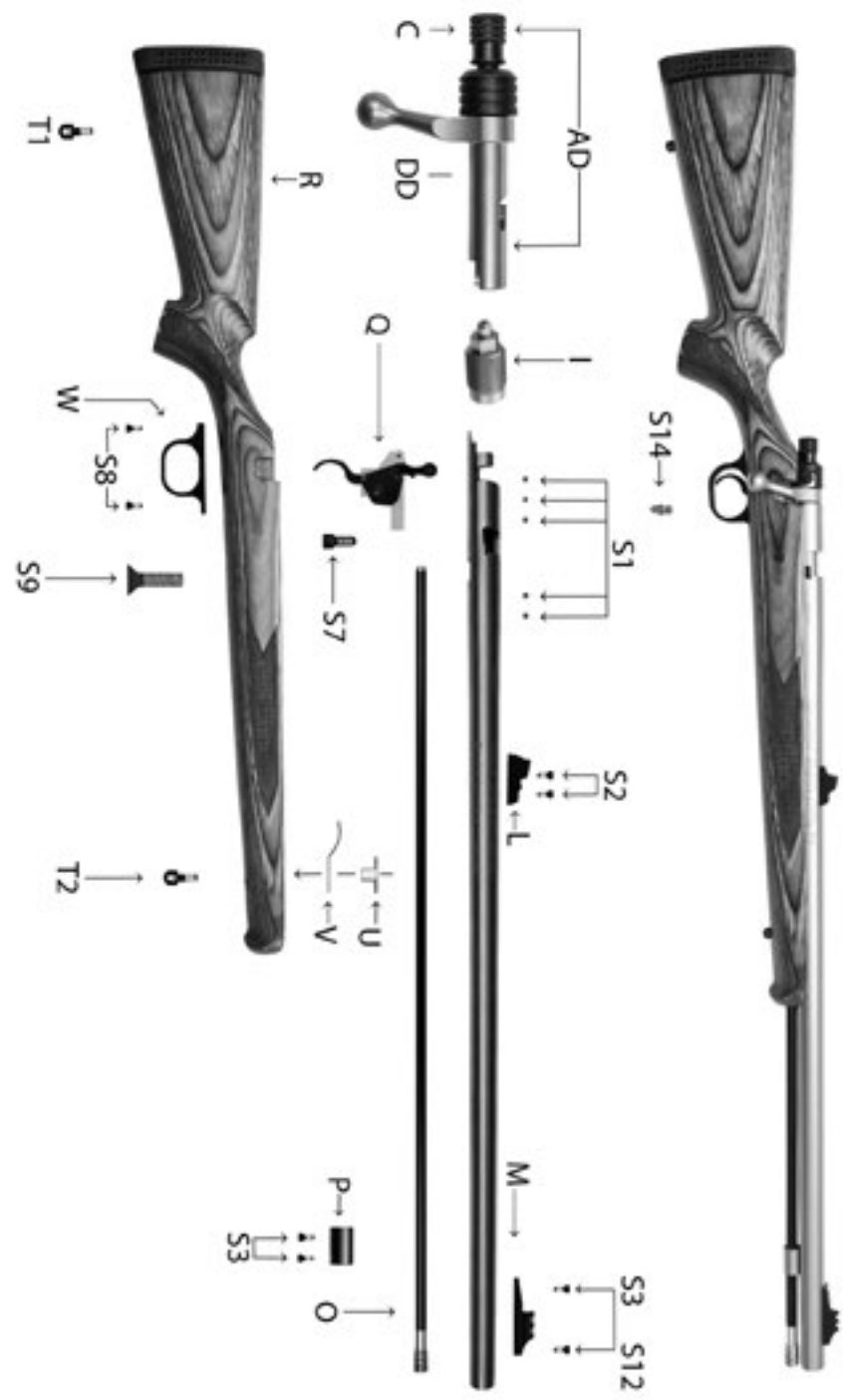

Receiver Hole Spacing for Scope Base Mounting

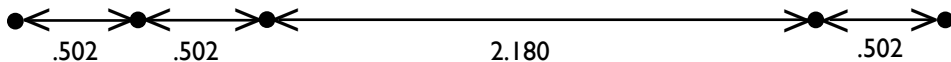

Action: Patented Double Safety System, New C-Toolless, Quick Release, Removable Bolt Assembly. Removable Stainless Steel Breech Plug (see page 22 for breech plug identification for .50 and .52 caliber).

Ballistics/Recommended Loads: (see page 17)

Barrel: 27", 1:28" Twist, .50 Stainless, 26", 1:26" Twist, .52 Stainless, Green Mountain® Spiral Fluted rifle barrel

Ignition: Full Plastic Jacket™, 209 Primer or #11, Musket Cap

Included In Package: Hex Head Combo Tool, Five Plug Screws, 5/32 Allen Wrench, Full Plastic Jackets.

Length and Weight: 45 inches, 8.6 lbs.

Loading: General (see page 11)

Powder: Black Powder, and industry approved black powder substitutes. (Maximum Powder Charge) 150 grains by volume, in loose or the pelleted powders.

Sights: Fully Adjustable Metallic Red Fiber Optic Rear Sight and a one piece Green Fiber Optic Bead and base. Receiver drilled and tapped for easy scope mounting.

Stock: Refer to current catalog

Trigger: Adjustable Knight® Trigger with Metal Trigger Guard.

Warranty: Limited Lifetime with extended service policy. (See page 49)

***Note:** When using Weaver style bases, you may have to shorten the front screw of the front base (closest base and screw to the muzzle) approximately 1/16" for proper fit.

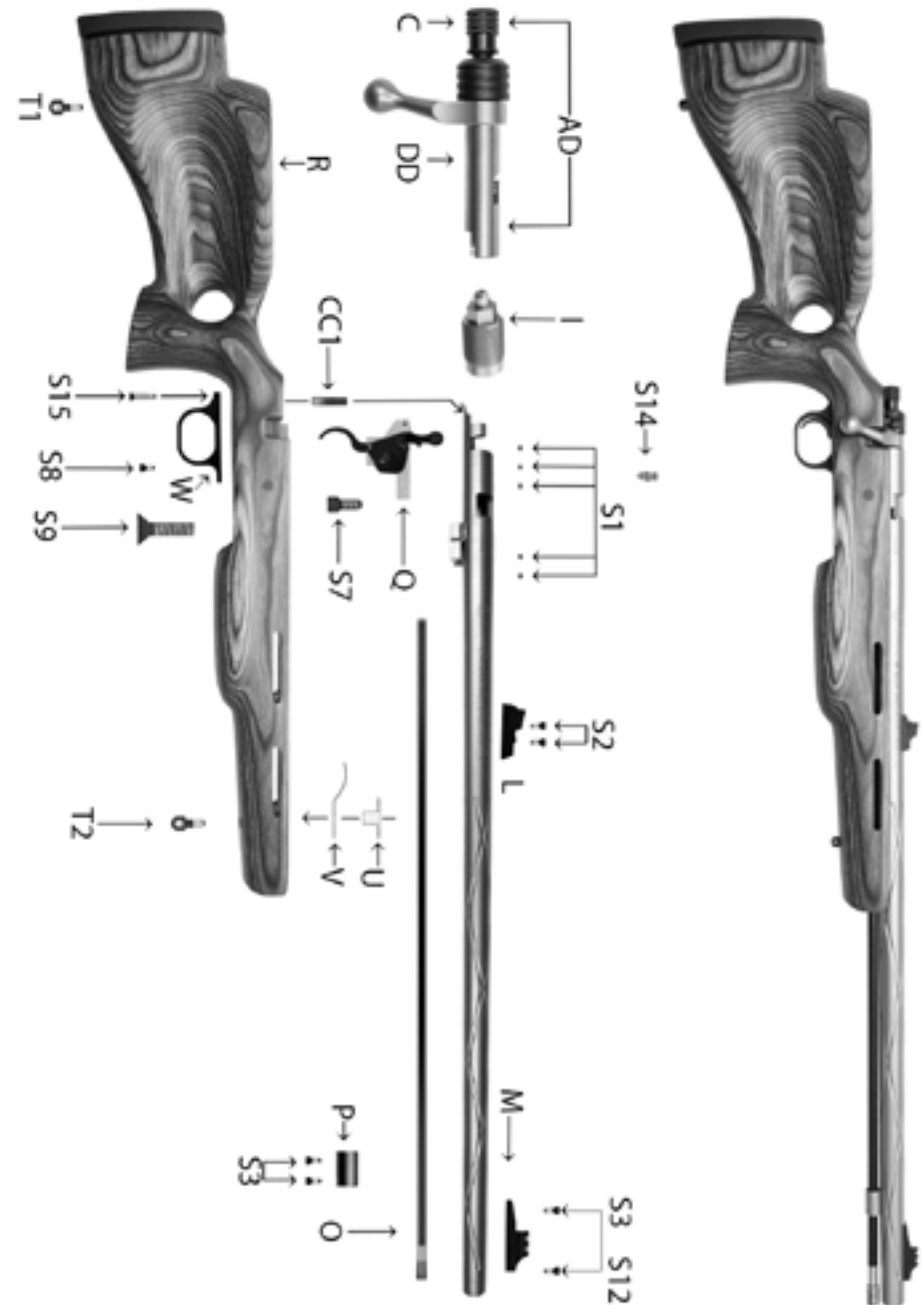

Receiver Hole Spacing for Scope Base Mounting

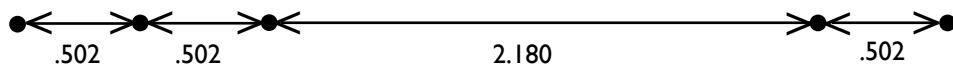

Action and Safety Systems

Bolt Action

The bolt has been designed for easy removal and breakdown for easy cleaning of internal and external surfaces. The rifle also features a removable breech plug, making it easier to clean the bore thoroughly from one end to the other. The design also allows you to unload the rifle without firing by pushing unfired powder and/or bullet out the back of the barrel with the ramrod.

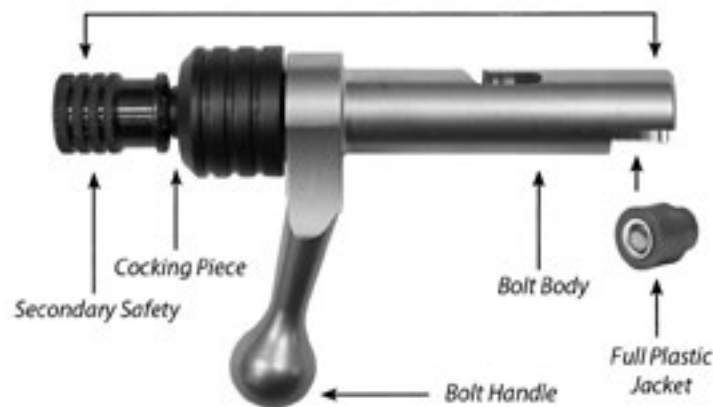

The bolt functions by lifting the handle and pulling back slightly to expose the priming port at the face of the bolt. This also cocks the hammer. To prime the rifle with a 209 primer, press the primer flush into the **Full Plastic Jacket™** (DISC). Insert the **Full Plastic Jacket™** in to receiver. When the bolt handle is pushed forward and down, it is formed over the primer and nipple. Full Plastic Jackets are not designed for reuse.

Patented Double Safety System

The trigger safety is located on the right side of the trigger. When the safety is pulled to the rear, it is in the **safe** position. This locks the trigger so that the hammer will not release. When the safety is pushed forward, it is in the **fire** position and the hammer will release if the trigger is pulled.

The secondary safety is located on the rear of the hammer or bolt. This safety is activated by turning the secondary safety in a clockwise motion. The use and design of the secondary safety is to keep the rifle from firing by not permitting the hammer to strike the igniter. When the safety is turned in a counter-clockwise motion until it stops, it is in the **fire** position. Both safeties must be in the **fire** position to fire the rifle.



Disassembly and Assembly

WARNING! Be sure rifle is not loaded or primed before disassembly or assembly.

Study the rifle schematic and acquaint yourself with the different parts and terminology of your muzzleloader before assembling or disassembling. Letters and numbers in parentheses refer to labels on each rifle schematic for each model.

It is advisable to use a padded vise to remove and reinstall the breech plug. Place small parts in a pan to avoid losing them.

Disassembly

- 1.) Remove the ramrod (O) from the stock and set aside.
- 2.) **(DISC Extreme™, Mountaineer™, Peregrine™ Only)** Remove the barreled action from the stock. The barreled action is held in the stock with one stock screw. It is located just forward of the trigger guard (W). Remove this screw and carefully separate the barrel assembly from the stock. Set the stock aside.
(Long Range Hunter™ Only) Remove the barreled action from the stock. The barreled action is held in the stock with two stock screws. One (S14) located just forward of the trigger guard (W) and the other (S15) behind and part of the trigger guard (W). The second stock screw releases the tension of the "C" clip (CCI) hold on the rear of the receiver. Remove these screws and carefully separate the barrel assembly from the stock and "C" clip. Set the stock aside.
- 3.) Remove the trigger assembly. Remove the trigger mounting screw (S7), and lift the trigger assembly from the receiver. Remove the bolt. Lift the bolt handle up, pull open the quick release detent screw that holds the bolt in place from the left side of the receiver, and pull the bolt out.
- 4.) Remove the breech plug. Insert the combo tool (breech plug wrench side) into the receiver, engage the breech plug (I) and turn it counterclockwise. This may require a considerable amount of force. (Holes in the combo tool allow a rod to be used for added leverage.)

Assembly

- 1.) Install the breech plug. Fill the threads of the plug with **Knight® Breech Plug Grease™** to help prevent the breech plug sticking in the receiver. Using the breech plug end of the combo tool, insert the breech plug **(I)** into the rear of the receiver and hand tighten the plug into the receiver until it is firmly against the back of the barrel. Be sure the breech plug is screwed all the way into the receiver. Do not over tighten the plug or it will become difficult to remove.
- 2.) Install the trigger. Using the trigger mounting screw **(S7)**, mount the trigger assembly **(Q)** to the receiver. Tighten until the trigger assembly is firm against the receiver. Make sure it is aligned with the receiver.
- 3.) Install the bolt. While pulling and holding open the quick detach bolt release button (left side of the receiver), slide the bolt all the way into the receiver. Let the release button close. Work the bolt down to the closed position.
- 4.) **(Long Range Hunter™ Only)** Install the barrel by first sliding the rear of the receiver into the “C” clip **(CC1)** and rocking the barrel into the stock. Replace and tighten both stock screws **(S14 & S15)**. Install the ramrod **(O)**.

DISC C-Toolless Bolt Removal and Disassembly

When you are ready to remove and clean your bolt, follow this procedure to avoid misalignment problems.

- 1.) With the rifle bolt handle in the up position, while pulling out on the spring loaded Quick Release bolt screw **(Photo #1)**, pull the bolt out of the receiver.
- 2.) Turn the secondary safety clockwise until the cocking piece is drawn up against the front edge of secondary safety. **(Photo #2)**
- 3.) Unscrew the striker assembly counterclockwise, until it is free from the bolt body. (Further disassembly is not required; doing so may result in your having to send the bolt back to be reassembled.)



- 4.) Clean and oil as necessary.

- 5.) To assemble, thread the striker assembly clockwise into the bolt body. Do not apply any pressure after the threading reaches the end. Do not tighten the striker against the bolt housing.
- 6.) When the striker assembly reaches the end of the threads, turn it counterclockwise, until reference points are aligned with each other. Hold your thumb against the bolt (this will help allow you to keep the bolt body striker assembly aligned correctly) then unscrew the secondary safety until there is no more pressure. If the assembly is not aligned, repeat steps 2, 3, 5, and 6.
- 7.) While pulling out on the spring-loaded **Quick Release™** bolt screw **(Photo #1)**, slide the bolt all the way back into the receiver. Release the bolt screw. Make sure the trigger and secondary safeties are both in the **safe** position. Close the bolt handle.
- 8.) The rifle is now in the cocked position with both safeties on.

209 Conversion Non-Full Plastic Jacket Breech Plugs

The DISC Extreme™ and Long Range Hunter™ can be converted to use 209 primers with out the **DISC Full Plastic Jacket™**.

- 1.) Remove old breech plug from rifle.
- 2.) Generously grease new breech plug with breech plug grease.
- 3.) Insert new breech plug utilizing existing combo tool.
- 4.) Place enclosed adaptor in bolt body as shown in figure below:



Mountaineer Bolt Bare Primer

The Mountaineer bare primer bolt loads a primer directly into the bolt. When the primer is placed, the bolt automatically lines up the primer to the breech plug. The bolt, when locked down, will tighten the primer into the breech plug.

(Picture of primer installed in bolt)

Action: Patented Double Safety System, Removable Hammer Assembly. Removable Stainless Steel Breech Plug (see page 22 for breech plug identification).

Ballistics/Recommended Loads: (see page 17)

Barrel:

Bighorn .50 Cal.: 26" Stainless steel Green Mountain® barrel, 1:28" Twist

Bighorn .52 Cal.: 26" Stainless steel Green Mountain® barrel, 1:26" Twist

Ignition: Full Plastic Jacket™, 209 Primer, #11, Musket-Cap Percussion.

Included In Package: Hex Head Combo Tool, Five Plug Screws, 5/32 Allen Wrench, Full Plastic Jackets, Capper/Decapper, Owners Manual.

Length and Weight: Bighorn: 44.5 inches, 7.8 lbs.

Loading: General (see page 11)

Powder: Black Powder, and industry approved black powder substitutes. (Maximum Powder Charge) 150 grains by volume, in loose or the pelleted powders.

Sights: Fully Adjustable Metallic Red Fiber Optic Rear Sight and a one piece Green Fiber Optic Bead and base. Receiver drilled and tapped for easy scope mounting.

Stock: Refer to current catalog

Trigger: Adjustable Knight® Trigger with Metal Trigger Guard

Warranty: Limited Lifetime with extended service policy. (See page 49)

***Note:** When using Weaver style bases, you may have to shorten the front screw of the front base (closest base and screw to the muzzle) approximately 1/16" for proper fit.

Receiver Hole Spacing for Scope Base Mounting

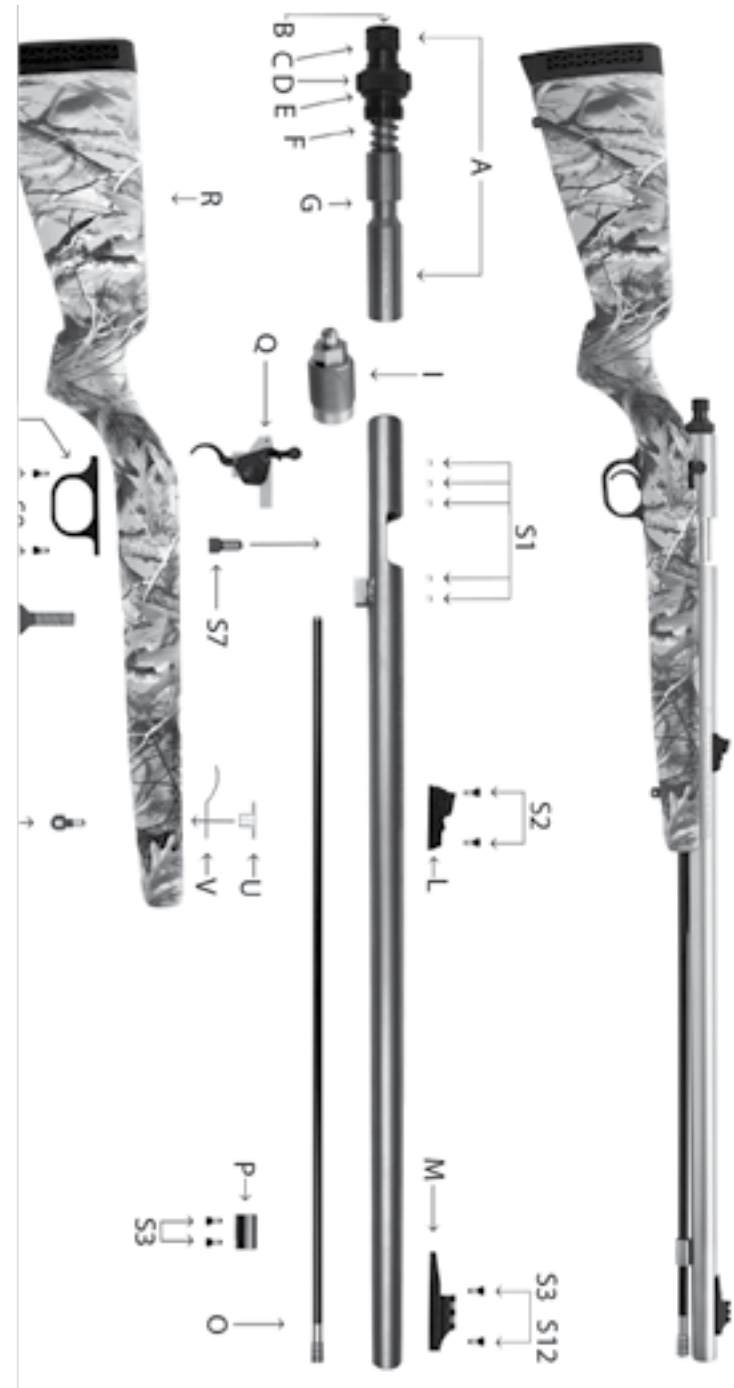
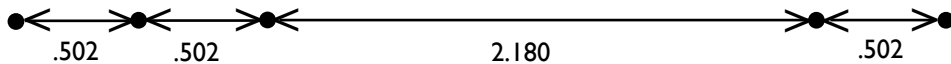

Action: Patented Double Safety System, one-piece removable Extreme 209 hammer assembly. Removable stainless steel breech plug (see page 22 for breech plug identification).

Loads: (see page 17)

Barrel: 26" 12 gauge with internal jug choking.

Ignition: Full Plastic Jacket™, 209 Primer #11 or Musket Cap

Included In Package: Hex Head Combo Tool, Five Plug Screws, 5/32 Allen Wrench, Full Plastic Jackets, Capper/Decapper, Overshot wads, Shot cups, Owners Manual.

Length and Weight: 45 inches, 7.7 lbs.

Loading: General (see page 11)

Powder: Black Powder, and industry approved black powder substitutes. (Maximum Powder Charge 120 grains by volume), recommended max 100 grains, when using T7.

Sights: Fully Adjustable Metallic Red Fiber Optic Rear Sight and a one piece Green Fiber Optic Bead and base. Receiver drilled and tapped for easy scope mounting.

Stock: Refer to current catalog

Trigger: Adjustable Knight® Trigger with Metal Trigger Guard

Warranty: Limited Lifetime. (See page 49)

***Note:** When using Weaver style bases, you may have to shorten the front screw of the front base (closest base and screw to the muzzle) approximately 1/16" for proper fit.

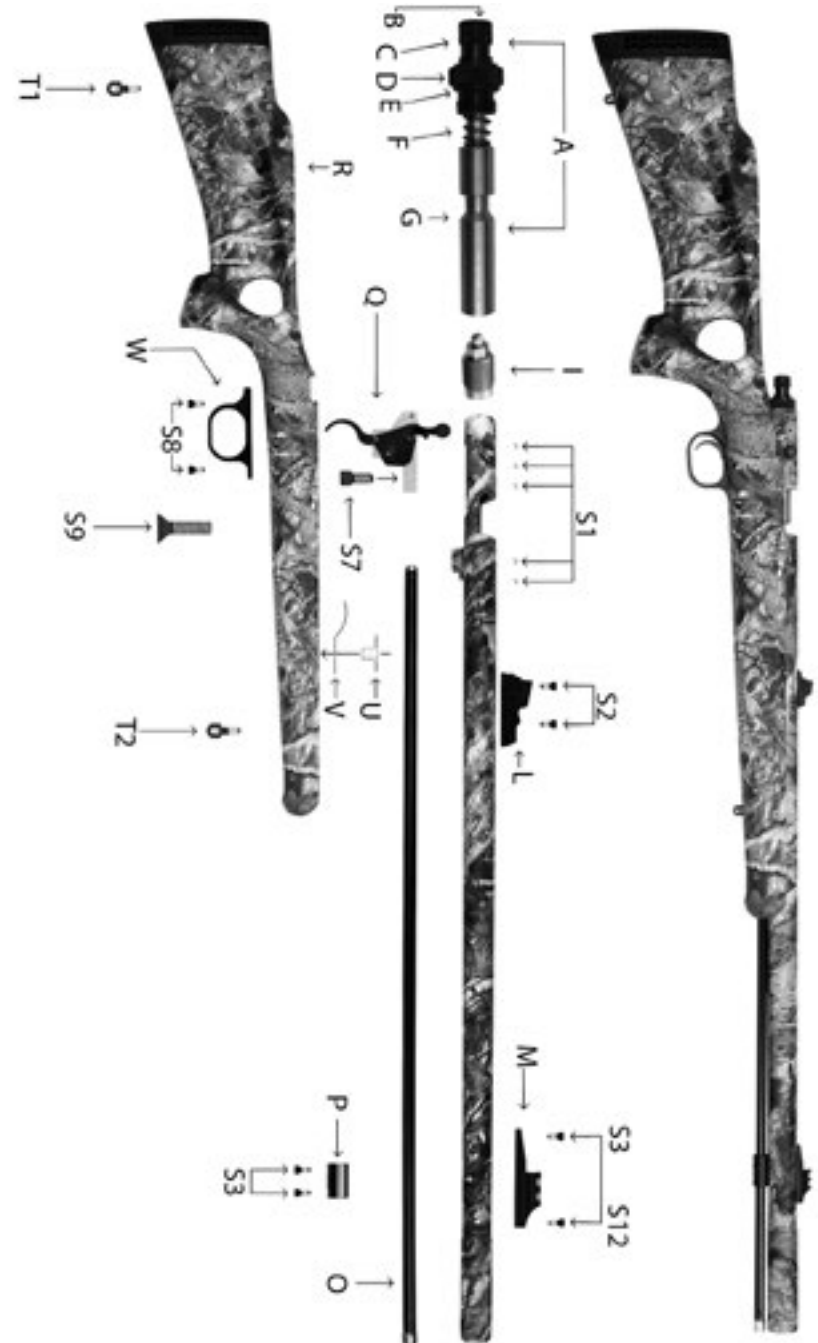

Receiver Hole Spacing for Scope Base Mounting

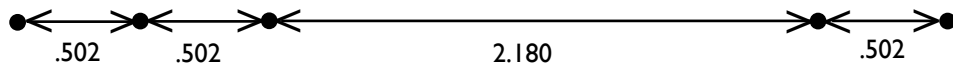

Action: Patented Double Safety System, Removable Hammer Assembly. Removable Stainless Steel Breech Plug (see page 22 for breech plug identification).

Ballistics/Recommended Loads: (see page 17)

Barrel: 22" Stainless steel hand crafted barrel, 1:28" Twist, .50 cal.

Ignition: Full Plastic Jacket™ - 209 primer, #1 I, Musket-Cap Percussion.

Included In Package: Hex Head Combo Tool, Five Plug Screws, 5/32 Allen Wrench, Full Plastic Jackets, Capper/Decapper, Owners Manual.

Length and Weight: 39 in., 6.4 lbs.

Loading: General (see page 11)

Powder: Black Powder, and industry approved black powder substitutes. (Maximum Powder Charge) 120 grains by volume, in loose or the pelleted powders.

Sights: Fully Adjustable Metallic Red Fiber Optic Rear Sight and a one piece Green Fiber Optic Bead and base. Receiver drilled and tapped for easy scope mounting.

Stock: Refer to current catalog

Trigger: Adjustable Knight® Trigger with Metal Trigger Guard

Warranty: Limited Lifetime with extended service policy. (See page 49)

***Note:** When using Weaver style bases, you may have to shorten the front screw of the front base (closest base and screw to the muzzle) approximately 1/16" for proper fit.

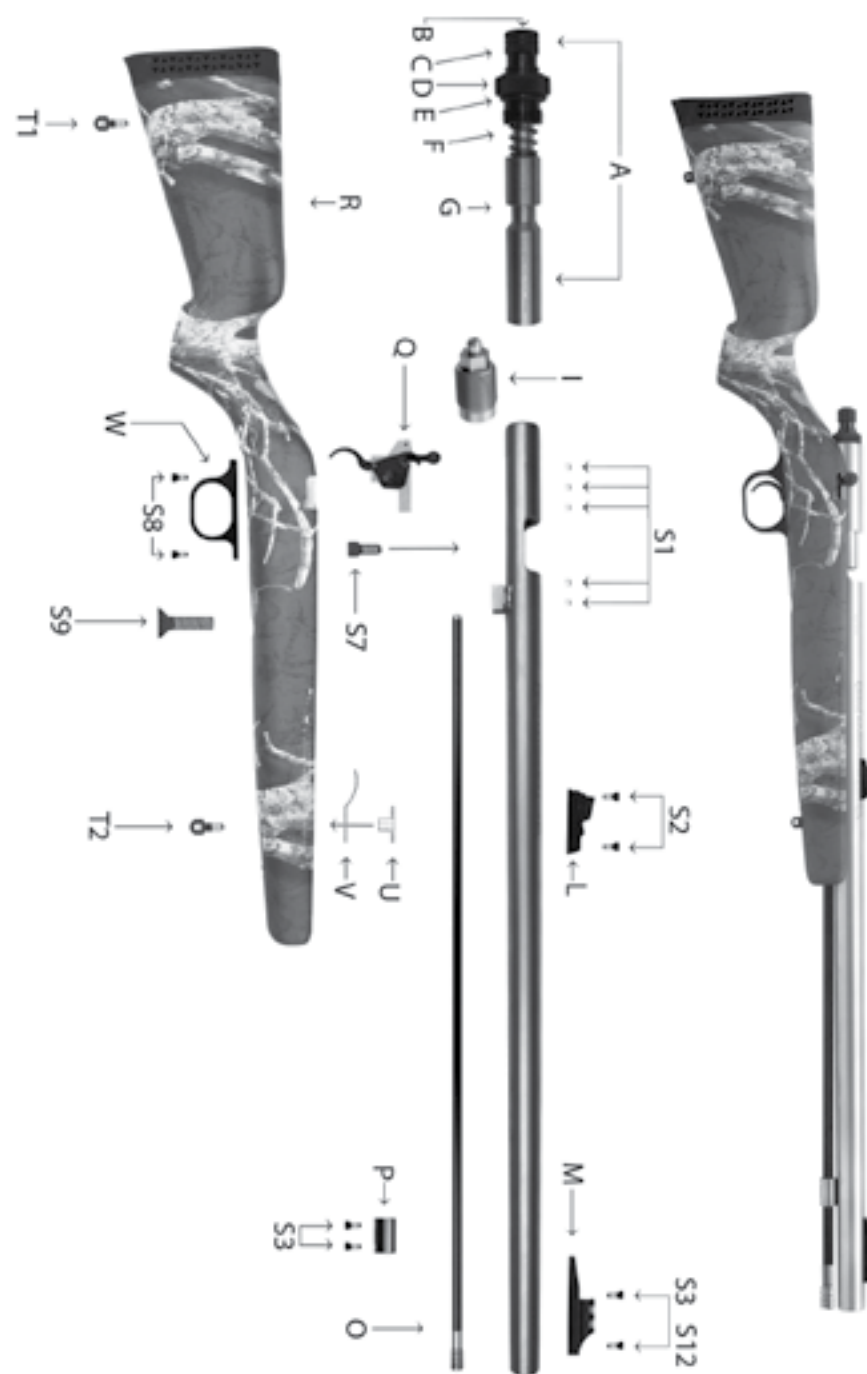

Receiver Hole Spacing for Scope Base Mounting

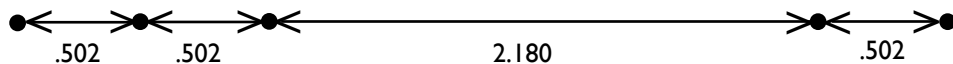

Action and Safety Systems

Straight Pull Action

The pull type system functions by pulling the hammer assembly back from the receiver until it cocks. With both safeties off, the hammer under the spring tension is released with a pull of the trigger. The hammer slides through the receiver and strikes the primer. With the rifle primed, using a 209 primer in the red **Full Plastic Jackets™**, a spark moves forward through the breech plug and ignites the powder charge. Because Knight® Rifles's ignition system is in line with the barrel, hammer release, primer firing, and powder charge ignition, it spontaneously gives a more uniformly burned charge with superior accuracy.



Patented Double Safety System

The trigger safety is located on the right side of the trigger. When the safety is pulled to the rear, it is in the *safe* position. This locks the trigger so that the hammer will not release. When the safety is pushed forward, it is in the *fire* position, and the hammer will release if the trigger is pulled.

The secondary safety is located on the rear of the hammer or bolt. This safety is activated by turning the secondary safety in a clockwise motion. The use and design of the secondary safety is to keep the rifle from firing by not permitting the hammer to strike the igniter. When the safety is turned in a counter-clockwise motion until it stops, it is in the *fire* position. Both safeties must be in the *fire* position to fire the rifle.



WARNING! Be sure the muzzleloader is not loaded or primed before disassembly or assembly.

Study the rifle schematic and acquaint yourself with the different parts and terminology of your muzzleloader before assembling or disassembling. Letters and numbers in parentheses refer to labels on each rifle schematic for each model.

It is advisable to use a padded vise to remove and reinstall the breech plug. Place small parts in a pan to avoid losing them.

Disassembly

- 1.) Remove the ramrod (O) from the stock and set aside.
- 2.) Remove the barreled action from the stock. The barreled action is held in the stock by a single stock screw (S9) located just forward of the trigger guard (W). Remove this screw and carefully separate the barrel assembly from the stock (R). Set the stock aside.
- 3.) Remove the trigger assembly. Remove the trigger mounting screw (7), and lift the trigger assembly from the receiver.
- 4.) Remove the hammer assembly. Unscrew the end cap (D) in a counter-clockwise direction. Pull the hammer assembly backward removing the hammer from the receiver.
- 5.) Remove the breech plug. Insert the combo tool (breech plug wrench side) into the receiver, engage the breech plug (I) and turn it counter-clockwise. This may require a considerable amount of force. (Holes in the combo tool allow a rod to be used for added leverage).

Assembly

- 1.) Install the breech plug. Fill the threads of the plug with **Knight® Breech Plug Grease™** to help prevent the breech plug from sticking in the receiver. Using the breech plug end of the combo tool, insert the breech plug (I) into the rear of the receiver and hand tighten the plug into the receiver until it is firmly against the back of the barrel. Be sure the breech plug is screwed all the way into the receiver. Do not over-tighten the plug or it will become difficult to remove.
- 2.) Install the trigger. Using the trigger mounting screw (S7), mount the trigger assembly (Q) to the receiver. Tighten until the trigger assembly is firm against the receiver. Make sure it is aligned with the receiver.
- 3.) Install the hammer. Place the trigger safety in the forward *fire* position. While pulling the trigger back, slide the hammer assembly (A) into the receiver and past the trigger sear. Screw the end cap (D) clockwise into place, finger tight.
- 4.) Install the barrel and stock. Place the barreled action into the stock and tighten the stock screw (S9). Install the ramrod (O).

Part Ref.	Model No.	Description
A	M090215	HAMMER ASSEMBLY, 5/8 .50, MS, BIGHORN, TK2000, LITTLEHORN
A	M090222	HAMMER ASSEMBLY, 11-16, .52 Cal., MS, BIGHORN
AD	M090232	BOLT ASSEMBLY, SS, DISC EXTREME (C-toolless), LRH
AD	M090210	BOLT ASSEMBLY, SS, MOUNTAINEER
AD	M900690U	BOLT ASSEMBLY, SS, ULTRA-LITE, BARE PRIMER
AD	M900691U	BOLT ASSEMBLY, SS, ULTRA-LITE, FPJ
AD	M090210PB	BOLT ASSEMBLY, SS, PEREGRINE
B	M00871	HAMMER SCREW, MS, 10-32 X 3/8 allen head, BIGHORN, DISC EXTREME, TK2000
B	M000881	HAMMER SCREW, SS, 10-32 X 3/8 allen head, MOUNTAINEER
C	M090850	SECONDARY SAFETY, Blued, LITTLEHORN, TK2000, Bighorn
C	M090860	SECONDARY SAFETY, SS, MOUNTAINEER
C	M090854	SECONDARY SAFETY, SS, PEREGRINE
CCI	M010292	REAR CLAMP, LRH
D	M090810	END CAP, MS, BIGHORN, TK2000, LITTLEHORN
DD	M000688	DISC BOLT BODY, SS, DISC EXTREME, LRH
DD	M000690	MOUNTAINEER BOLT BODY, SS
DD	M000692PB	PEREGRINE BOLT BODY, SS
E	M000813	END CAP O-RING, BIGHORN, TK2000, LITTLEHORN
F	M000785	HAMMER SPRING, BIGHORN, TK2000, LITTLEHORN
G	M000718	HAMMER RAW, 416 SS, 5/8, BIGHORN, TK2000, LITTLEHORN
G	M000717	HAMMER RAW, 416 SS, 11-16, BIGHORN, .52 Cal.
I	M900020	BREECH PLUG, SS, 11-16, .50 - .52 Cal., MOUNTAINEER
I	M900024	BREECH PLUG, SS, 11-16, .45, .50, .52 Cal., DISC EXTREME
I	M900042	BREECH PLUG, SS, 11-16, .52 Cal., BIGHORN, .50, .52 Cal. DISC EXTREME, .50, .52 Cal LRH, POWER STEM
I	M900021	BREECH PLUG, SS, 5/8, 50 Cal., BIGHORN, LITTLEHORN, TK2000, FULL PLASTIC JACKETS
I	M900023	BREECH PLUG, SS, 50 Cal., BIGHORN, #11 & MUSKET NIPPLES
I	M900032	BREECH PLUG, SS, 11-16, .52 Cal., BIGHORN, #11 & MUSKET NIPPLES
I	M900634	BREECH PLUG, SS, 11-16, .54 Cal., From EXTREME KIT 900604
I	M000620CB	BREECH PLUG, SS, 11-16, 10mm/.40 - .45 Cal., PEREGRINE
I2	M09CW001	COPPER CRUSH WASHER, 10mm/.40 - .45 Cal., PE

Part Ref.	Model No.	Description
L	M008814	SIGHT, Rear Assembly (Base & Fiber Optic Blade, Screws) Fits all Knight Rifles
M	M900175	SIGHT, Front Green Fiber Optic (1 Piece Base & Bead) Fits all Knight Rifles
O	M010112F	RAMROD, 28", with Extending Jag .45 Cal, Peregrine
O	M010111F	RAMROD, 28", with Extending Jag 10mm/.40 Cal, Peregrine
O	M900086F	RAMROD, 27", with Extending Jag .45 Cal, MOUNTAINEER, LRH
O	M900092F	RAMROD, 27", with Extending Jag .50 Cal, MOUNTAINEER, LRH
O	M900087F	RAMROD, 27", with Extending Jag .52 Cal, MOUNTAINEER, LRH
O	M900088F	RAMROD, 26", with Extended Jag .50 Cal., BIGHORN, DISC EXTREME
O	M900091F	RAMROD, 26", with Extended Jag .52 Cal, BIGHORN, DISC EXTREME
O	M900085F	RAMROD, 24" with Extended Jag .50 Cal.
O	M900084F	RAMROD, 22" with Extended Jag .50 Cal. Littlehorn
O	M010098	RAMROD, 26" with Extending 12 Gauge Jag, TK2000
P	M090901	RAMROD GUIDE, SS, all stocks
Q	M090275P	TRIGGER ASSEMBLY, 10mm/.40, 45 Cal. PEREGRINE
Q	M090262	TRIGGER ASSEMBLY, .50, .52 Cal. BIGHORN, LITTLEHORN, TK2000
Q	M090266	TRIGGER ASSEMBLY, DISC EXTREME, LRH
Q	M090275	TRIGGER ASSEMBLY, MOUNTAINEER
R	M090208	STOCK (Carbon fiber), PEREGRINE Sage Brush Camo SS
R	M900202TH	STOCK, MOUNTAINEER Forest Green TH
R	M900201TH	STOCK, MOUNTAINEER Shadow Gray TH
R	M900201S	STOCK, MOUNTAINEER Shadow Gray SS
R	M900200	STOCK, MOUNTAINEER Nutmeg Left-Handed TH
R	M900501C	STOCK, DISC EXTREME CarbonKnight SS
R	M900200	STOCK, DISC EXTREME Nutmeg Left-Handed TH
R	M900102C	STOCK, BIGHORN CarbonKnight SS
R	M900102C	STOCK, BIGHORN True Timber MC2 SS
R	M900158P	STOCK, LITTLEHORN True Timber Pink SS

Part Ref.	Model No.	Description
S1	M090253	SCREW, Plug Screw, MS, 6-48
S2	M010030	SCREW, Sight, 6-48 x .260
S3	M010020	SCREW, Sight, 6-48 x .160
S7	M008700	SCREW, Trigger Mounting, 10-32 x 1/2, ALL RIFLES
S8	M010140	SCREW, Trigger Guard, Wood Screws, ALL RIFLES
S9	M010210	SCREW, Stock, 1/4-20 x 1, ALL RIFLES
S14	M008462	SCREW, Quick Release Detent, DISC EXTREME, PEREGRINE, MOUNTAINEER, LRH
S15	M010141	SCREW, Trigger Guard, LRH
T1	M010160	SWIVEL STUD, Rear, QD std wood screw, MS, all other stocks—except Peregrine
T2	M010150	SWIVEL STUD, Front, QD, 3/8 mach screw, MS, all other stocks
U	M010232	BASE WELD NUT, 10-32 Front Swivel Stud, All Stocks
V	M010242	RAMROD SPRING LEAD, all stocks
W	M010131	TRIGGER GUARD, LRH
X	010202	STOCK BUSHING SCREW, MS, .250
	M010152	BULLET SIZER, 10mm (.40Cal.)
	M010153	SIZER WRENCH
	M120111	ALLEN WRENCH, 5/32
	M900977S	COMBO TOOL, 5.5" Hex/Nipple Headed, BIGHORN
	M900978S	COMBO TOOL, Hex Head, Stainless Steel
	M090975S	COMBO TOOL, Hex Head, Stainless Steel 9.5 PEREGRINE
	M201102	OWNER'S MANUAL

Service Policy

Every Knight® muzzleloader is carefully inspected and tested in order to ensure that it conforms to Knight's® strict specifications and standards.

Any alteration, modification, misuse, repair, or refinishing will result in voiding the warranty. If there is any question regarding the performance of your muzzleloader, please write our Service Department, fully describing all circumstances and conditions involved. If our Service Department makes the determination that your muzzleloader requires factory service you will be so advised and will be given instructions for the most expeditious handling of your muzzleloader.

Our Service Department will give your muzzleloader a complete inspection and evaluate the problem(s) specified in your letter. If the work required is not covered under the terms of our Limited Lifetime Warranty or Limited Lifetime Warranty with Extended Service Policy, you will receive an actual cost quotation, not an estimate. Any repair work must be authorized by you, and no work will be done without your express approval.

Instructions for Return

Following these instructions will ensure you the best possible service. IF for any reason you should have to return the muzzleloader, **please use extreme caution and make certain that it is unloaded.**

- 1.) Package the muzzleloader securely to prevent damage in transit.
- 2.) Ensure that a letter is securely and obviously attached to the muzzleloader. This letter should include your full name, address, and telephone number where you may be reached both during normal business hours and at your residence. Include a thorough description of the problem that you encountered with your muzzleloader so that we may make proper repairs. Please make your letter as clear as possible (using diagrams, if possible); please write or print legibly or have the letter typed. If you prefer, you may call Knight Rifles at the number listed below or e-mail at **customer_service@knightrifles.com**.
- 3.) Send your muzzleloader prepaid UPS or UPS Standard Post insured to the address listed below. C.O.D. shipments will not be accepted.

If you need further help or information concerning this warranty, please write or call the Knight® Rifles Service Department at the following address:

Knight Rifles®
 21822 Hwy. J46
 Centerville, IA 52544
 Telephone: (641) 856.2624 ext. 104
 Web Site: www.muzzleloaders.com

Knight Rifles®
 213 Dennis St.
 Athens, TN 37303
 Telephone: (866) 518.4181
 E-mail: customer_service@knightrifles.com

Warranty Limitations

Knight® products are sold by us with the specific understanding that we are not responsible in any manner whatsoever for their safe handling or resale under local, state, and federal laws and regulations. Knight® Rifles shall not be responsible in any manner whatsoever for malfunctioning of the muzzleloader, for physical injury, or for property damage resulting in whole or in part from:

- 1.) Accidental or negligent discharge
- 2.) Improper or careless handling
- 3.) Unauthorized modifications
- 4.) Defective or improperly loaded powder or projectile
- 5.) Corrosion
- 6.) Neglect
- 7.) Other occurrences beyond our direct and immediate control.

This limitation applies regardless of whether liability is asserted on the basis of contract, negligence, or strict liability (including failure to warn). Under no circumstances shall Knight® Rifles be liable for incidental or consequential damages, such as loss of use of property, commercial loss, and loss of earning profits.

Knight® Rifles is not responsible for any alterations to your Knight® Muzzleloader™ or any part thereof after it leaves our control, or for the additional substitution of parts or accessories not manufactured by Knight® Rifles. Any changes made in this product are specifically contrary to our instructions, and we expressly do not authorize any changes to be made after manufacture. **Any alteration will result in voiding the warranty.**

If you need further help or information concerning this warranty, please write or call the Knight® Rifles Service Department at the following address:

Knight Rifles®
21822 Hwy. J46
Centerville, IA 52544
Telephone: (641) 856.2624 ext. 104
Web Site: www.muzzleloaders.com

Knight Rifles®
213 Dennis St.
Athens, TN 37303
Telephone: (866) 518.4181
E-mail: customer_service@knightrifles.com

Limited Lifetime Warranty Extended Service Policy (Peregrine™, Mountaineer™, DISC Extreme™, Bighorn™, Littlehorn™, TK2000™, Long Range Hunter, Wolverine™)

Year 1:

Knight® Rifles will repair or replace any defective part caused by defective materials/craftsmanship.

Year 2-5 (extended service policy - Peregrine™, Mountaineer™, DISC Extreme™, Bighorn™, Long Range Hunter™, TK2000™, Wolverine™, Littlehorn™):

Knight® Rifles will replace or repair any defective threaded parts caused by defective material/craftsmanship.

Lifetime:

Knight® Rifles will replace or repair a defective barrel or receiver caused by defective material/craftsmanship.

Warranty Limitation:

- Warranty begins at the original date of purchase
- Warranty applies only to normal use
- Warranty only applies to original purchaser
- Warranty does not apply to wear items such as nipples, breech plugs

Warranty is Void if:

- Serial number is defaced
- There is a defect due to damage or product alteration
- Product is not used in accordance with use and care instructions
- Rifle is not cleaned per owner's manual
- Knight® Rifles is not responsible for any incidental or consequential damages

Owners Responsibilities:

- Provide proof of purchase (sales invoice/canceled check/warranty card/UPC code)
- Normal care and maintenance
- Replacing owner replaceable items
- Shipping/handling and insurance on a factory return
- Normal cleaning as instructed per owner's manual

No other warranties. To the maximum extent permitted by applicable law, Knight® Rifles disclaims all other warranties, either express or implied, including, but not limited to, implied warranties of merchantability and fitness for a particular purpose.

KNIGHT RIFLES MAKES NO REPRESENTATION OR WARRANTY THAT ITS PRODUCT EXTENDS A WARRANTY OF FITNESS FOR A PARTICULAR PURPOSE.

This limited warranty gives you specific legal rights. You may have others which vary from state/jurisdiction to state/jurisdiction.

No Liability for Consequential Damages. To the maximum extent permitted by applicable law, in no event shall Knight® Rifles or its suppliers be liable for any damages whatsoever (including, without limitation, special, incidental, consequential, or indirect damages for personal injury or any other pecuniary loss) arising out of the use of or inability to use this product, even if Knight® Rifles has been advised of the possibility of such damages. In any case, Knight® Rifles' and its suppliers' entire liability under any provision of this agreement shall be limited to the amount actually paid by you for the product. Because some states/jurisdictions do not allow the exclusion or limitation of liability for consequential or incidental damages, the above limitation may not apply to you. This warranty gives you specific legal rights, and you may have others which vary from state to state. For example, some states do not allow the exclusion or limitation of incidental or consequential damages, so this exclusion may not apply to you.

Do not return your muzzleloader to the store.

Most problems can be resolved by simply calling Knight® Rifles at (866) 518-4181. Should your firearm require adjustment, repair, or refinishing, we strongly recommend that it be returned to Knight® Rifles for factory service or contact the dealer you purchased your rifle from.

Knight® Rifles • 21822 Hwy. J46 • Centerville, IA 52544.

Disclaimer: Knight® Rifles are designed for use with Black Powder, and industry approved black powder substitutes. Our products are designed specifically for use on Knight® rifles. Knight® Rifles expressly disclaims any and all liability for incidental or consequential damages due to the misuse or altering of these rifles and products; any mishandling (whether accidental or purposeful) of these rifles and products; exceeding the maximum load recommendations; or for rifles on which our products have been installed.



213 Dennis St.
Athens, TN 37303
866.518.4181

21822 Hwy J46
Centerville, IA 52544
641.856.2624

www.Muzzleloaders.com