

# KRISS®

---

## OWNER'S MANUAL

---

### VECTOR .22LR

---

**Read the instructions and warnings in this manual carefully before using this firearm; do not discard this manual.**

This instruction manual should always accompany this firearm and be transferred with it upon ownership, or when the firearm is loaned or presented to another person.

# TABLE OF CONTENTS

---

Firearm Safety Rules .....	2
Package Contents .....	2
Main Features .....	3
Specifications .....	4
Handling and Operation .....	5
1. Ammunition .....	5
2. Loading the Magazine .....	5
3. Loading the Firearm.....	6
4. Shooting.....	7
5. Bolt Lock .....	8
6. Charging .....	8
7. Unloading and Clearing .....	9
8. Sight Adjustment.....	10
9. DS150 Stock.....	10
Maintenance .....	11
1. Disassembly .....	11
2. Cleaning and Inspection .....	13
a. Bolt .....	13
b. Break Down Pins .....	14
c. Upper Housing .....	14
d. Lower Housing .....	15
e. Barrel .....	16
3. Lubrication .....	17
a. Upper Housing/FCG .....	17
b. Receiver/Bolt .....	17
4. Assembly.....	18
5. Function Check.....	19
Troubleshooting .....	20
Lock, Storage, and Transportation .....	22
Components Diagram and List.....	23

# FIREARM SAFETY RULES

---



## SAFETY IS YOUR RESPONSIBILITY.

Below are some general guidelines you should follow closely when operating firearms or are in the company of those who are.

- Always treat your firearm as if it is loaded.
- Never point a firearm at anything you are not willing to destroy.
- Keep your finger off the trigger until you are ready to shoot.
- Always keep your firearm on safe until you intend to fire.
- Always keep your firearm unloaded until you intend to use it.
- Always know your target and what may lie behind it.
- Always become thoroughly familiar with your firearm before using it.
- Use only new, factory manufactured, SAAMI and/or C.I.P. approved ammunition that is the correct caliber for your KRISS Vector.
- Always wear proper eye and ear protection when you are around firearms.
- Be aware that certain types of firearms and firing situations require additional safety considerations.

## PACKAGE CONTENTS

---

- [1] KRISS Vector .22LR CRB / SBR
- [1] Magazine
- [1] Owner's manual
- [1] Cable lock

# MAIN FEATURES

## VECTOR .22LR SBR

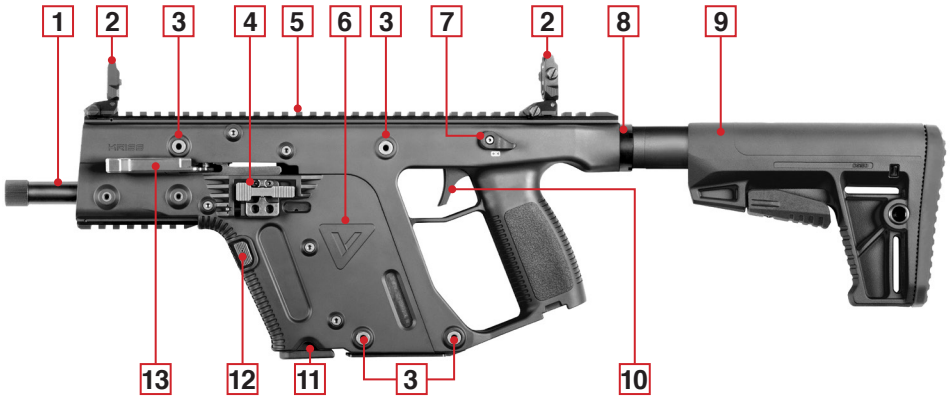

## VECTOR .22LR CRB



- |  |  |
|--|--|
| 1: 6.5" threaded barrel (1/2x28)               | 9: Fixed position DS150 stock                              |
| 2: Low profile flip-up sights                  | 10: Smooth pivoting trigger with audible and tactile reset |
| 3: 4-pin toolless disassembly                  | 11: KRISS Standard 10 rds Magazine                         |
| 4: Bolt release / catch                        | 12: Magazine release button                                |
| 5: Full length MIL-STD 1913 Picatinny top rail | 13: Charging handle / brass check function                 |
| 6: Direct blowback system                      | 14: 16" Threaded barrel (1/2x28)                           |
| 7: Ambidextrous short throw safety lever       | 15: M-LOK modular rail system                              |
| 8: Integrated M4 buffer tube adaptor           | 16: Adjustable DS150 stock                                 |

# SPECIFICATIONS

Model	SBR .22LR
Operating system	Direct blowback system
Caliber	.22LR
Thread pitch	1/2" x 28
Overall length	Collapsed: 25.0 in / 635.0 mm Extended: 28.1 in / 714.3 mm
Overall length (Fixed Stock)	26.2 in / 666.7 mm
Overall height	6.8 in / 172.7 mm
Weight (unloaded)	6.2 lb / 2.8 kg
Barrel length	6.5 in / 165.1 mm
Barrel twist	1:16 RH
Frame material	Advanced metal and polymer composite components
Magazine Capacity	10 rds
Optional magazine	30 rds

Model	CRB .22LR
Operating system	Direct blowback system
Caliber	.22LR
Thread pitch	1/2" x 28
Overall length	Collapsed: 34.5 in / 876.3 mm Extended: 37.7 in / 958.8 mm
Overall length (Fixed Stock)	35.7 in / 908.0 mm
Overall height	6.8 in / 172.7 mm
Weight (unloaded)	7.4 lbs / 3.3 kg
Barrel length	16.0 in / 406.4 mm
Barrel twist	1:16 RH
Frame material	Advanced metal and polymer composite components
Magazine Capacity	10 rds
Optional magazine	30 rds

All specifications subject to change.

# HANDLING AND OPERATION

---

## Ammunition

---

Use only new, factory manufactured, SAAMI and/or C.I.P. approved ammunition that is the correct caliber for your KRISS Vector.

Ensure that your ammunition is free of defects, dirt, debris, lubrication, or anything that may cause malfunctions.



**DO NOT use re-manufactured ammunition. Use of re-manufactured ammunition WILL void your warranty and may result in severe bodily injury and severe damage to your firearm.**

## Loading the Magazine

---



**Be sure to use the appropriate caliber of ammunition for your KRISS Vector .22LR. Failure to utilize the correct ammunition may result in a malfunction and could cause severe injury and/or death.**

1. With the bullet facing the front of the magazine, insert the rim of the case down into the follower.
2. Push the round to the rear of the magazine, underneath the magazine lips.
3. Repeat until the magazine is fully loaded.

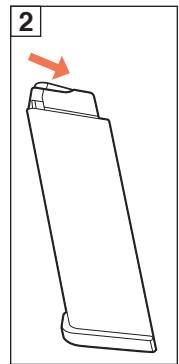
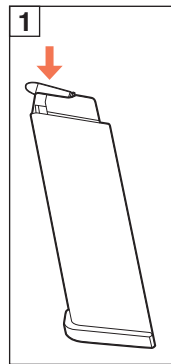

# HANDLING AND OPERATION

## Loading the Firearm



Ensure the firearm is placed on safe and pointed in a safe direction with your finger off the trigger.

**NOTE:** Always load the KRISS Vector .22LR with the bolt open.

1. Pull the charging handle back and press the bolt catch to lock the bolt open.
2. Place the magazine into the magazine well with the bullet head facing forward. Tap the magazine to ensure that it is securely in position and seated properly.
3. Release bolt to chamber a round.

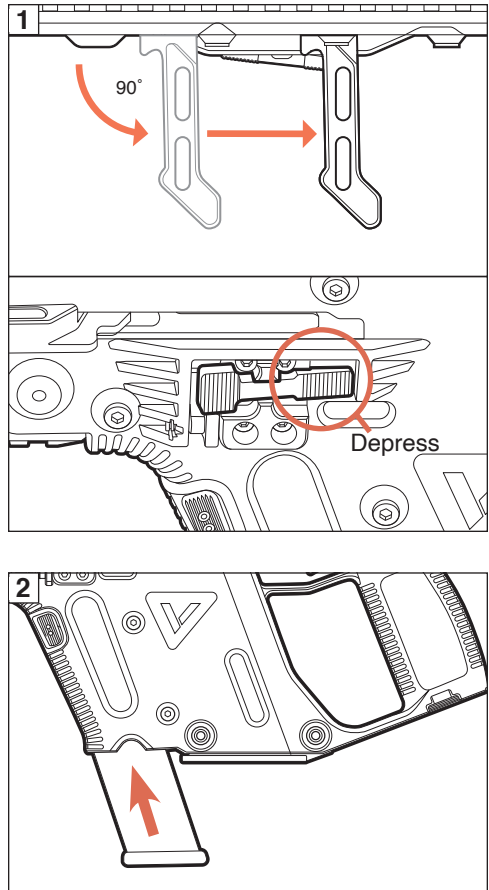

# HANDLING AND OPERATION

## Shooting



**ALWAYS** point the firearm in a safe direction.  
**ALWAYS** load the KRISS Vector with the bolt open.

1. Insert a loaded magazine, ensuring it positively locks into place. Depress the bolt release to chamber a round.
2. Aim the firearm at the target and take the firearm off safe.
3. Pull trigger rearward to fire.
4. Once firing has been completed, take your finger off the trigger and place the firearm back onto safe.

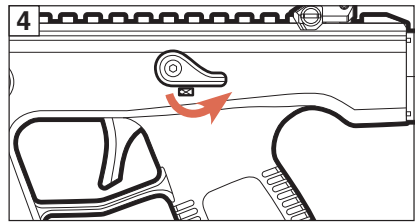
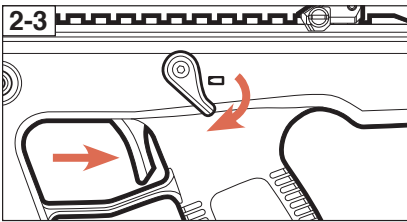
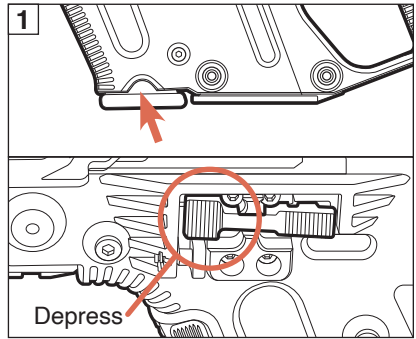

## Bolt Lock

When the magazine is fired until empty, the bolt will be engaged by the bolt catch, holding the bolt back in the retracted position.

### To continue firing

1. Replace the empty magazine with a loaded magazine.
2. Press the bolt release button to load the firearm.

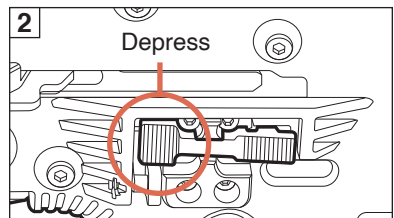
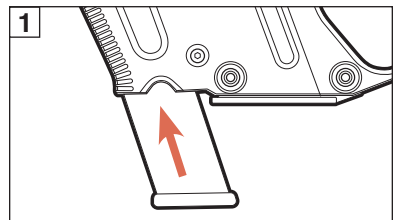



# HANDLING AND OPERATION

## Bolt Lock

### When firing is complete

1. Remove the magazine and press the bolt release to close the bolt.
2. Set firearm to safe.

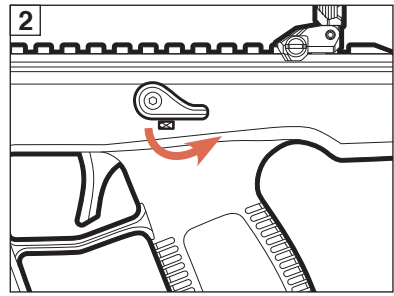
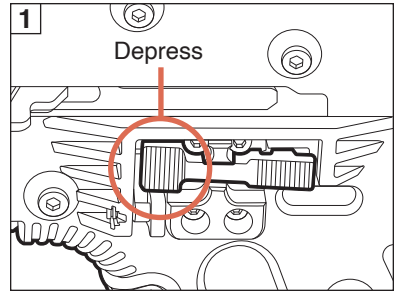

## Charging

1. Rotate the charging handle 90 degrees.
2. Grip the charging handle as close to the housing as possible, firmly pull the charging handle straight back.
3. Release the charging handle from its most rearward position.

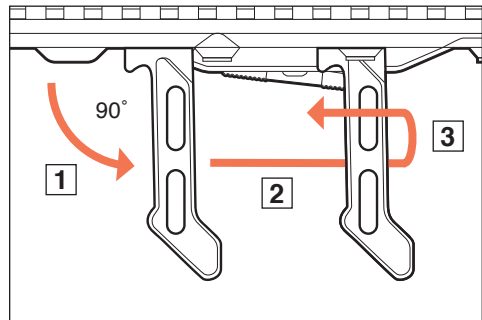

**Do not ease the charging handle forward, doing so can prevent the bolt from seating properly.**

# HANDLING AND OPERATION

## Unloading and Clearing

**NOTE:** When finished firing, ALWAYS place your finger outside the trigger guard with the barrel maintained in safe direction and activate the safety.

1. Switch the firearm to the safe position.
2. Press the magazine release to remove the magazine.
3. Rotate the charging handle 90 degrees. With two fingers as close to the housing as possible, pull the charging handle straight back, firmly, lock the bolt back, and then release the handle.
4. Visually inspect that there is no magazine inserted, and the chamber is clear of any ammunition.
5. Remove all ammunition from the magazine.

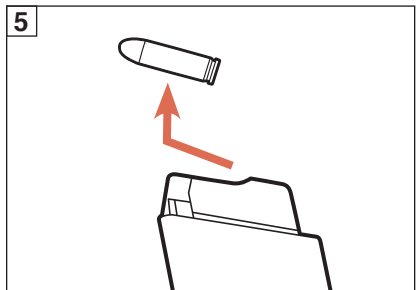
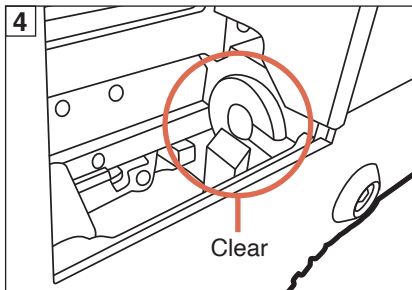
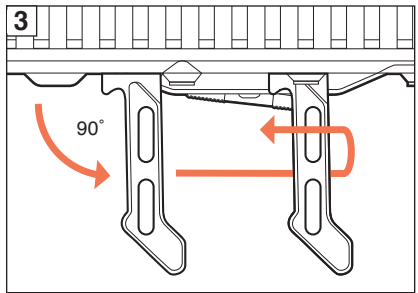
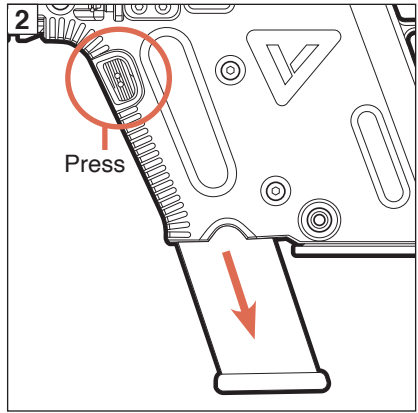
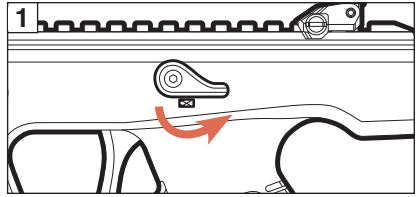

# HANDLING AND OPERATION

## Sight Adjustment

### Front sight

1. Flip up to deploy the front sight. Flip down to stow the front sight in the lowered position.
2. Turn the adjustment dial to move the front sight post. Turn the dial clockwise to lower the point of impact. Turn the dial counter-clockwise to raise the point of impact.

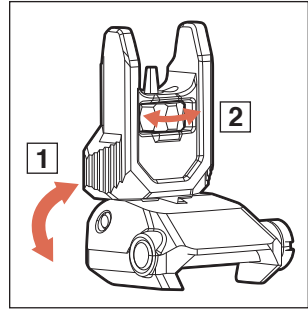

### Rear sight

1. Flip up to deploy the rear sight. Flip down to stow the rear sight in the lowered position.
2. Turn the adjustment knob to move the aperture. Turn the knob clockwise (indicated with an "R" and an arrow on surface of the knob) to move point of impact to the right. Turn the knob counter-clockwise to move point of impact to the left.

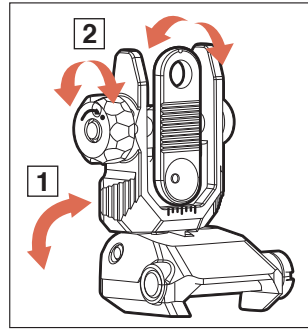

## Adjustable DS150 Stock

Press the stock adjustment latch to slide the stock into the desired position.

**NOTE:** The DS150 stocks on select Vector SBR .22LR models are fixed.

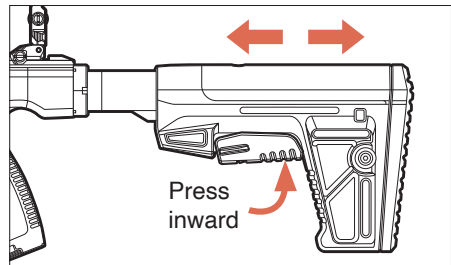

# MAINTENANCE

## Disassembly



Check to ensure that the magazine has been removed and that chamber is cleared. (See Unloading and Clearing section)

1. Pull the Charging handle back to reset the hammer. **Ensure the bolt is in battery prior to step 2.**
2. Remove the first 3 break down pins

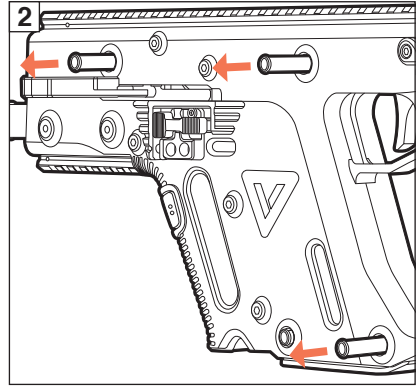
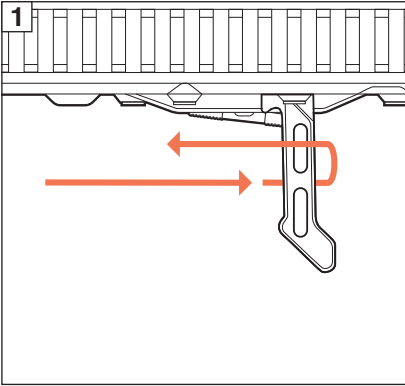

Do not release the hammer when the upper assembly has been separated from the receiver, doing so could cause damage to the ejection port.

3. Separate the housings by pulling straight up on the upper assembly and down on the receiver.

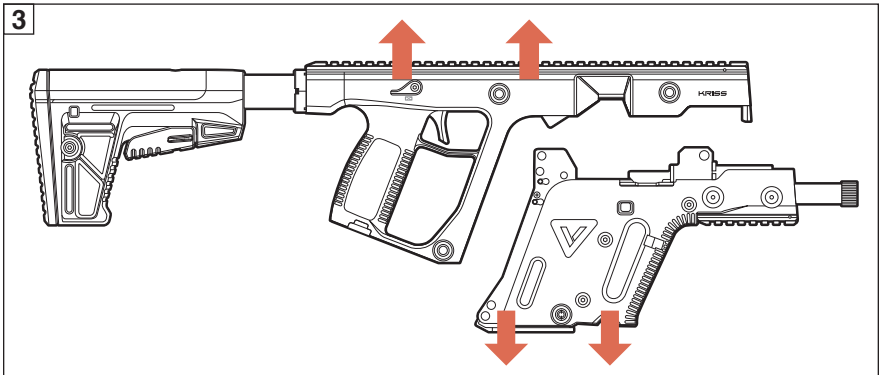

# MAINTENANCE

4. On the receiver, push the spring plate in to align the retaining pins.
5. Press the two retaining pins out, using a punch if necessary.
6. Remove the spring plate and the spring from the lower receiver.

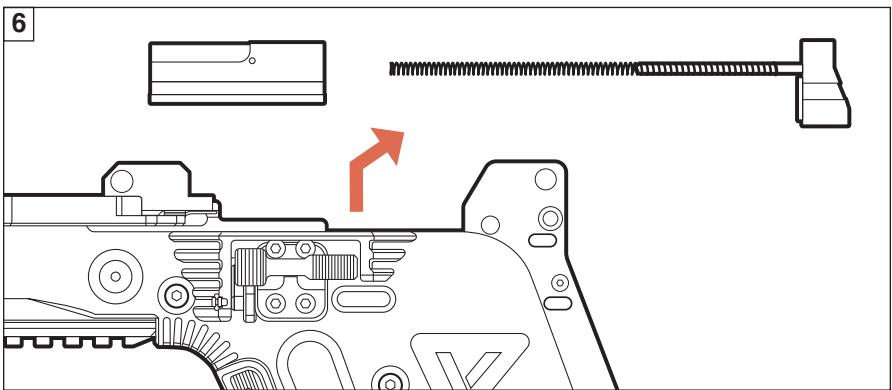
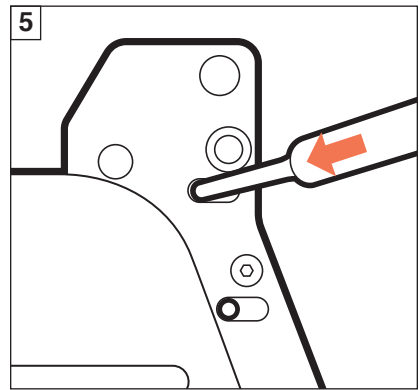
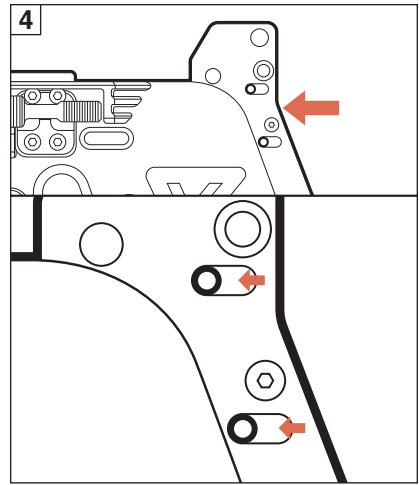

# MAINTENANCE

## Cleaning and Inspection

Your KRISS Vector is like any other firearm in that it requires routine cleaning and lubrication maintenance every time you fire it. Every time you clean your firearm, always inspect for wear and damage. Always clean and inspect your firearm if it was stored for a long period of time.

Depending upon the ammunition used and the conditions which you shoot, we recommend to wipe down the bolt and guide rails with a lint-free cloth and lightly lubricate with oil every 400 rounds. Clean more frequently when weapon is in humid and dusty environments. We recommend a complete teardown, cleaning and inspection at least every 1000 rounds.



**ALWAYS make sure your firearm is cleared before attempting any cleaning or maintenance.**

### BOLT

Ensure the bolt face is clean and free of carbon build-up. Be especially careful to inspect and remove any build-up under the extractor.

A. Fouling or build-up of carbon under the extractor may lead to poor extraction and poor chambering. Ensure that the extractor has no cracks or chips and that the extractor spring tension has not weakened. Check by pushing up on the forward (bolt face) end of the extractor with your thumb; it should only move slightly and require moderate force to move it at all.

B. Inspect the bolt face to ensure there is no scoring or other damage. Also ensure that the area surrounding the firing pin channel is clear of build-up.

C. Using a small amount of pressure, operate the firing pin by pushing it from the rear (wood dowel suggested) to ensure it moves freely and easily. Inspect the tip of the pin to ensure it is clear of build-up and free of any deformation.

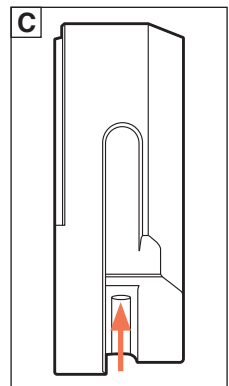
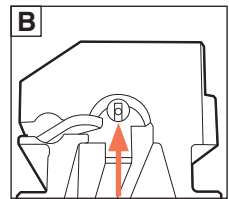
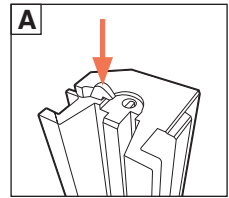

# MAINTENANCE

## Cleaning and Inspection

### BREAK DOWN PINS

Inspect the four break down pins to ensure they are undamaged. Clean each pin, paying particular attention to those that are used to secure the lower housing and receiver as these retain the operating mechanism.

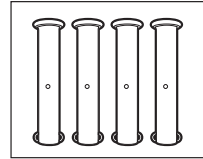

### UPPER HOUSING

To clean the upper housing, wipe it down using patches or a lint-free cloth. Use a cotton swab and/or a nylon bristle brush to reach and clean the Fire Control Group (FCG).

Other upper housing items to inspect:

- A. Ejection port mounting screws: make sure screws are tight.
- B. Ambidextrous F/S lever mounting screws: make sure screws are tight and there is a positive click as the lever is switched back and forth.
- C. FCG and frame: make sure FCG and frame is tight in the housing and debris-free.

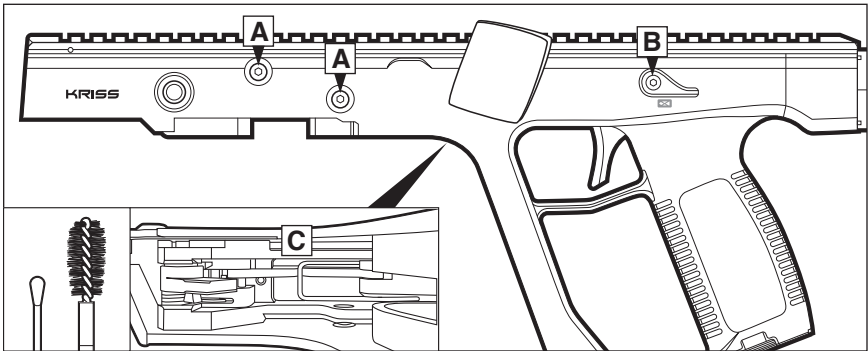

**Do not attempt to remove the FCG; there are no owner serviceable aspects to this assembly.**

# MAINTENANCE

---

## Cleaning and Inspection

---

### LOWER HOUSING & RECEIVER

Clean the lower housing and receiver as you would clean the upper housing.

Other lower housing items to inspect:

- A. Housing screws: make sure screws are tight.
- B. Bolt catch/release lever mounting block screws: make sure screws are tight.
- C. Charging handle: make sure handle moves freely and its two return springs are intact and clean.
- D. Mag release button: make sure button moves freely and area underneath is clear.
- E. Ejector: make sure ejector is not loose or bent.

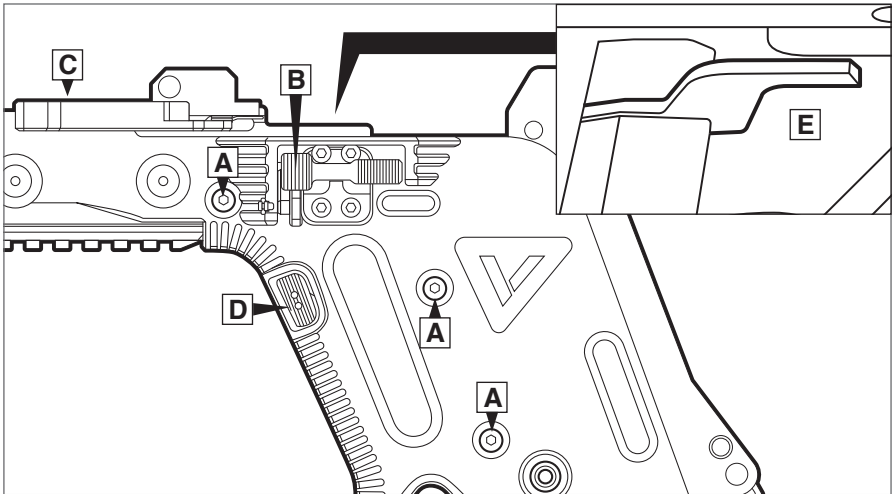



# MAINTENANCE

## Cleaning and Inspection

### BARREL

1. Insert cotton patch into eyelet attached to the bore cable and add firearms solvent (not included).
2. Feed the cable into the chamber and pull completely through the front of the barrel. Repeat 2-3 times using a newly saturated cotton swab each time.
3. Replace eyelet adaptor with brush adaptor. Feed the cable into the chamber and pull completely through the front of the barrel. Repeat 2-3 times.
4. Repeat Step 2 to clean up any fouling that was loosened by the brush.

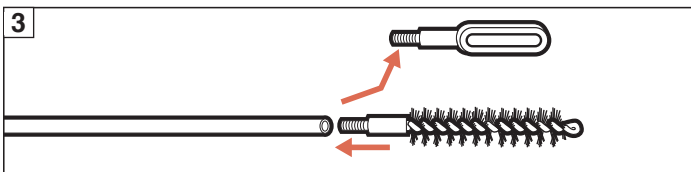
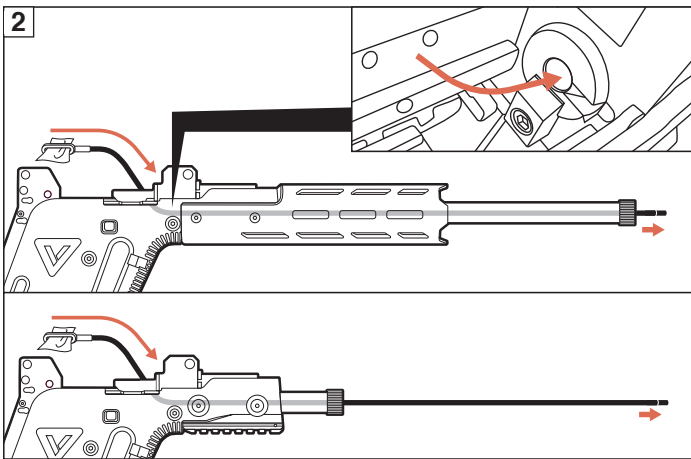
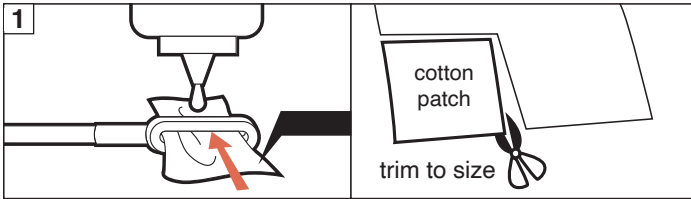

# MAINTENANCE

## Lubrication

The key to long life and proper function of your firearm is the use of quality lubricant. As with any firearm, it is recommended that all metal parts be lightly lubricated with oil before reassembly or storage in order to prevent corrosion.

### Upper Housing/FCG:



**DO NOT** remove the FCG from the Upper Housing.  
**DO NOT** release the hammer when the upper assembly has been separated from the receiver, doing so could cause damage to the ejection port.

- A. Place two drops of oil on the hammer and hammer pivot pin.
- B. Add one drop on the trigger pivot pin and operate the trigger and hammer several times so that the oil works its way into the moving parts of the FCG assembly.

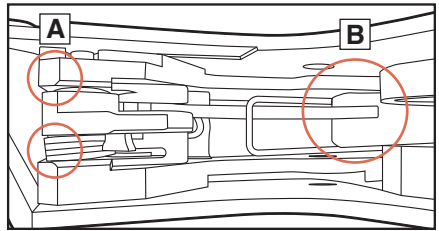

### Receiver / Bolt:

Lubricate as noted in the areas circled below:

- A. Two to three drops of oil in left and right guide rails.
- B. Thin coat of oil on bolt raceway, one drop of oil on the extractor.
- C. Two drops on the charging handle assembly. Cycle the action to ensure proper coverage.

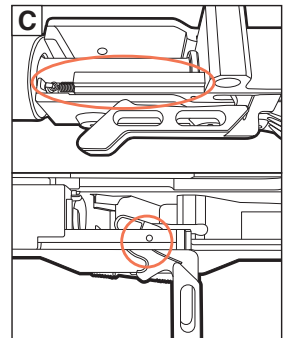
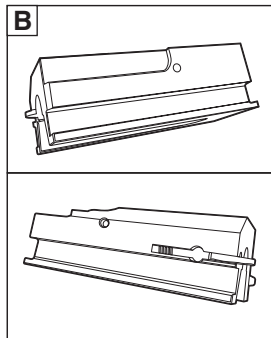
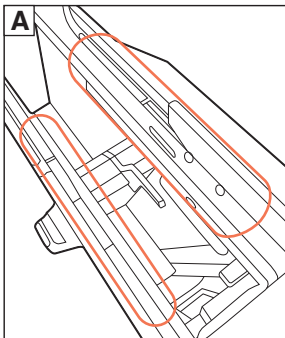

# MAINTENANCE

## Assembly



Ensure the bolt is oriented correctly and the bolt assembly is properly assembled before installing into the receiver.

1. Slide the bolt into the rear of the receiver.
2. Insert the spring into the bolt, and press the guide rod and spring plate into the rear of the receiver.
3. Align the hole on the spring plate with the front of the cutouts on the receiver and insert the retaining pins from right to left.
4. Ensure the spring plate returns fully to the rearward position.

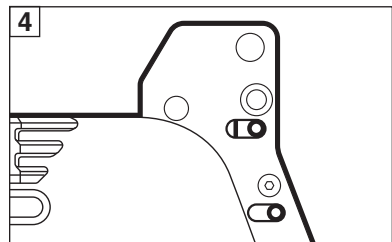
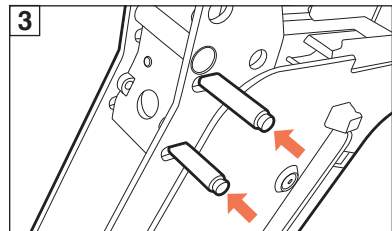
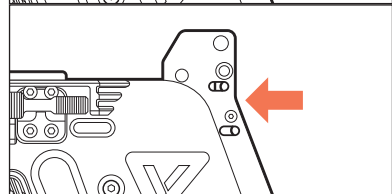
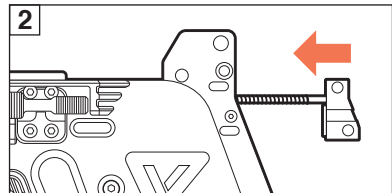
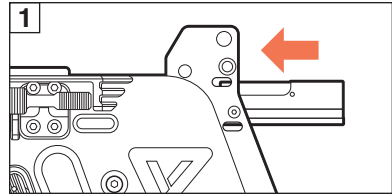

# MAINTENANCE

## Assembly

5. Ensure that the hammer is locked back, then mate the upper assembly to the receiver. Replace the break down pins to secure the firearm.
6. With the firearm pointed in a safe direction, perform a function check and test to ensure proper operation of the firearm.

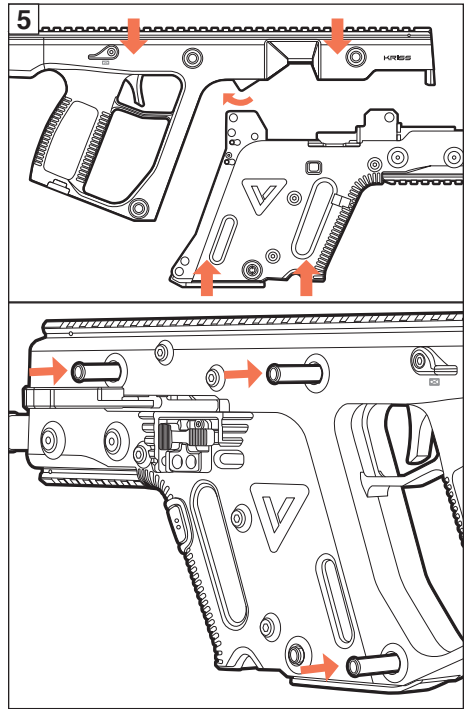

## FUNCTION CHECK

To perform a function check, ensure the magazine is removed and that the firearm is clear and unloaded. Pull back on the charging handle with the firearm pointed in a safe direction. With an empty chamber, pull the trigger to release the hammer. An audible sound of the hammer releasing and striking the firing pin should be heard.

In order to check the trigger reset, continue to hold down the trigger after the hammer has struck the firing pin. While holding the trigger down, charge the gun again and slowly release the trigger. There should be an audible click when the trigger resets. Repeat this step once more.

Finally, check that the Safety is operational. Place the gun on safe and attempt to pull the trigger. The Trigger should be locked and the hammer should not fall.

# TROUBLESHOOTING

The KRISS Vector has been designed to exacting standards and specifications to provide you with years of trouble free operation if properly cleaned, lubricated, and inspected. However, if you experience a problem, please refer to the suggestions below. If the problem persists, please contact your local KRISS Certified Dealer or contact KRISS USA at 1.855.KRISS.US (574.7787).

Fault and defect	
<p><b>Stoppage</b>                      Stoppages and malfunctions may occur for many reasons, or combination of reasons. Should a stoppage or malfunction occur when you are firing, immediately cease firing, place the firearm on safe, unload the firearm, and remove the magazine. Diagnose the problem before attempting to fire again. Some common causes for most stoppages and malfunctions are:</p>	
Possible cause	Solution
<p><b>Bolt not fully seated forward:</b></p>	<p>This stoppage can be caused by something as simple as dirty ammo, operating action, or by easing the bolt forward by hand. Immediately:</p> <ol style="list-style-type: none"> <li>1. Place the firearm on safe and point in a safe direction.</li> <li>2. Check the chamber to ensure no double feed has occurred. Remove the magazine and lock the bolt back if you see any fouled rounds. Clear any fouled rounds from the chamber. Reinsert the magazine or replace magazine if necessary.</li> <li>3. Charge the firearm to chamber a new round by operating the charging lever or releasing the bolt.</li> <li>4. Switch the firearm to fire, aim down range and attempt to fire.</li> </ol>
<p><b>Double feed:</b></p>	<p>This stoppage can be caused by a fouled chamber, a bad magazine, or dirty ammunition. Anytime two rounds enter the feed ramp or chamber, immediately:</p> <ol style="list-style-type: none"> <li>1. Place the firearm on safe and point it in a safe direction.</li> <li>2. Lock the bolt back and remove the magazine.</li> <li>3. Clear the fouled rounds.</li> <li>4. Check the magazine to ensure rounds are properly seated and are clean.</li> <li>5. Reinsert the magazine, release the bolt, switch the firearm off safe, and attempt to fire.</li> </ol>
<p><b>Reduced audible firing sound, smoke from the chamber or reduced recoil (squib round)</b></p> <p><b>Warning: Immediately cease firing should you experience any reduced audible report, reduced recoil or unusual smoking from the chamber when firing.</b></p>	<p>You may have a “squib” round situation in which a round does not fire completely due to a lack of propellant burn. The round may be lodged in the barrel causing a dangerous obstruction that, should another round be fired, may damage the firearm severely and cause potentially severe injury or death to the operator. Immediately:</p> <ol style="list-style-type: none"> <li>1. Place the firearm on safe and point it in a safe direction.</li> <li>2. Remove the magazine and eject or clear any remaining round from the chamber.</li> <li>3. Disassemble the firearm as instructed in the disassembly section.</li> <li>4. Visually inspect the barrel from the chamber end and run a cleaning rod through the barrel to ensure that there is no bullet stuck in the bore. If you find a bullet in the bore, take the firearm to your KRISS dealer to have it removed and inspected professionally. You may damage the barrel if you attempt to remove the bullet from the barrel yourself. Do not attempt to fire until the firearm has been thoroughly and professionally inspected.</li> </ol>

# TROUBLESHOOTING

## Other common problems/causes

Fault and defect	Possible causes
<b>Will not fire</b>	<ul style="list-style-type: none"> <li>i. Firearm is switched to safe</li> <li>ii. Fouled firing pin</li> <li>iii. Trigger failure to reset</li> <li>iv. Defective ammunition</li> </ul>
<b>Bolt failure to seat</b>	<ul style="list-style-type: none"> <li>i. Dirty bolt face</li> <li>ii. Dirty ammunition fouled chamber</li> <li>iii. Weak or failed mainspring</li> <li>iv. Easing the bolt forward by hand</li> </ul>
<b>Failure to feed or double feed</b>	<ul style="list-style-type: none"> <li>i. Dirty, defective, or unapproved ammunition fouled chamber</li> <li>ii. Fouled bolt face/extractor</li> <li>iii. Weak or failed mainspring</li> <li>iv. Dirty or fouled bolt/slider assembly and raceways</li> <li>v. Magazine dirty, defective, or failed to seat properly</li> <li>vi. Easing the bolt forward by hand</li> </ul>
<b>Failure to eject/extract (stovepipe)</b>	<ul style="list-style-type: none"> <li>i. Broken, chipped, worn, or fouled extractor or ejector</li> <li>ii. Weak extractor spring</li> <li>iii. Obstruction in ejection port</li> <li>iv. Dirty, defective, or unapproved ammunition</li> </ul>
<b>Bolt fails to lock after last round fired</b>	<ul style="list-style-type: none"> <li>i. Fouled, bent, broken, or loose bolt catch or bolt lock trigger/ lever</li> <li>ii. Faulty or improperly seated magazine</li> <li>iii. Dirty, fouled, or damage magazine</li> </ul>
<b>F/S selector binds</b>	<ul style="list-style-type: none"> <li>i. Fouled trigger mechanism</li> <li>ii. Poorly lubricated F/S selector mechanism</li> </ul>
<b>Magazine fails to seat/remain in firearm</b>	<ul style="list-style-type: none"> <li>i. Not fully seated; push firmly</li> <li>ii. Faulty or worn magazine</li> <li>iii. Non-GLOCK magazine used</li> <li>iv. Worn magazine release button, catch, or spring</li> <li>v. *Note lock bolt to rear prior to inserting magazine</li> </ul>
<b>Trigger failure to reset</b>	<ul style="list-style-type: none"> <li>i. Weak primary sear return spring</li> <li>ii. Dirty or fouled trigger mechanism or FCG</li> <li>iii. Damaged or broken hammer spring</li> </ul>

# LOCK, STORAGE, AND TRANSPORTATION

---

## Lock

---

The KRISS Vector comes equipped with a custom cable lock that will satisfy all requirements for locking a firearm safely. Use of this lock does not override the requirement to always observe firearm safety procedures. However, it is your responsibility to know and comply with any State or Local regulations and restrictions that may affect how firearms must be stored where you live. KRISS USA recommends to always store your firearm unloaded, preferably locked and safe.

## Storage

---

**ALWAYS** clean and lubricate your KRISS Vector before storing it for any length of time in order to prevent corrosion (see Maintenance section). Thoroughly inspect your firearm after removing it from storage and before firing it. Corrosion can impair functionality of important safety features and create a safety risk if you fail to inspect, re-clean, and re-lubricate your firearm before firing.

## Transportation

---

Transporting a firearm covers a wide and often confusing variety of Federal, State, and Local laws covering what you can and cannot do while traveling with your firearm. We believe the following websites can assist you in learning what the Federal requirements and restrictions are. For your State and Local regulations, we suggest you check with your local LE unit and your local KRISS Certified Dealer for assistance.

<http://www.tsa.gov/>

<http://www.tsa.gov/traveler-information>

<http://www.atf.gov/>

<http://www.atf.gov/content/firearms>

# COMPONENTS DIAGRAM : VECTOR 22 SBR

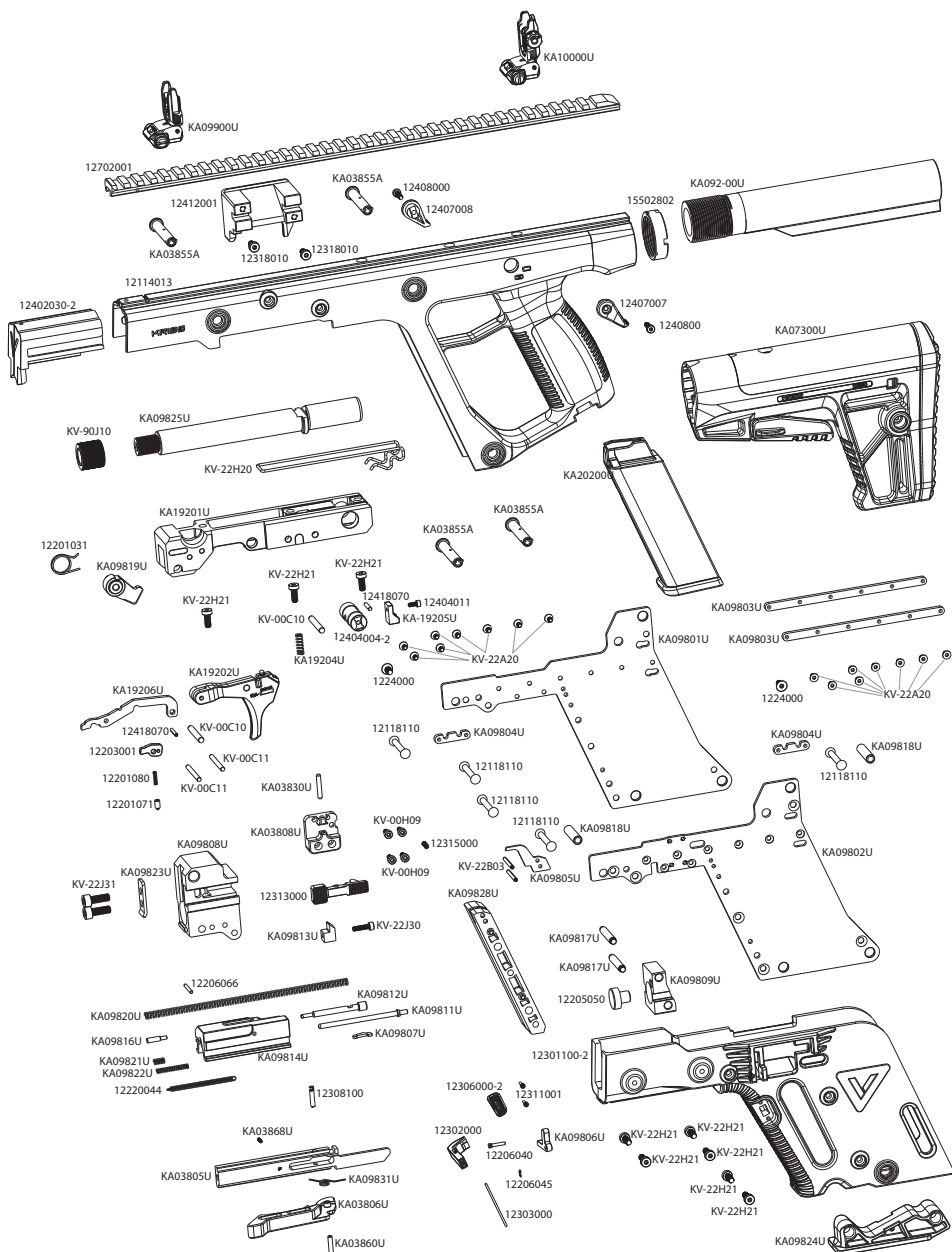



# COMPONENTS LIST : VECTOR 22 SBR

12114013	KV Upper Housing - Semi Gen 3	KA09803U	Guide Plate
12201031	KV Square Hammer Spring	KA09804U	Magazine Retainer
12201071	Machined Plunger	KA09805U	KV .22 Ejector
12201080	KV Disconnect Spring Semi	KA09806U	KV .22 Bolt Lock Trigger
12203001	Disconnect Semi	KA09807U	KV .22 Extractor
12205050	Vector Slider Buffer	KA09808U	KV .22 Trunnion
12206040	KV Bolt Lock Trigger Pin	KA09809U	Spring Plate
12206045	KV E-Clip	KA09811U	Spring Guide
12206066	KV .22 Firing Pin Retaining Pin	KA09812U	KV .22 Firing Pin
12218110	KV Reciever Plate Rivets	KA09813U	Feed Ramp
12220044	Charging Slider Spring	KA09814U	KV .22 Bolt
12224000	KV Short Reciever Screw	KA09816U	KV .22 Extractor Plunger
12302000	KV Vector Magazine Catch Gen 2	KA09817U	Spring Plate Retaining Pins
12303000	KV Mag Catch Spring	KA09818U	KV .22 Reciever Spacer
12308100	KV Charging Slider Spring Anchor	KA09819U	KV .22 Hammer
12311001	KV Mag Catch Screw	KA09820U	Recoil Spring
12313000	KV Bolt Lock	KA09821U	KV .22 Extractor Spring
12315000	KV Bolt Lock Spring	KA09822U	KV .22 Firing Pin Spring
12318010	KV FCG Mounting Screw	KA09823U	Barrel Clamp
12401020	KV Rail Retaining Pin	KA09824U	Base Plate
12404011	KV Safety Cam Screw Gen 2	KA09825U	KV .22LR 6.5" Barrel Threaded
12407007	KV LH Selector Lever Short	KA09828U	KV .22 Ejector Mount
12407008	KV RH Selector Lever Short	KA09831U	Charging Handle Spring
12408000	KV Selector Screw	KA09900U	Defiance Polymer Front Flip-up Sight
12412001	KV Ejection Port 45ACP	KA10000U	Defiance Polymer Rear Flip-up Sight
12418070	KV Trigger Sear Connector Pin	KA19201U	KV Plastic FCG Frame - Semi
12504015	KV Large Flange Rivet	KA19202U	KV Pivoting Plastic Trigger
12702001	KV Long Picatinny Rail Gen 3	KA19204U	KV Trigger Return Spring Spring
12301100-2	KV Lower Housing A Gen 2	KA19205U	KV Plastic Safety Stop Bar
12306000-2	KV Mag Catch Button Gen 2	KA19206U	KV Pivoting Primary Sear
12319000-2	KV Short Picatinny Rail Gen2	KA20200U	KV .22LR Magazine 10 RD
12402030-2	KV Nose Piece Gen 2	KV-00C10	KV Large Pivot Pin
12404004-2	KV Safety Cam Gen 2	KV-00C11	KV Small Pivot Pin
15502802	Buffer Ring	KV-00C15	M4x10 SCREW
KA03805U	Chargin Slider	KV-00H09	KV 22 Bolt Lock Mounting Screw
KA03806U	Charging Handle	KV-22A20	Guide Plate Screws
KA03808U	Die Cast Bolt Lock Block	KV-22B03	Ejector Retaining Pins
KA03830U	Bolt Lock Pin	KV-22H20	Sear Spring
KA03855A	Push Pin Assembly	KV-22H21	KV 22 Long Mounting Screw
KA03860U	Charging Handle Pin	KV-22J30	Feed Ramp Screw
KA03868U	Retainer Pin	KV-22J31	Clamp Screws
KA07300U	Defiance AR Stock DS150	KV-90J10	KV 9mm Thread Protector
KA092-00U	Defiance 22 M4 Buffer Tube	PRB	
KA09801U	.22 Receiver Plate Right	10540000A	M3 x 4mm Set Screw
KA09802U	.22 Reciever Plate Left		

# COMPONENTS DIAGRAM : VECTOR 22 CRB

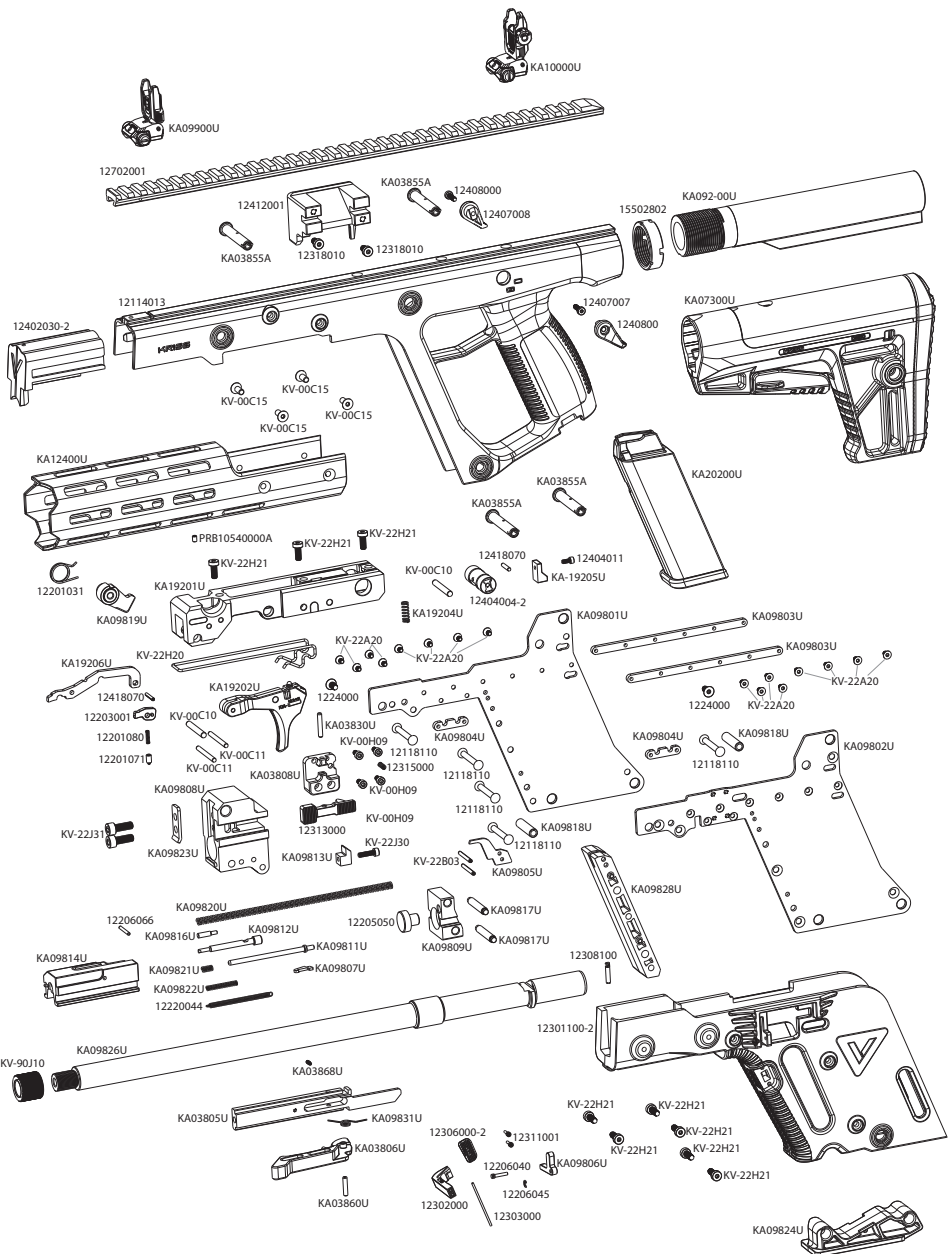

# COMPONENTS LIST : VECTOR 22 CRB

12114013	KV Upper Housing - Semi Gen 3	KA09803U	Guide Plate
12201031	KV Square Hammer Spring	KA09804U	Magazine Retainer
12201071	Machined Plunger	KA09805U	KV .22 Ejector
12201080	KV Disconnect Spring Semi	KA09806U	KV .22 Bolt Lock Trigger
12203001	Disconnect Semi	KA09807U	KV .22 Extractor
12205050	Vector Slider Buffer	KA09808U	KV .22 Trunnion
12206040	KV Bolt Lock Trigger Pin	KA09809U	Spring Plate
12206045	KV E-Clip	KA09811U	Spring Guide
12206066	KV .22 Firing Pin Retaining Pin	KA09812U	KV .22 Firing Pin
12218110	KV Reciever Plate Rivets	KA09813U	Feed Ramp
12220044	Charging Slider Spring	KA09814U	KV .22 Bolt
12224000	KV Short Reciever Screw	KA09816U	KV .22 Extractor Plunger
12302000	KV Vector Magazine Catch Gen 2	KA09817U	Spring Plate Retaining Pins
12303000	KV Mag Catch Spring	KA09818U	KV .22 Reciever Spacer
12308100	KV Charging Slider Spring Anchor	KA09819U	KV .22 Hammer
12311001	KV Mag Catch Screw	KA09820U	Recoil Spring
12313000	KV Bolt Lock	KA09821U	KV .22 Extractor Spring
12315000	KV Bolt Lock Spring	KA09822U	KV .22 Firing Pin Spring
12318010	KV FCG Mounting Screw	KA09823U	Barrel Clamp
12401020	KV Rail Retaining Pin	KA09824U	Base Plate
12404011	KV Safety Cam Screw Gen 2	KA09826U	KV .22LR 16" Barrel Threaded
12407007	KV LH Selector Lever Short	KA09828U	KV .22 Ejector Mount
12407008	KV RH Selector Lever Short	KA09831U	Charging Handle Spring
12408000	KV Selector Screw	KA09900U	Defiance Polymer Front Flip-up Sight
12412001	KV Ejection Port 45ACP	KA10000U	Defiance Polymer Rear Flip-up Sight
12418070	KV Trigger Sear Connector Pin	KA12400U	Vector M-Lock Rail
12702001	KV Long Picatinny Rail Gen 3	KA19201U	KV Plastic FCG Frame - Semi
12301100-2	KV Lower Housing A Gen 2	KA19202U	KV Pivoting Plastic Trigger
12306000-2	KV Mag Catch Button Gen 2	KA19204U	KV Trigger Return Spring Spring
12319000-2	KV Short Picatinny Rail Gen2	KA19205U	KV Plastic Safety Stop Bar
12402030-2	KV Nose Piece Gen 2	KA19206U	KV Pivoting Primary Sear
12404004-2	KV Safety Cam Gen 2	KA20200U	KV .22LR Magazine 10 RD
15502802	Buffer Ring	KV-00C10	KV Large Pivot Pin
KA03805U	Chargin Slider	KV-00C11	KV Small Pivot Pin
KA03806A	Charging Handle Die Cast Assembly	KV-00H09	KV 22 Bolt Lock Mounting Screw
KA03808U	Die Cast Bolt Lock Block	KV-22A20	Guide Plate Screws
KA03830U	Bolt Lock Pin	KV-22B03	Ejector Retaining Pins
KA03855A	Push Pin Assembly	KV-22H20	Sear Spring
KA03868U	Retainer Pin	KV-22H21	KV 22 Long Mounting Screw
KA07300U	Defiance AR Stock DS150	KV-22J30	Feed Ramp Screw
KA092-00U	Defiance 22 M4 Buffer Tube	KV-22J31	Clamp Screws
KA09801U	.22 Receiver Plate Right	KV-90J10	KV 9mm Thread Protector
KA09802U	.22 Reciever Plate Left	PRB 10540000A	M3 x 4mm Set Screw

