



*Youth
Archery*

APPRENTICE

Owner's Manual



*Actual model may differ in color and features.

2200 Stringtown Rd.
Evansville, IN 47711
800 - 694 - 9494
fax 812 - 467 - 1245
www.BearArchery.com

©2020 Bear Archery
2L-7899-00

INDEX

Section A	Safety Tips.....	pg. 3
Section B	Bow Preparation.....	pg. 4
Section C	Shooting Tips.....	pg. 5
Section D	Replacing Strings.....	pg. 6
Section E	Maintenance.....	pg. 7
Section F	Parts List/Anatomy.....	pg. 8
Section G	Warranty Information.....	pg. 9

WARNING

Safety Tips:

1. Never shoot the bow without an arrow in it. This is called dry firing and may damage the bow, or cause injury to you.
2. Keep bow pointed in a safe direction away from persons or anything you do not want to damage
3. Be careful with loose clothing, hooded strings, hair, earrings and bracelets. They can get caught in the bow string while shooting.
4. The elbow of the hand holding the bow needs to be kept bent so that it does not get hit by the bow string while shooting. The string hitting the arm can cause bruising or skin irritation. See pictures below.

WARNING

This product is not a toy. Shooting arrows at humans or animals could result in death or serious injury. Children under 16 require supervision. It is recommended that safety glasses be worn while shooting arrows.

CHOKING HAZARD-Small parts.
Not for children under 3 years.

Picture 1. Shows correct elbow position.

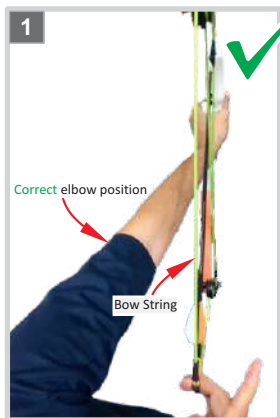

Picture 2. Shows improper Elbow Position – with elbow positioned as shown you can get hit by the bow string causing bruising.

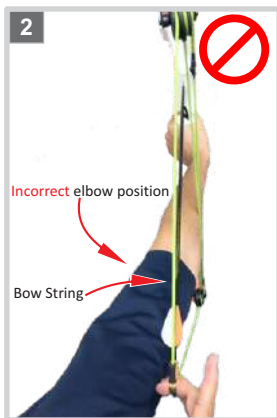

Section B – Bow Preparation

1. The arrow rest needs to be attached before shooting your bow. See **Detail B1**.
 - a. The rest comes with an adhesive back, remove backing before attaching.
 - b. Attach rest as shown in the picture below, with bent part on the lower half of the rest.



Section C – Shooting Tips

1. Make sure the arrow knock clips tightly on the string. See **Detail C1**.
2. Odd color arrow fletching/feather needs to be away from the bow on the arrow rest. See **Detail C2**.

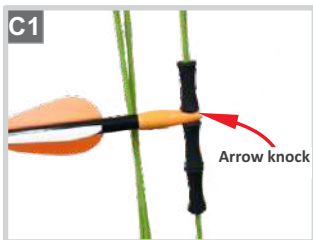

3. The finger rollers need to be placed in the following locations. See **Detail C3**.
 - a. 1 finger roller above the arrow
 - b. 2 finger rollers below the arrow
 - c. 2 Pullback using the 2 finger rollers below the arrow.

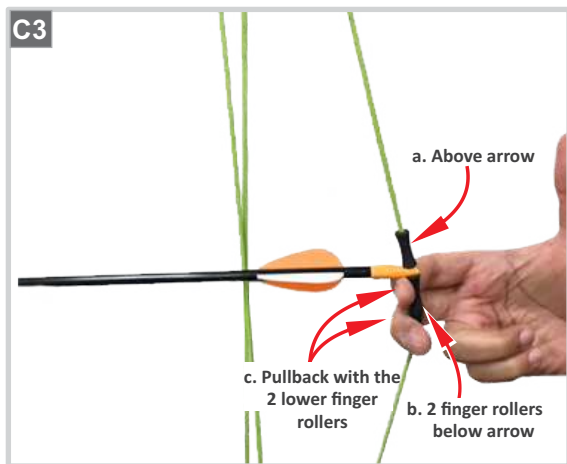

Section D - Replacing the string

1. Remove the E-clips from the right sides of both the top and bottom axles.
2. Slide the top axle partially out, so that the old string loop can be removed from the axle thimble. Attach either end of the new string on the axle thimble, then push the axle back into place and secure with previously removed E-clip.
3. Continue to remove the old string out of the cams until it is only secured by the end loop on the bottom axle thimble.
4. Take the new string that is now secured in place on the top axle thimble and wrap the string on the front edge of the small track on the right side of the cam. There is a slot at the bottom of that track. Allow the string to follow that track and come out to the left side of the cam. The metal nock on the string should lie in the through hole of the cam.
5. Once through the cam, let the string follow the slot on the left side of the cam. Then wrap the string around the large track that the slot leads into counter clockwise, so that the string comes off the back side of the cam closest to the user.
6. Continue the string straight up to the top cam. Allow the string to wrap around the large left track starting on the back side closest to the user, then follow in the slot and through the center hole so the string comes out to the other side.
7. From the other side, allow the string to follow that side's slot, then turn the string downward so that the string rests in part of the track of the front side of the cam, closest to the riser. The metal nock on the string should lie in the through hole of the cam.
8. From there, slide the bottom axle partially out, so that the old string loop can be removed from the bottom axle thimble. Attach the new string loop to the axle thimble. Once attached, push the axle back into place and secure with the previously removed E-clip.



General Maintenance:

1. General

- Check for worn or loose parts before use.

2. String

- Replace immediately any worn strings or frayed strings.
- To change the strings follows steps as described in **Section D**.

3. Storage

- Never store the bow in a hot area, such as an attic, car trunk or next to heat source – long term exposure will damage your bow.
- Also, storing it in a humid location may cause some parts to rust.

4. Bolts and Screws

- Do not loosen limb bolts to relieve string pressure when not in use.

5. Questions

- For questions contact the Customer Service Department at 1-800-694-9494.

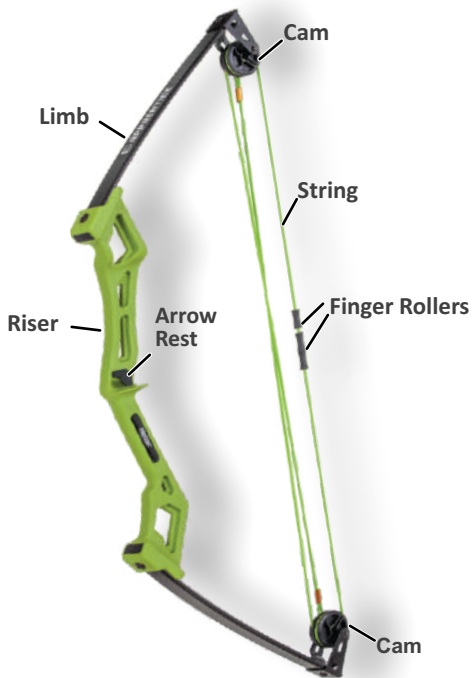

Parts List:

Apprentice Bow

Accessories:

Safety Glass Arrows (2)

Arrow Rest

Finger Tab

Target

BEAR ARCHERY WARRANTY STATEMENT

All Bear Archery compound bows are backed with a Limited Lifetime Warranty to the original owner. This warranty applies to limbs, risers, and cams. This warranty consists of the following programs:

Limbs: 100% covered at no charge for the first 5 years, 50% of replacement cost after.

- Risers: Lifetime Warranty.
- Cams: Lifetime Warranty.

Original Owner

Warranty applies only to the original owner and is not transferable. Proof of purchase may be required.

Items Not Covered

Cables, strings, bearings, paint and/or film dipped finishes resulting from normal wear and tear are not included in this warranty.

Damage Not Covered

Damage caused by abuse, mishandling, dry firing, alteration or modification made to original products are not covered under this warranty. The use of any bow press other than those approved by Bear Archery will void this warranty. Additionally, shooting of arrows less than 5 grains per pound of peak draw weight will void this warranty. Bear Archery reserves the right to make parts substitutions on warranty coverage at Bear Archery's sole discretion, for any reason.

Bow Warranty Registration

For this warranty to be in effect, the on-line warranty registration process must be completed at BearArchery.com and submitted within 30 days of purchase.

Traditional Bows

1 year Limited Warranty to the original owner.

Youth Bows

90 Day Limited Warranty to the original owner.

In the event a bow requires warranty service, please contact the Bear Archery Customer Department at 800-694-9494 for a return authorization (RA) number and return shipping instructions. For full warranty details, please log on to BearArcheryProducts.com for further information.