



View Cart | Checkout Items

Search bar with 'Sea' button

Home | M6 TAKEDOWN | About Us | Login | Order Status | Warranty | Contact Us

Shop by Category

AR-15 Lower Receiver Parts

- Factory Seconds/Blems
- Fire Control Parts
- Individual Parts
- Parts Kits
- Pins
- Springs
- Trigger Guards

M6 Scout Rifle Parts

- Individual Parts
- M6 Springs

M6 Takedown Rifle

- Choke Tubes
- Individual Parts
- M6 Technical info

Search Products

Search input field with GO button

Shopping Cart

Your cart is empty.

Account Login

Email Address:

Password:

You will be prompted to enter your password on the next page

GO

Create an account
Forgot Password?

Homepage > manuals

M6 TAKEDOWN Series User Guide



M6 TAKEDOWN GUN
USER GUIDE
.22 LR or .22 WMR/.410 GAUGE 3"



IMPORTANT SAFETY AND OPERATING INFORMATION INSIDE
The owner is responsible for reading this user guide before handling this firearm.

INDEX

SAFETY RULES.....4

SAFETY RULES.....5

FEATURES AND IDENTIFICATION.....6

LOADING.....7

HAMMER POSITION AND BARREL SELECTION.....8

COCKING AND FIRING.....9

UNCOCKING AND SAFE POSITION.....10

UNLOADING AND DISASSEMBLY.....11

TAKEDOWN PROCEDURE.....12

STOCK COVER AND STORAGE.....13

~ 2 ~

CHOKE TUBE.....	14
GUN LOCK.....	15
PARTS LIST (STOCK ASSEMBLY).....	16
PARTS DIAGRAM.....	17
PARTS LIST (BARREL ASSEMBLY).....	18
AMMUNITION AND WARRANTY.....	19

M6 TAKEDOWN RIFLE



~ 3 ~

Safety rules for being a responsible gun owner

- Receive proper firearms instruction and training before use.
- Never point a gun at any person or thing you do not intend to shoot; always keep the muzzle pointed in a safe direction.
- Before any live fire scenario, it is recommended to rehearse the functioning of the gun with dummy ammunition to ensure you are comfortable with the safe handling and use. Do not dry fire.
- Always keep unloaded when not in use.
- Load gun only when on range and prepared to fire; unload before leaving range.
- Always keep the safety on when the gun is loaded and cocked until you are ready to fire to avoid unintentional fire.
- Do not rely on the safety to protect you from unsafe handling of the gun.
- Keep your finger off the trigger and out of the trigger guard until you are aiming at the target and prepared to fire.
- Keep the barrel clear of obstructions and debris such as snow, mud, water and excessive oil and grease. If anything does get in the barrel, remove any cartridges and clean the bore before shooting. Obstructed barrels can burst and cause serious injury.
- Be sure of your target and backstop before shooting. Spectators should always be at least 10 feet behind you.
- Wear protective shooting glasses and hearing protection at all times.

~ 4 ~

Safety rules for being a responsible gun owner

- Use clean, dry, high quality factory ammunition and only use the correct size ammunition for the gun.
- Do not drop the gun or leave it in a place where it could fall and accidentally fire. If it does fall, unload it and check to make sure it will work correctly before firing.
- Always control the direction of the muzzle.
- Always unload the gun before storage, transportation or handing to someone else.
- Be sure the gun is unloaded before cleaning.
- If you pull the trigger and the gun fails to fire, keep it pointed at target for 30 seconds before removing the cartridge. Slow primer ammunition may cause a 'hang fire' and the cartridge may fire after a short pause.
- When you pull the trigger, always expect it to fire and you must take responsibility for firing it.
- Do not alter or modify the gun, including disassembling the safety or changing the trigger pull.
- Have the gun serviced by a qualified gunsmith.
- Always store guns and ammunition in a locked location and out of the reach of children.
- Do not use a firearm if you are under the influence of alcohol or drugs.

Contact TPS Arms, LLC if you have any questions or concerns regarding the safe handling and use of this product.

~ 5 ~

M6 Takedown Features

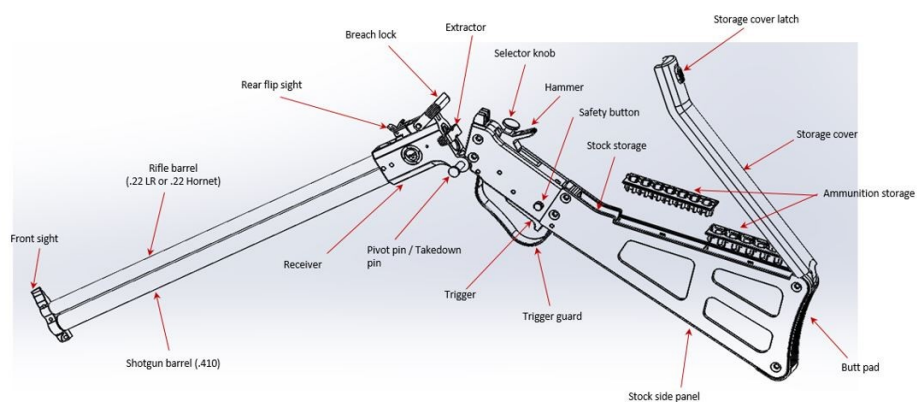

~ 6 ~

Loading the M6

1. Make sure hammer is in neutral position and safety is on.
2. Grasp the barrel group in left hand and stock group in right hand.
3. Lift breach lock with right thumb.
4. Rotate groups down around pivot pin, being certain fingers of left hand are far enough down the barrel to clear trigger guard as stock is lowered until guard comes in contact with barrel group.

Opening the gun:

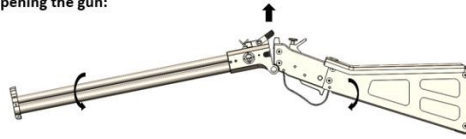

4. Lift cartridge box cover, select cartridge or shell from box and insert in respective chamber with rim resting on extractor.
5. Close cartridge box cover.
6. With muzzle pointing in safe direction, close action by slowly rotating barrel group upward until breech lock snaps into locked position.

~ 7 ~

M6 Hammer Position and Barrel Selection

1. To activate upper barrel (.22 LR or .22 WMR) pull knob up until it stops.
2. To put gun in neutral push down or pull up to middle position (in this position the striker will be between firing pins)
3. To activate lower barrel (.410-3" shotgun) push knob down until it stops.

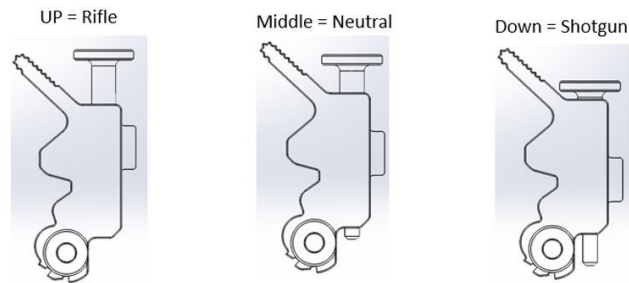

~ 8 ~

Cocking and Firing

How to place hammer in firing position

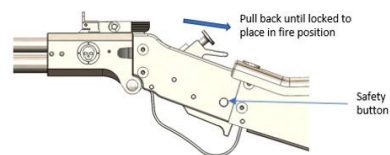

1. **WARNING:** Only cock the hammer when you are ready and intend to fire.
2. When hammer is in the farthest forward position, with the selector knob in neutral position and safety in fire position, grasp hammer with thumb.
3. Move hammer rearward as indicated in figure above until hammer is locked back. Gun is now in firing position.
4. Safety is moved to on and selector knob is now moved to the chosen caliber position. During this operation, do not apply pressure to trigger.
5. To fire gun, push safety to fire position, insert finger(s) inside trigger guard and gently squeeze trigger with finger(s).
6. If the gun fails to fire, recock and make one additional attempt to fire. If it still does not fire, wait 30 seconds before attempting to remove the round.
7. Removal of the trigger guard creates an unsafe condition! **DO NOT REMOVE THE TRIGGER GUARD!**

~ 9 ~

Uncocking and Safe Position

Point the gun in a safe direction.

To uncock the gun when the hammer is in the firing position:

1. Place selector knob at Neutral, depress safety (fire position).
2. Pull hammer fully back and firmly hold with thumb.
3. Depress trigger and, by using thumb, allow hammer to slowly move forward to uncocked and SAFE position. Depress safety to safe position.

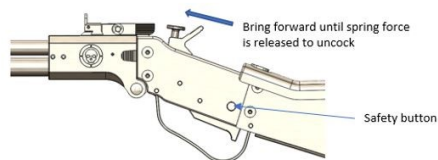

To prevent accidental discharge, keep gun uncocked in NEUTRAL position and safety on when not firing.

~ 10 ~

Unloading & Disassembly

Unloading:

Point gun in safe direction.

If cocked, place selector knob in SAFE position and lower hammer.

1. Grasp barrel group in left hand and stock group in right hand.
2. Lift breach lock with right thumb.
3. Rotate the groups down around pivot pin, being certain fingers of left hand are far enough down barrel to clear trigger guard as stock is lowered until trigger guard comes in contact with barrel group.
4. Extractor will lift cartridge case(s) partially from barrel.
5. Remove cartridge case(s) completely from barrel.

Disassembly: In the event the barrel group and stock group need to be separated, this can be done by opening the gun and removing the pivot pin. To reassemble, align pivot pin holes in stock and barrel groups, insert pivot pin and close action. Do not use any pin other than an original TPS Arms, LLC pivot pin.

NOTE: If fired case jams in barrel and extractor fails to lift it, pull extractor out, using extractor wings on either side of receiver. Any further disassembly should be done by TPS Arms, LLC or a qualified gunsmith.

Always point gun in safe direction when unloading. Be sure the chambers are empty to ensure the gun is unloaded.

~ 11 ~

Takedown

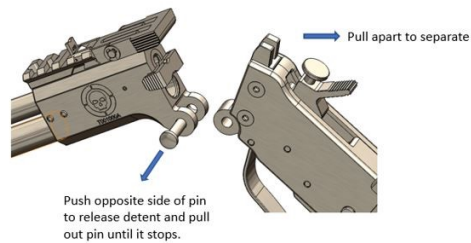

In the event the barrel group and stock group need to be separated, this can be done by opening the gun and pulling out the pivot pin until it stops and pulling apart to separate.

To reassemble, align pivot pin holes in stock and barrel groups, push in pivot pin and close action. Any further disassembly should be done by TPS Arms, LLC or qualified gunsmith.

Use factory supplied pivot pins and detent only. Do not use any pin other than a TPS Arms, LLC pivot quick pin.

~ 12 ~

STOCK COVER AND STORAGE

Opening cover

1. Pull back on lock button
2. Lift cover and rotate to expose storage compartments.

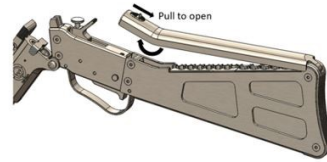

Storage

1. Shell holders are removable and allow you to choose configuration.
2. There is storage underneath shell holders.
3. Additional storage compartment in front of shell storage.

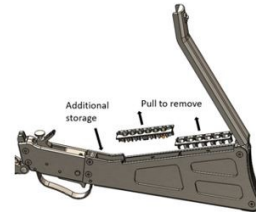

~ 13 ~

Choke Tube

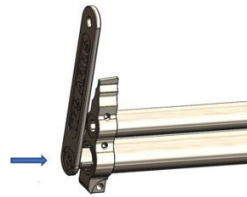

Place supplied M6 multi-tool into choke aligning 4 ribs with 4 slots

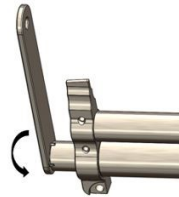

- Rotate clockwise to tighten
- Rotate counter clockwise to loosen.

TPS Arms Choke Tube Chart

Full Choke - 1 groove	
Modified Choke - 3 grooves	
Improved Choke - 4 grooves	

Use factory supplied choke tube wrench only.

Firearm must be unloaded when inserting or removing the choke tube.

~ 14 ~

GUN LOCK

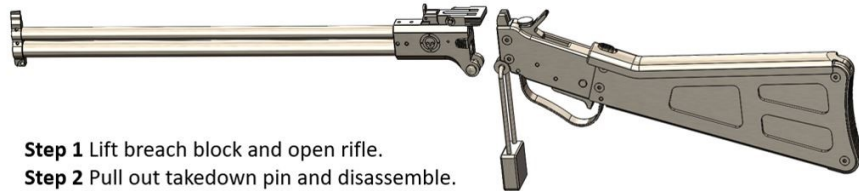

- Step 1** Lift breach block and open rifle.
- Step 2** Pull out takedown pin and disassemble.
- Step 3** Install cable through breach pivot hole.
- Step 4** Latch lock.
- Step 5** Store key separate from rifle.

~ 15 ~

M6 Takedown Parts List

1. Breach block	TPS1004	19. Trigger guard (Bar trigger)	TPS1017
2. Firing pin spring	TPS1045	20. Trigger/hammer/guard pin (4)	TPS1025
3. Firing pin	TPS1003	21. Safety pin	TPS1011
4. Selector knob	TPS1010	22. Striker block	TPS1008
5. Breach cover	TPS1005	23. Hammer detent	TPS1051
6. Side panel screw (14 pcs)	TPS1049	24. Hammer detent spring	TPS1040
7. Top cover button	TPS1022	25. Hammer	TPS1007
8. Top cover latch spring	TPS1041	26. Hammer strut	TPS1047
9. Top cover latch	TPS1023	27. Hammer spring	TPS1039
10. Top cover screw	TPS1050	28. Strut pivot	TPS1024
11. Top cover	TPS1021	29. Trigger spring	TPS1038
12. Top cover pivot pin	TPS1030	30. Trigger (bar)	TPS1006
13. Shell holder .22LR/22WMR	TPS1064	31. Safety set screw	TPS1067
14. Shell holder .410	TPS1065	32. Safety spring	AR1004
15. Stock Right side panel (std)	TPS1020	33. Safety detent	AR1023
16. Butt pad	TPS1018	34. Firing pin, retainer pins	TPS1026
17. Stock storage housing	TPS1066		
18. Stock Left side panel (std)	TPS1019		

~ 16 ~

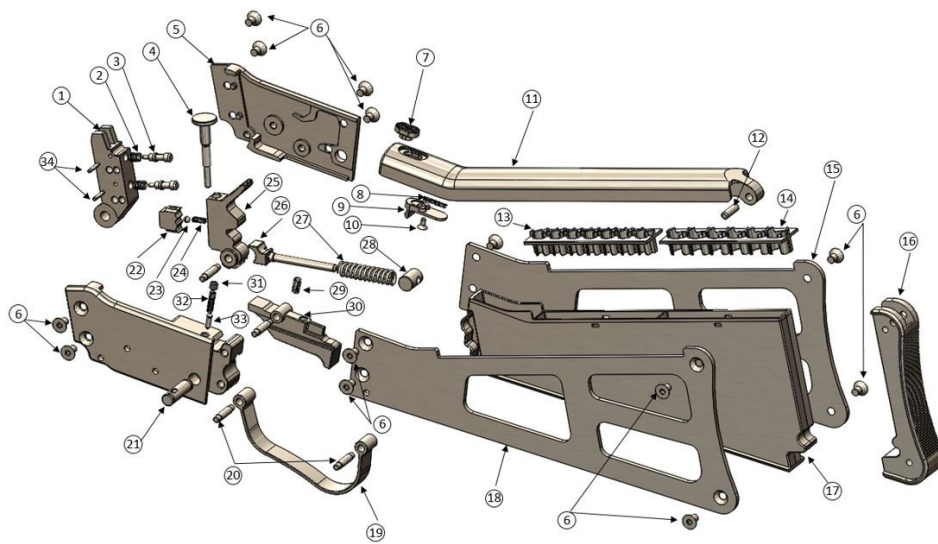

~ 17 ~

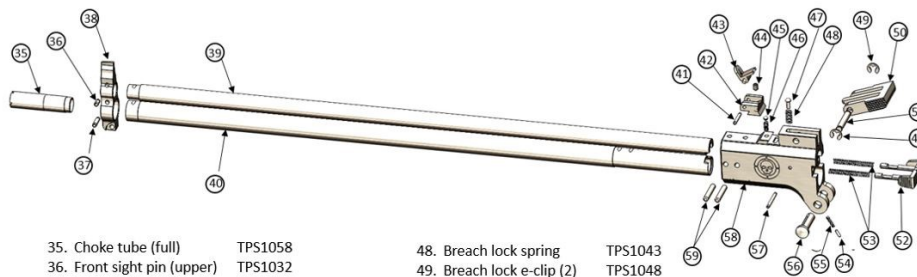

- | | | | |
|-------------------------------|------------|-----------------------------|------------|
| 35. Choke tube (full) | TPS1058 | 48. Breach lock spring | TPS1043 |
| 36. Front sight pin (upper) | TPS1032 | 49. Breach lock e-clip (2) | TPS1048 |
| 37. Front sight pin (lower) | TPS1033 | 50. Breach lock | TPS1015 |
| 38. Front sight | TPS1014 | 51. Breach lock pin | TPS1036 |
| 39. .22LR barrel | TPS1000 | 52. Extractor .22 LR | TPS1016 |
| .22WMR barrel | TPS1000-02 | 53. Extractor springs (2) | TPS1016-02 |
| 40. .410 barrel (smooth bore) | TPS1001 | 54. Takedown pin detent | AR1020 |
| 41. Rear sight pivot pin | TPS1035 | 55. Takedown pin spring | TPS1046 |
| 42. Rear sight block | TPS1012 | 56. Takedown pin | TPS1027 |
| 43. Flip sight | TPS1013 | 57. Extractor retainer pin | TPS1031 |
| 44. Rear sight screw | TPS1053 | 58. Receiver | TPS1002 |
| 45. Rear sight detent | TPS1052 | 59. Barrel/receiver pin (2) | TPS1029 |
| 46. Rear sight spring | TPS1044 | | |
| 47. Breach lock buffer | TPS1037 | | |

~ 18 ~

Ammunition and M6 Takedown Rifle Warranty

- We recommend using high-quality commercially manufactured ammunition for this M6. Only use the specific calibers that this M6 is built to accommodate. You are responsible for selecting the proper ammunition. Do not use dirty, corroded or damaged ammunition.
- **DO NOT USE .45 LONG COLT CALIBER AMMUNITION IN THIS RIFLE.** The bore diameter of the .410 barrel is only suited for .410 ammunition. Use of .45 Long Colt ammunition could result in damage to the firearm and/or bodily injury or death.
- **DO NOT REMOVE THE TRIGGER GUARD.**
- **WARRANTY:** This M6 Takedown Rifle has a one year limited warranty to the original owner. The warranty applies from the date of purchase and covers manufacturing defects. If you require warranty service please contact TPS Arms LLC at 320-358-0230 or email to customerservice@tpsarms.com. Retain a copy of your original purchase receipt in order to request warranty service.
 - TPS Arms LLC will cover the cost of replacement parts and labor to repair product defects.
 - TPS Arms LLC will not cover the cost of shipping, parts or labor for any products deemed to be defective due to failure to perform normal maintenance, modifications or adjustments made to the rifle, use of improper or defective ammunition, criminal activity, negligence, or use of the firearm while under the influence of drugs or alcohol.
 - TPS Arms LLC reserve the right to determine what constitutes a valid warranty claim.

Contact TPS Arms, LLC if you have any questions or concerns regarding ammunition or warranty service.

~ 19 ~



TPS Arms, LLC

PO BOX 522
RUSH CITY, MN 55069
320-358-0230

Internet: tpsarms.com

Email: customerservice@tpsarms.com