

LaserMax

CENTERFIRE®

WEAPON LIGHT



Operator's Manual

Glock® 42 | 43

CF-G42-LC

PARTS IDENTIFICATION

Right Housing

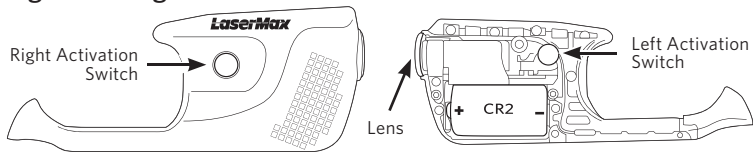

Left Housing

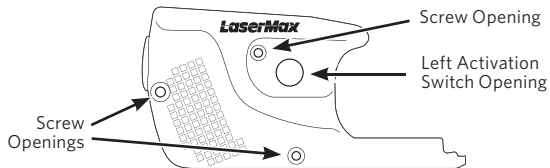

CR2 battery



mounting screws

REPLACEMENT PARTS

LMS-CR2

CR2 battery

CF-MS

mounting screws



See this sight installed at www.youtube.com/LaserMaxInc.

! IMPORTANT: Prior to installation, battery change, cleaning or maintenance, follow the firearm operator's manual to ensure that the firearm is unloaded.

INSTALLATION

! This state-of-the-art lighting system is designed for use with a specific pistol platform. Do not attempt installation on any other firearm model/s.

1. Place *right housing* onto trigger guard of pistol as shown, ensuring that rear portion of *right housing* is securely positioned and trigger guard is aligned with channel in *right housing* (figure 1).
2. Press *right housing* firmly in place by applying upward pressure to rear portion until housing snaps into place around trigger guard (figure 2).
3. Insert rear portion of *left housing* into the *right housing* at a 45 degree angle (figure 3).
4. Mate *left housing* with *right housing*, ensuring that *activation switch* passes through opening in *left housing*. Press together to remove gap (figure 4).

! Important: CenterFire® *mounting screws* are self-tapping; extra care should be taken when installing them for the first time to ensure that they are screwed in straight. Improper installation could cause the threads to strip.

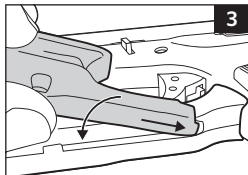
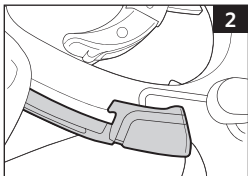

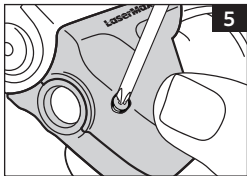
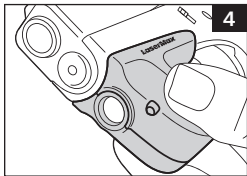



5. Install three (3) *mounting screws* into *left housing* with a Phillips screwdriver (not provided), starting with screw closest to barrel (figure 5). Next, tighten each *mounting screw* until secure. Do not over-tighten; this may damage the weaponlight housing.

OPERATION

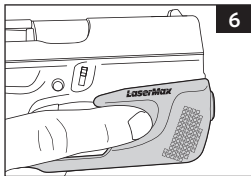
1. To turn the light on, press in on the *activation switch* from either side (figure 6). Press again to turn the light off.
2. To switch light from steady to strobe, press and release the *activation switch* from either side to activate the light. Then, press and hold the *activation switch* for 3 seconds. The light mode will change. Repeat the process to return to the previous mode.
3. To save power and prevent inadvertent battery drain, the weaponlight will shut off automatically after a ten minute period of inactivity. Cycle the *activation switch* to turn light back on.



BATTERY REPLACEMENT

 **TIP:** During periods of non-use, test the weaponlight periodically to ensure adequate battery levels.

1. Remove *mounting screws* to separate *left housing* from weaponlight assembly.
2. Lift expended CR2 battery out of *right housing*.
3. Install a fresh CR2 battery with the positive (+) facing muzzle as shown. (figure 7).
4. Reinstall *left housing* as previously described in INSTALLATION section, Step 4.

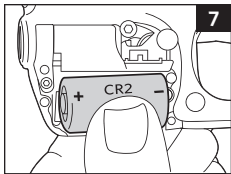

CLEANING & MAINTENANCE

After repeated fire, the weaponlight *lens* may become clouded with gunpowder residue. For best results, it is recommended that this area be cleaned, along with the firearm, after each use. To clean, follow these steps.

1. Keep firearm pointed in a safe direction.
2. Confirm light is off.
3. Dampen the end of a cotton swab with isopropyl alcohol.
4. Apply dampened swab to weaponlight *lens* and polish in a small circular pattern. Be sure to clean around edges of *lens*.

WARNING

Using an excessive amount of oil or lubricant to clean the firearm is not recommended. Getting oil or lubricant on the light components may cause damage and void the factory warranty. Weaponlight housing assemblies should not be submerged or flushed with cleaning solvents. Refer to the Glock® user's manual for complete cleaning and lubrication instructions.



IF YOU EXPERIENCE AN ISSUE
WITH YOUR WEAPONLIGHT
PLEASE DO NOT RETURN IT
TO THE STORE.

Contact LaserMax Customer Service: ☎ 800-527-3703

CF-G42-L
CF-G42-LC
CF-G42-LH

115+ Lumen LED
Vision Advisory Claim
RG-2: CAUTION. Do not
stare at exposed lamp in
operation. May be harmful
to the eyes.

WARNING

Do not point weaponlight at anything you do not wish to destroy.

LASERMAX LIMITED WARRANTY



LaserMax is pleased to offer a five (5) year limited warranty for this product. To take advantage of this coverage, the product must be registered no later than 90 days after purchase.

This product may be registered by completing a Registration Form which may be found at www.lasermax.com/ support or by contacting the LaserMax Customer Service Department at 1-800-527-3703. The LaserMax Limited Warranty extends specific legal rights to the registrant. Other rights, which vary from state to state, may also apply. This product is warranted to be free from defects in material and workmanship at the time of purchase. This limited warranty does not cover expendable parts (ex: batteries), that have definite and predictable life expectancies. This warranty does not cover products that LaserMax determines have been exposed to abnormal use in any way. Examples of abnormal use include, but are not limited to, damage from mishandling, misuse or abuse, damage from exposure to abnormal conditions, damage from improper care and maintenance, or installation of the product in or on any firearm model the product is not specifically advertised to be used with. Warranty coverage begins on the date of purchase and ends five (5) years after date of purchase. This limited warranty extends only to the original registrant and is non-transferable. To file a warranty claim, a warranty repair request must be submitted, and a Return Merchandise Authorization (RMA) number issued by the LaserMax Warranty Department, within five (5) years from date of purchase. Following submission of a warranty claim, LaserMax reserves the right to inspect the product to determine its eligibility for warranty coverage. If deemed eligible, LaserMax will repair or replace the part(s)/product that LaserMax, at its sole discretion, determines to be defective during the warranty period. If deemed ineligible, LaserMax will return the part(s)/product with an explanation of why coverage is not available. LaserMax reserves the right to replace defective part(s)/product with an equivalent substitute product at its sole discretion. Any and all implied warranties, including the implied warranties of merchantability, fitness for a particular purpose, and non-infringement, also begin on the date of purchase and end five (5) years after date of purchase. This limitation does not apply to residents of states that disallow limitations on the length of implied warranties. The preceding process is both the exclusive remedy and LaserMax's exclusive liability for any warranty claim. LaserMax will not, under any circumstances, be liable for any incidental, indirect, consequential, punitive or exemplary damages (even if LaserMax has been notified of the possibility of such damages) resulting from or related to a product, including, without limitation, any loss of profit, opportunity, or damages in excess of the purchase price of the warranted product. This limitation does not apply to residents of states that disallow limitations on incidental or consequential damages.

LaserMax, Inc,
3495 Winton Place, Rochester, NY 14623
☎ 800-527-3703 ▪ www.lasermax.com

For patent information, please visit:
www.lasermax.com/patents

01785-0-58, 12/15, Rev B